

**MSZ-GS24NA & MUZ-GS24NAHZ**  
**24,000 BTU/H WALL-MOUNTED INDOOR UNIT**  
**24,000 BTU/H HYPER HEAT PUMP OUTDOOR UNIT**



Job Name:

System Reference:

Date:



Indoor Unit.....MSZ-GS24NA

Outdoor Unit.....MUZ-GS24NAHZ

**INDOOR UNIT FEATURES**

- Slim wall-mounted indoor units provide zone comfort control
- Dual Barrier Coating applied to the heat exchanger, vanes and fan to prevent hydrophilic and hydrophobic dirt build-up
- Optional Microparticle Filter designed to capture PM2.5
- The outdoor unit powers the indoor unit, and should a power outage occur, the system is automatically restarted when power returns
- Quiet operation
- Smart Set: recalls a preferred preset temperature setting at the touch of a button
- Built-in backup/auxiliary heater control available
- Multiple fan speed options: Quiet, Low, Medium, High, Super-high, Auto
- Multiple control options available:
  - Back-lit screen handheld remote controller (provided with the unit)
  - kumo cloud® smart device app for remote access
  - Third-party interface options
  - Wired or wireless controllers

**OUTDOOR UNIT FEATURES**

- INVERTER-driven compressor and LEV provide high efficiency and comfort while using only the energy needed to maintain maximum performance
- Hyper-heating performance offers 100% heating capacity at 5°F
- Hot-Start Technology: no cold air rush at equipment startup or when restarting after Defrost Cycle
- Quiet outdoor unit operation
- Built-in base pan heater
- Innovative DC fan motor leads to high efficiency and reliability
- Blue Fin anti-corrosion treatment applied to the outdoor unit heat exchanger for increased coil protection and longer life
  - Rated for 2,000 hours spraying time per ASTM B117 Standard

# SPECIFICATIONS: MSZ-GS24NA & MUZ-GS24NAHZ

|   |   |                     |  |
|---|---|---------------------|--|
| Cooling at 95°F <sup>1</sup>            | Maximum Capacity                              | BTU/H               | 31,400   |
|   | Rated Capacity                                | BTU/H               | 22,400   |
|   | Minimum Capacity                              | BTU/H               | 8,200  |
|   | Maximum Power Input                           | W                   | 4,000  |
|   | Rated Power Input                             | W                   | 1,780  |
|   | Moisture Removal                              | Pints/h             | 5.1  |
|   | Sensible Heat Factor                          |                     | 0.75   |
|   | Power Factor [208V / 230V]                    | %                   | 99.0 / 99.0                                    |
| Heating at 47°F <sup>2</sup>            | Maximum Capacity                              | BTU/H               | 36,900   |
|   | Rated Capacity                                | BTU/H               | 21,200   |
|   | Minimum Capacity                              | BTU/H               | 7,500  |
|   | Maximum Power Input                           | W                   | 4,050  |
|   | Rated Power Input                             | W                   | 1,540  |
|   | Power Factor [208V / 230V]                    | %                   | 98.0 / 98.0                                    |
| Heating at 17°F <sup>3</sup>            | Maximum Capacity                              | BTU/H               | 25,400   |
|   | Rated Capacity                                | BTU/H               | 13,300   |
|   | Maximum Power Input                           | W                   | 3,350  |
|   | Rated Power Input                             | W                   | 1,400  |
| Heating at 5°F <sup>4</sup>             | Maximum Capacity                              | BTU/H               | 21,200   |
|   | Maximum Power Input                           | W                   | 3,190  |
| Heating at -5°F <sup>6</sup>            | Maximum Capacity                              | BTU/H               | 18,070   |
| Heating at -13°F <sup>7</sup>           | Maximum Capacity                              | BTU/H               | 14,930   |
| Efficiency                              | SEER2   |                     | 21.5   |
|   | EER2 <sup>1</sup>                             |                     | 12.6   |
|   | HSPF2 [I/V]                                   |                     | 9.0  |
|   | COP at 47°F <sup>2</sup>                      |                     | 4.03   |
|   | COP at 17°F at Maximum Capacity <sup>3</sup>  |                     | 2.22   |
|   | COP at 5°F at Maximum Capacity <sup>4</sup>   |                     | 1.95   |
|   | COP at -5°F at Maximum Capacity <sup>6</sup>  |                     | 1.78   |
|   | COP at -13°F at Maximum Capacity <sup>7</sup> |                     | 1.58   |
| Electrical                              | ENERGY STAR® Certified                        |                     | Yes  |
|   | Voltage, Phase, Frequency                     |                     | 208/230, 1, 60                                 |
|   | Guaranteed Voltage Range                      | V AC                | 187 - 253                                      |
|   | Voltage: Indoor - Outdoor, S1-S2              | V AC                | 208/230  |
|   | Voltage: Indoor - Outdoor, S2-S3              | V DC                | 24   |
|   | Short-circuit Current Rating [SCCR]           | kA                  | 5  |
|   | Recommended Fuse/Breaker Size (Outdoor)       | A                   | 20   |
|   | Recommended Wire Size [Indoor - Outdoor]      | AWG                 | 14   |
| Indoor Unit                             | Power Supply                                  |                     | Indoor unit is powered by the outdoor unit     |
|   | MCA   | A                   | 1.0  |
|   | Fan Motor Full Load Amperage                  | A                   | 0.73   |
|   | Fan Motor Output                              | W                   | 56   |
|   | Airflow Rate at Cooling, Dry                  | CFM                 | 361–456–565–701                                |
|   | Airflow Rate at Cooling, Wet                  | CFM                 | 325–410–509–631                                |
|   | Airflow Rate at Heating, Dry                  | CFM                 | 336–456–565–701                                |
|   | Sound Pressure Level [Cooling]                | dB[A]               | 34–41–47–53                                    |
|   | Sound Pressure Level [Heating]                | dB[A]               | 32–41–47–52                                    |
|   | Drain Pipe Size                               | In. [mm]            | 5/8 [15.88]                                    |
|   | Coating on Heat Exchanger                     |                     | Dual Barrier Coating                           |
|   | External Finish Color                         |                     | Munsell 1.0Y 9.2/0.2                           |
|   | Unit Dimensions                               | W x D x H: In. [mm] | 43-5/16 x 9-3/8 x 12-13/16 [1,100 x 238 x 325] |
|   | Package Dimensions                            | W x D x H: In. [mm] | 45-1/2 x 12-3/4 x 15-1/2 [1,160 x 320 x 390]   |
|   | Unit Weight                                   | Lbs. [kg]           | 37 [16.4]                                      |
|   | Package Weight                                | Lbs. [kg]           | 41 [18.4]                                      |
| Indoor Unit Operating Temperature Range | Cooling Intake Air Temp [Maximum / Minimum]*  | °F                  | 90 DB, 73 WB / 67 DB, 57 WB                    |
|   | Heating Intake Air Temp [Maximum / Minimum]   | °F                  | 80 DB / 70 DB                                  |

## NOTES:

AHRI Rated Conditions

(Rated data is determined at a fixed compressor speed)

<sup>1</sup>Cooling (Indoor // Outdoor)

<sup>2</sup>Heating at 47°F (Indoor // Outdoor)

<sup>3</sup>Heating at 17°F (Indoor // Outdoor)

°F 80 DB, 67 WB // 95 DB, 75 WB

°F 70 DB, 60 WB // 47 DB, 43 WB

°F 70 DB, 60 WB // 17 DB, 15 WB

Conditions

<sup>4</sup>Heating at 5°F (Indoor // Outdoor)

°F 70 DB, 60 WB // 5 DB, 4 WB

\*Indoor/Outdoor Unit Operating Temperature Range (Cooling Air Temp [Maximum / Minimum]):

• Applications should be restricted to comfort cooling only; equipment cooling applications are not recommended for low ambient temperature conditions.

\*\*Outdoor Unit Operating Temperature Range (Cooling Thermal Lock-out / Re-start Temperatures; Heating Thermal Lock-out / Re-start Temperatures):

• System cuts out in heating mode to avoid thermistor error and automatically restarts at these temperatures.

# SPECIFICATIONS: MSZ-GS24NA & MUZ-GS24NAHZ

|  |  |                     |   |
|--|--|---------------------|---|
| Outdoor Unit                             | MCA  | A                   | 18.0                                    |
|  | MOCP   | A                   | 20                                      |
|  | Fan Motor Full Load Amperage                               | A                   | 0.93                                    |
|  | Airflow Rate [Cooling / Heating]                           | CFM                 | 1950 / 1950                             |
|  | Refrigerant Control  |                     | LEV                                     |
|  | Defrost Method   |                     | Reverse Cycle                           |
|  | Coating on Heat Exchanger                                  |                     | Blue Fin Coating                        |
|  | Sound Pressure Level, Cooling <sup>1</sup>                 | dB(A)               | 55                                      |
|  | Sound Pressure Level, Heating <sup>2</sup>                 | dB(A)               | 55                                      |
|  | Compressor Type  |                     | DC inverter driven Twin Rotary          |
|  | Compressor Model   |                     | SNB172FQKMT                             |
|  | Compressor Rated Load Amps                                 | A                   | 13.6                                    |
|  | Compressor Locked Rotor Amps                               | A                   | 17.0                                    |
|  | Compressor Oil [Type // Charge]                            | oz.                 | FV50S // 13.5                           |
|  | External Finish Color                                      |                     | Munsell 3Y 7.8/1.1                      |
|  | Base Pan Heater  |                     | Built-in                                |
|  | Unit Dimensions  | W x D x H: In. [mm] | 33-1/16 x 13 x 34-5/8 [840 x 330 x 880] |
|  | Package Dimensions   | W x D x H: In. [mm] | 38-3/4 x 16-3/4 x 39 [980 x 420 x 990]  |
|  | Unit Weight  | Lbs. [kg]           | 120 [54]                                |
|  | Package Weight   | Lbs. [kg]           | 138 [62]                                |
| Outdoor Unit Operating Temperature Range | Cooling Air Temp [Maximum / Minimum]*                      | °F                  | 115 DB / 14 DB                          |
|  | Cooling Thermal Lock-out / Re-start Temperatures**         | °F                  | -4 / 0                                  |
|  | Heating Air Temp [Maximum / Minimum]                       | °F                  | 75 DB, 65 WB / -13 DB, -14 WB           |
|  | Heating Thermal Lock-out / Re-start Temperatures**         | °F                  | -22 / -14                               |
| Refrigerant                              | Type   |                     | R410A                                   |
|  | Pre-Charged Refrigerant Amount                             | Lbs, oz             | 4.0, 5.0                                |
|  | Maximum Pre-Charged Piping Length                          | Ft. [m]             | 25.0 [7.5]                              |
|  | Additional Refrigerant Charge Per Additional Piping Length | oz./Ft. [g/m]       | 1.08 [20]                               |
| Piping                                   | Gas Pipe Size O.D. [Flared]                                | In. [mm]            | 5/8 [15.88]                             |
|  | Liquid Pipe Size O.D. [Flared]                             | In. [mm]            | 1/4 [6.35]                              |
|  | Maximum Piping Length                                      | Ft. [m]             | 100 [30]                                |
|  | Maximum Height Difference                                  | Ft. [m]             | 50 [15]                                 |
|  | Maximum Number of Bends                                    |                     | 10                                      |

## NOTES:

AHRI Rated Conditions

(Rated data is determined at a fixed compressor speed)

<sup>1</sup>Cooling (Indoor // Outdoor) °F 80 DB, 67 WB // 95 DB, 75 WB  
<sup>2</sup>Heating at 47°F (Indoor // Outdoor) °F 70 DB, 60 WB // 47 DB, 43 WB  
<sup>3</sup>Heating at 17°F (Indoor // Outdoor) °F 70 DB, 60 WB // 17 DB, 15 WB

Conditions

<sup>4</sup>Heating at 5°F (Indoor // Outdoor) °F 70 DB, 60 WB // 5 DB, 4 WB

\*Indoor/Outdoor Unit Operating Temperature Range (Cooling Air Temp [Maximum / Minimum]):

- Applications should be restricted to comfort cooling only; equipment cooling applications are not recommended for low ambient temperature conditions.

\*\*Outdoor Unit Operating Temperature Range (Cooling Thermal Lock-out / Re-start Temperatures; Heating Thermal Lock-out / Re-start Temperatures):

- System cuts out in heating mode to avoid thermistor error and automatically restarts at these temperatures.

## INDOOR UNIT ACCESSORIES: MSZ-GS24NA

|                            |   |                   |
|----------------------------|---|-------------------|
| Control Interface          | CN24 Relay Kit  | CN24RELAY-KIT-CM3 |
|                            | IT Extender   | PAC-WHS01IE-E     |
|                            | kumo station® for kumo cloud®   | PAC-WHS01HC-E     |
|                            | Procon BACnet® and Modbus® Interface  | PAC-UKPRC001-CN-1 |
|                            | System Control Interface  | MAC-334IF-E       |
|                            | Thermostat Interface  | PAC-US445CN-1     |
|                            | USNAP Adapter   | PAC-WHS01UP-E     |
|                            | Wireless Interface for kumo cloud®  | PAC-USWHS002-WF-2 |
| Remote Sensor              | Wired Remote Sensor   | M21EAA307         |
|                            | Wireless temperature and humidity sensor for kumo cloud®                                    | PAC-USWHS003-TH-1 |
| Wired Remote Controller    | Deluxe Wired MA Remote Controller†  | PAR-40MAAU        |
|                            | Simple Ductless Wired Remote Controller   | PAC-SDW01RC-1     |
|                            | Simple MA Remote Controller†  | PAC-YT53CRAU-J    |
|                            | Touch MA Controller†  | PAR-CT01MAU-SB    |
| Wireless Remote Controller | kumo touch™ RedLINK™ Wireless Controller  | MHK2              |
|                            | Lockdown bracket for remote controller  | RCMKP1CB          |
| Condensate                 | Blue Diamond (Advanced) Mini Condensate Pump w/ Reservoir & Sensor (208/230V) [recommended] | X87-721           |
|                            | Blue Diamond (MegaBlue Advanced) Condensate Pump w/ Reservoir & Sensor                      | X87-835           |
|                            | Blue Diamond Alarm Extension Cable — 6.5 Ft.  | C13-192           |
|                            | Blue Diamond MultiTank — collection tank for use with multiple pumps                        | C21-014           |
|                            | Blue Diamond Sensor Extension Cable — 15 Ft.  | C13-103           |
|                            | Drain Pan Level Sensor/Control  | SS610E            |
|                            | Fascia Kit for MicroBlue Pump, mounts the MicroBlue and sensor directly beneath indoor unit | T18-016           |
|                            | Refco Condensate Pump (100-240 VAC)   | GOBI-II           |
|                            | Refco Condensate Pump (100-240 VAC) up to 120,000 BTU/H                                     | COMBI             |
|                            | Sauermann Condensate Pump   | SI30-230          |
| Disconnect Switch          | (30A/600V/UL) [fits 2" X 4" utility box] - Black  | TAZ-MS303         |
|                            | (30A/600V/UL) [fits 2" X 4" utility box] - White  | TAZ-MS303W        |
| Filter                     | Electro Static Anti-allergy Enzyme Filter   | MAC-2310FT-E      |
|                            | Microparticle (PM2.5) Filter  | MAC-EMF615FT-E    |

**NOTES:**

†PAC-SF40RM-E (Unable to use with wireless remote controller)

## OUTDOOR UNIT ACCESSORIES: MUZ-GS24NAHZ

|                  |  |                 |
|------------------|--|-----------------|
| Air Outlet Guide | Air Outlet Guide   | MAC-886SG-E     |
| Hail Guards      | Hail Guard   | HG-A7           |
| Lineset          | 10' x 3/8" x 10' x 5/8" Lineset (Twin-Tube Insulation)   | MPLS385812T-10  |
|                  | 100' x 3/8" x 100' x 5/8" Lineset (Twin-Tube Insulation) | MPLS385812T-100 |
|                  | 15' x 3/8" x 15' x 5/8" Lineset (Twin-Tube Insulation)   | MPLS385812T-15  |
|                  | 30' x 3/8" x 30' x 5/8" Lineset (Twin-Tube Insulation)   | MPLS385812T-30  |
|                  | 50' x 3/8" x 50' x 5/8" Lineset (Twin-Tube Insulation)   | MPLS385812T-50  |
|                  | 65' x 3/8" x 65' x 5/8" Lineset (Twin-Tube Insulation)   | MPLS385812T-65  |
| Mounting Pad     | Condensing Unit Mounting Pad: 16" x 36" x 3"             | ULTRILITE1      |
|                  | Outdoor Unit 3-1/4 inch Mounting Base (Pair) - Plastic   | DSD-400P        |
| Stand            | 18" Single Fan Stand                                     | QSMS1801M       |
|                  | 24" Single Fan Stand                                     | QSMS2401M       |
|                  | Condenser Wall Bracket                                   | QSWB2000M-1     |
|                  | Condenser Wall Bracket - Stainless Steel Finish          | QSWBSS          |
|                  | Outdoor Unit Stand — 12" High                            | QSMS1201M       |

# INDOOR UNIT DIMENSIONS: MSZ-GS24NA

Unit: inch

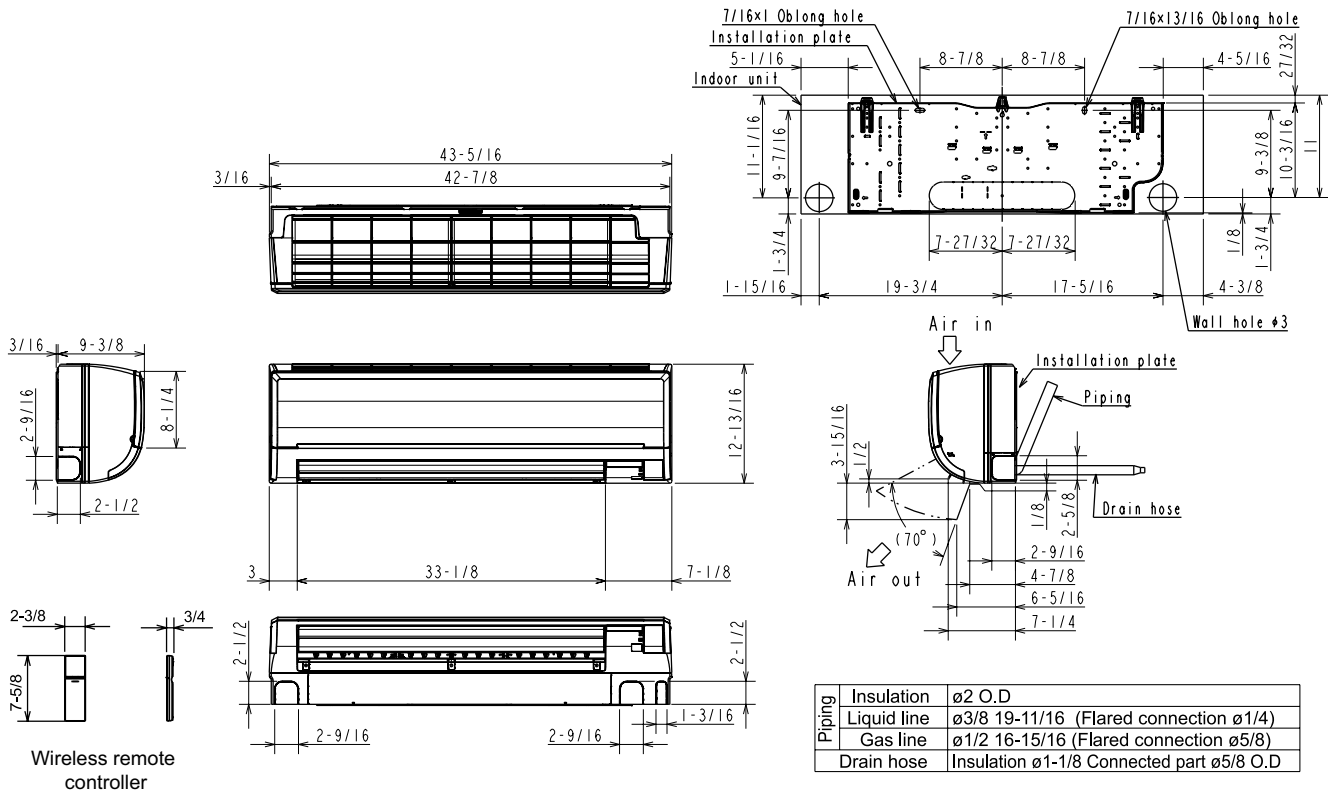

OUTDOOR UNIT DIMENSIONS: MUZ-GS24NAHZ

Unit: inch

REQUIRED SPACE

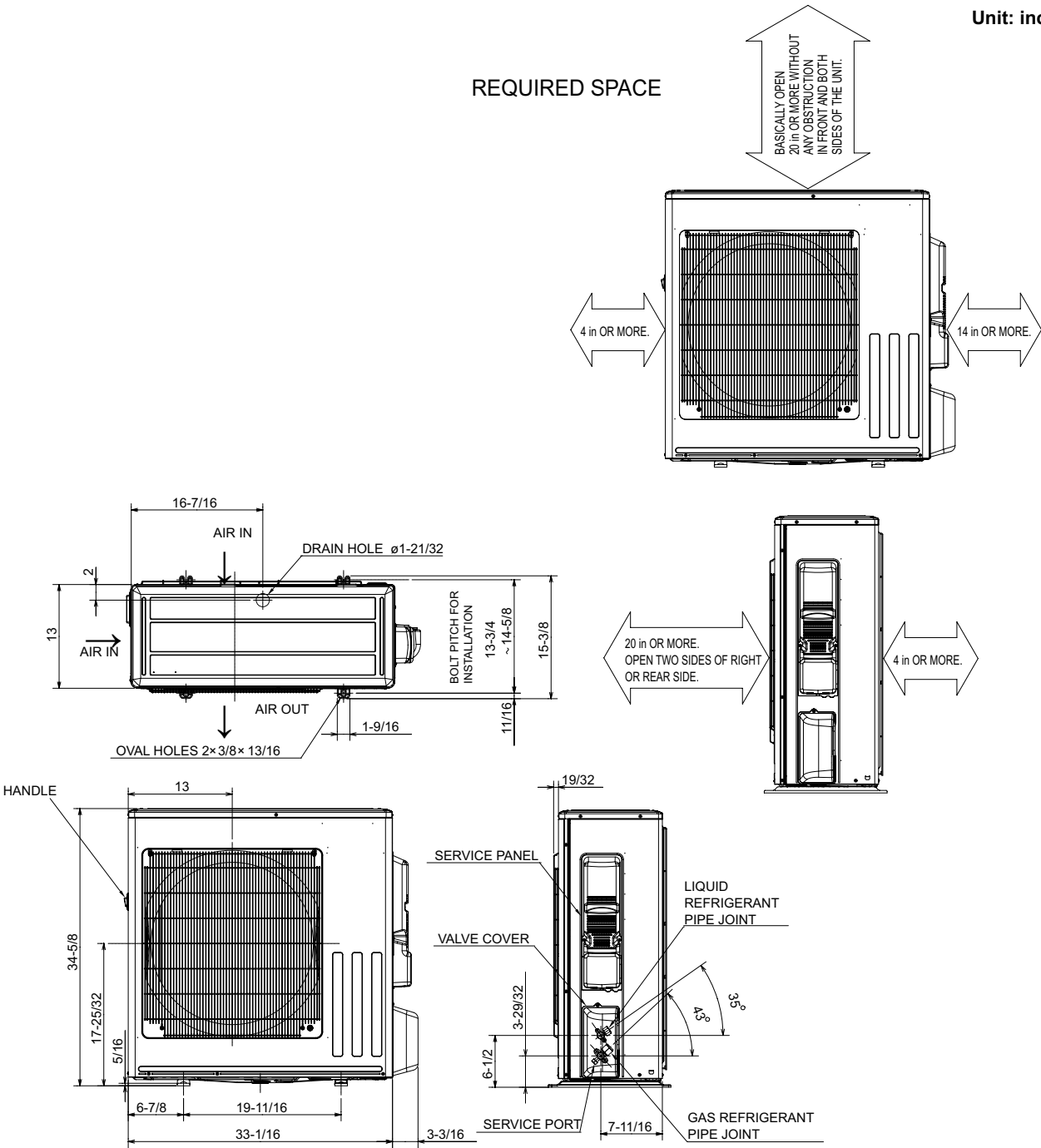

|                           |                         |  |
|---------------------------|-------------------------|--|
| REFRIGERANT<br>PIPE JOINT | LIQUID REFRIGERANT PIPE | FLARED $\phi 6.35$ (1/4")              |
|                           | GAS REFRIGERANT PIPE    | GS18: FLARED $\phi 12.7$ (1/2")        |
|                           |                         | GS24/30/36: FLARED $\phi 15.88$ (5/8") |

1340 Satellite Boulevard Suwanee, GA 30024  
Toll Free: 800-433-4822 www.mehvac.com



FORM# MSZ-GS24NA & MUZ-GS24NAHZ - 202306

Specifications are subject to change without notice.

© 2023 Mitsubishi Electric Trane HVAC US LLC. All rights reserved.