



*Thru-the-Wall Comfort for all types of Multi-Family Construction*

## Thru the Wall Split System Submittal Data

For Approval

**Project:**

**Purchaser:**

**Date:**

*Go Thru-the-Wall*



**National Comfort Products**  
A Division of National Refrigeration and Air Conditioning Products, Inc.  
539 Dunksferry Road • Bensalem, PA 19020-5908  
(800) 523-7138 • Fax (215) 639-1674  
[www.nationalcomfortproducts.com](http://www.nationalcomfortproducts.com)

## NCP Condensing Unit Models

Plan Designation	Quantity	Model	Description	Page
		NCP4181000A-**	1000 Series R410A 1.5 ton, Thru-the-Wall 208-230/1/60 12.5 SEER2*	5
		NCP4241000A-**	1000 Series R410A 2.0 ton, Thru-the-Wall 208-230/1/60 12.5 SEER2*	5
		NCP4301000A-**	1000 Series R410A 2.5 ton, Thru-the-Wall 208-230/1/60 12 SEER2	5
		NCP4183000A-**	3000 Series R410A 1.5 ton, Thru-the-Wall 208-230/1/60 13.0 SEER2*	6
		NCP4243000A-**	3000 Series R410A 2.0 ton, Thru-the-Wall 208-230/1/60 13 SEER2*	6
		NCP4303000A-**	3000 Series R410A 2.5 ton, Thru-the-Wall 208-230/1/60 12 SEER2*	6
		NCP4184000A-**	4000 Series R410A 1.5 ton, Thru-the-Wall 208-230/1/60 12.50 SEER2*	7
		NCP4244000A-**	4000 Series R410A 2.0 ton, Thru-the-Wall 208-230/1/60 12.50 SEER2*	7
		NCP4185000A-**	5000 Series R410A 1.5 ton, Thru-the-Wall 208-230/1/60 14 SEER2*	8
		NCP4245000A-**	5000 Series R410A 2.0 ton, Thru-the-Wall 208-230/1/60 14 SEER2*	8
		NCP4305000A-**	5000 Series R410A 2.5 ton, Thru-the-Wall 208-230/1/60 13.5 SEER2*	8

\*When matched with NAH4\*\*MF Air Handlers

## NHP Heat Pump Models

Plan Designation	Quantity	Model	Description	Page
		NHP4183000A-**	3000 Series R410A 1.5 ton, Thru-the-Wall Heat Pump 208-230/1/60 12 SEER2*	9
		NHP4243000A-**	3000 Series R410A 2.0 ton, Thru-the-Wall Heat Pump 208-230/1/60 12 SEER2*	9
		NHP4185000A-**	5000 Series R410A 1.5 ton, Thru-the-Wall Heat Pump 208-230/1/60 13.5 SEER2*	10
		NHP4245000A-**	5000 Series R410A 2.0 ton, Thru-the-Wall Heat Pump 208-230/1/60 13.5 SEER2*	10
		NHP4305000A-**	5000 Series R410A 2.5 ton, Thru-the-Wall Heat Pump 208-230/1/60 12.5 SEER2*	10

\*When matched with NAH4\*\*MF Air Handlers

### Air Handler Models

Plan Designation	Quantity	Model	Description	Page
		NAH424MF*-L*	2 Ton Multi-Family Style Air Handler w/ Left Return 208/230/1/60	11
		NAH424MF*-R*	2 Ton Multi-Family Style Air Handler w/ Right Return 208/230/1/60	11
		NAH430MF*-L*	2.5 Ton Multi-Family Style Air Handler w/ Left Return 208/230/1/60	11
		NAH430MF*-R*	2.5 Ton Multi-Family Style Air Handler w/ Right Return 208/230/1/60	11

### Electric Heat Kit Options

Plan Designation	Quantity	Model	Description	Page
		CPEHK-03-A	3 kW Field Installed Electric Heat Kit	12
		CPEHK-05-A	5 kW Field Installed Electric Heat Kit	12
		CPEHK-07-A	7 kW Field Installed Electric Heat Kit	12
		CPEHK-10-A	10 kW Field Installed Electric Heat Kit	12
		CPEHK-15-A	15 kW Field Installed Electric Heat Kit	12

### NCC Cased Coil Models

Plan Designation	Quantity	Model	Description	Page
		NCC418AA-1	1.5 Ton Cased Coil w/ TXV	13
		NCC424AA-1	2 Ton Cased Coil w/ TXV	13
		NCC430AA-1	2.5 Ton Cased Coil w/ TXV	13

Options

Plan Designation	Quantity	Part No.	Description	Page
		1000-WSD-12	Wall Sleeve, Dimensions 26 $\frac{7}{8}$ " W x 29 $\frac{5}{8}$ " H Rough in at 27 $\frac{3}{8}$ " W x 30 $\frac{1}{8}$ " H	14
		3000-WSD-12	Wall Sleeve, 24 $\frac{7}{8}$ " W x 33" H Rough in at 25 $\frac{3}{8}$ " W x 33 $\frac{1}{2}$ " H	14
		4000-WSD-12	Wall Sleeve, 30 $\frac{5}{8}$ " W x 24" H Rough in at 31 $\frac{1}{8}$ " W x 24 $\frac{1}{2}$ " H	14
		5000-WSD-12	Wall Sleeve, 28" W x 39 $\frac{7}{8}$ " H Rough in at 28 $\frac{1}{2}$ " W x 40 $\frac{3}{8}$ " H	14
		14269035	1000 Series Anodized Aluminum Architectural Louver Grille	15
		14269036	3000 Series Anodized Aluminum Architectural Louver Grille	15
		14269037	4000 Series Anodized Aluminum Architectural Louver Grille	16
		14269038	5000 Series Anodized Aluminum Architectural Louver Grille	16
		14269035-P	1000 Series Painted Architectural Louver Grille	15
		14269036-P	3000 Series Painted Architectural Louver Grille	15
		14269037-P	4000 Series Painted Architectural Louver Grille	16
		14269038-P	5000 Series Painted Architectural Louver Grille	16
		14269035-S	1000 Series Anodized Aluminum Architectural Louver Grille to fit sleeve	17
		14269036-S	3000 Series Anodized Aluminum Architectural Louver Grille to fit sleeve	17
		14269037-S	4000 Series Anodized Aluminum Architectural Louver Grille to fit sleeve	18
		14269038-S	5000 Series Anodized Aluminum Architectural Louver Grille to fit sleeve	18
		14269035-SP	1000 Series Painted Architectural Louver Grille to fit sleeve	17
		14269036-SP	3000 Series Painted Architectural Louver Grille to fit sleeve	17
		14269037-SP	4000 Series Painted Architectural Louver Grille to fit sleeve	18
		14269038-SP	5000 Series Painted Architectural Louver Grille to fit sleeve	18

## NCP 1000 SERIES-Condensing Unit

Performance Data				
Models	Rated Capacity (Btu/h)	Dimensions	Efficiency Ratings	Shipping Weight
<b>NCP4181000A-**</b>	18,000	26 1/4" W x 28 5/8" H x 18 1/2" D	12.5 SEER2*	160 lbs
<b>NCP4241000A-**</b>	22,600	26 1/4" W x 28 5/8" H x 18 1/2" D	12.5 SEER2*	165 lbs
<b>NCP4301000A-**</b>	26,400	26 1/4" W x 28 5/8" H x 18 1/2" D	12 SEER2*	170 lbs

\*When matched with NAH4\*\*MF Air Handlers

Electrical Data				
All Units 208/230-1~60Hz				
Cond. Fan Motor 1/4 HP, 1600 RPM, 1.3 FLA				
Models	Compressor		Minimum Circuit Amps	MOP
	RLA	LRA		
<b>NCP4181000A-**</b>	10.3	45.7	14.20	20
<b>NCP4241000A-**</b>	11.7	59.5	15.90	25
<b>NCP4301000A-**</b>	12.8	65	17.80	30

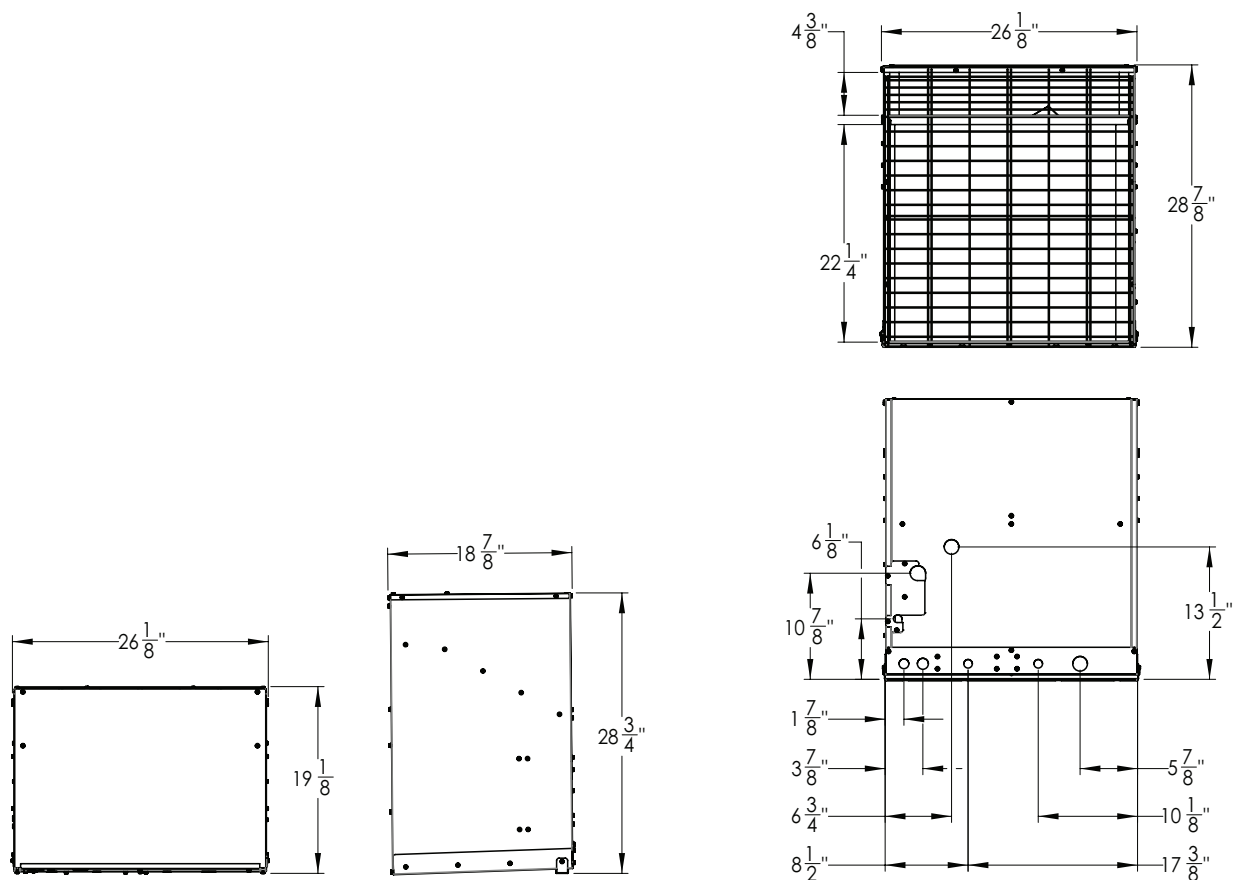

## NCP 3000 SERIES-Condensing Unit

Performance Data				
Models	Rated Capacity (Btu/h)	Dimensions	Efficiency Ratings	Shipping Weight
<b>NCP4183000A-**-</b>	18,000	24 1/8" W x 32" H x 18 1/2" D	13 SEER2*	160 lbs
<b>NCP4243000A-**-</b>	23,000	24 1/8" W x 32" H x 18 1/2" D	13 SEER2*	165 lbs
<b>NCP4303000A-**-</b>		24 1/8" W x 32" H x 18 1/2" D	12 SEER2*	170 lbs

\*When matched with NAH4\*\*MF Air Handlers

Electrical Data				
All Units 208/230-1~60Hz				
Cond. Fan Motor 1/4 HP, 1600 RPM, 1.3 FLA				
Models	Compressor		Minimum Circuit Amps	MOP
	RLA	LRA		
<b>NCP4183000A-**-</b>	10.3	45.7	14.20	20
<b>NCP4243000A-**-</b>	11.7	59.5	15.90	25
<b>NCP4303000A-**-</b>	12.8	65	17.80	30

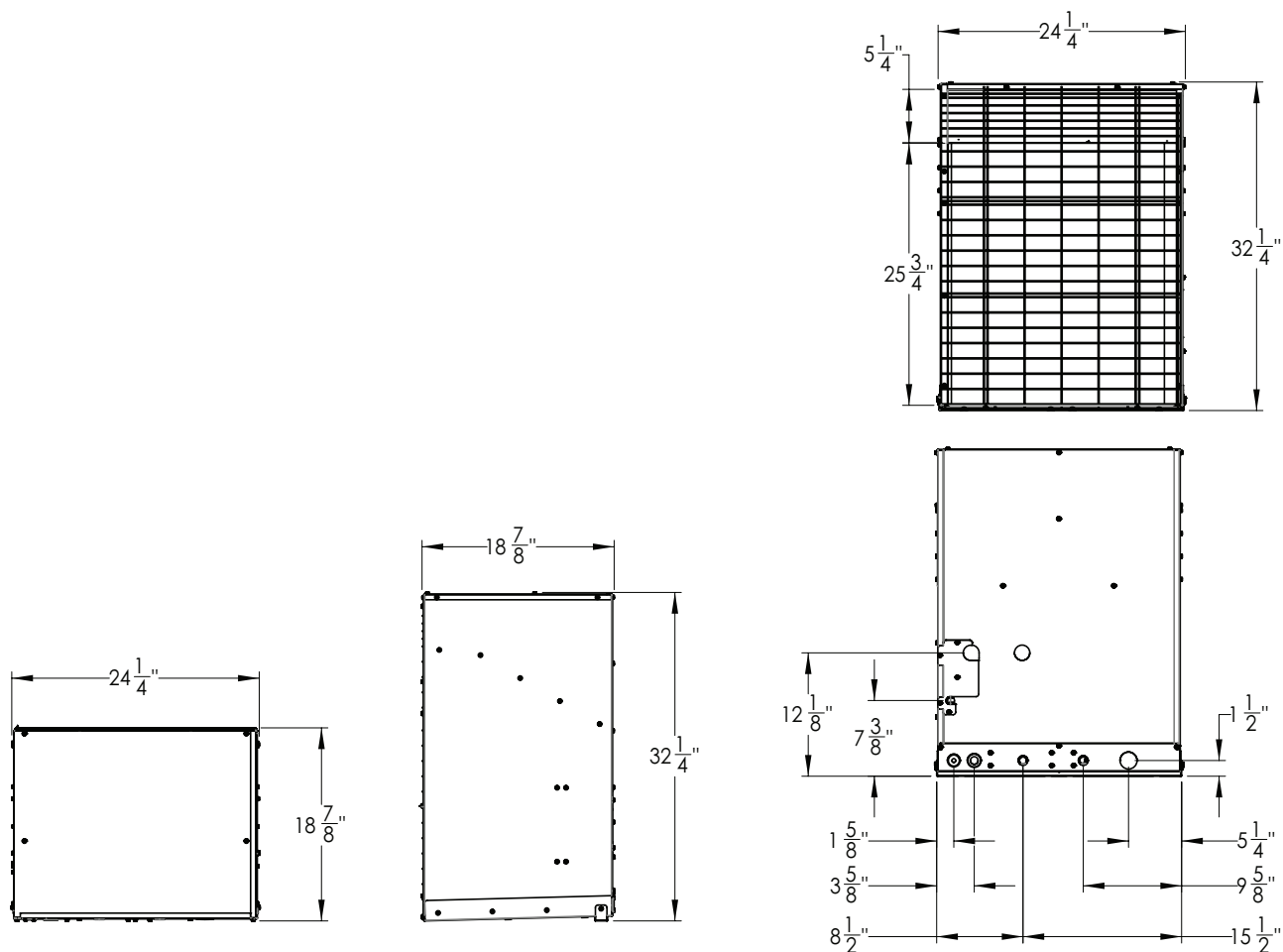

## NCP 4000 SERIES-Condensing Unit

Performance Data				
Models	Rated Capacity (Btu/h)	Dimensions	Efficiency Ratings	Shipping Weight
<b>NCP4184000A-**-</b>	18,000	30" W x 23" H x 22 1/2" D	12.5 SEER2*	160 lbs
<b>NCP4244000A-**-</b>	23,000	30" W x 23" H x 22 1/2" D	12.5 SEER2*	170 lbs

\*When matched with NAH4\*\*MF Air Handlers

Electrical Data				
All Units 208/230-1~60Hz				
Cond. Fan Motor 1/5 HP, 1650 RPM, 1.8 FLA				
Models	Compressor		Minimum Circuit Amps	MOP
	RLA	LRA		
<b>NCP4184000A-**-</b>	10.3	45.7	14.70	20
<b>NCP4244000A-**-</b>	11.7	59.5	16.40	25

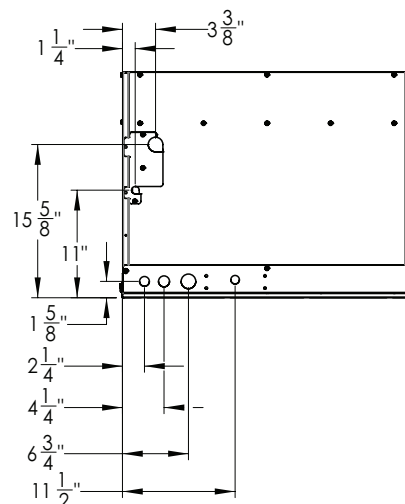
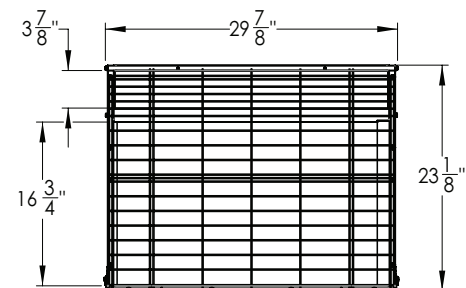
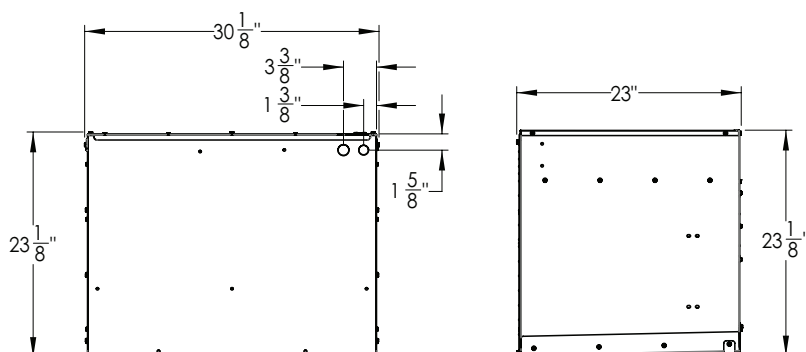

**Project:**
**NCP 5000 SERIES-Condensing Unit**
**Performance Data**

Models	Rated Capacity (Btu/h)	Dimensions	Efficiency Ratings	Shipping Weight
<b>NCP4185000A-**-</b>	18,000	26 $\frac{7}{8}$ " x 38 $\frac{7}{8}$ " x 18 $\frac{1}{2}$ "	14 SEER*	170 lbs
<b>NCP4245000A-**-</b>	24,000	26 $\frac{7}{8}$ " x 38 $\frac{7}{8}$ " x 18 $\frac{1}{2}$ "	14 SEER*	185 lbs
<b>NCP4305000A-**-</b>	28,400	26 $\frac{7}{8}$ " x 38 $\frac{7}{8}$ " x 18 $\frac{1}{2}$ "	13.5 SEER*	190 lbs

\*When matched with NAH4\*\*-MF Air Handlers

**Electrical Data**

All Units 208/230-1~-60Hz

Cond. Fan Motor 1/5 HP 1.8 FLA

Models	Compressor		Minimum Circuit Amps	Maximum Fuse
	RLA	LRA		
<b>NCP4185000A-**-</b>	10.3	45.7	14.68	20
<b>NCP4245000A-**-</b>	11.5	59.5	16.18	25
<b>NCP4305000A-**-</b>	14.1	67.9	19.43	30

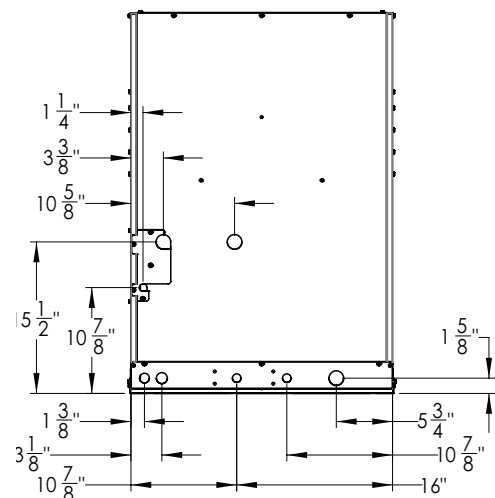
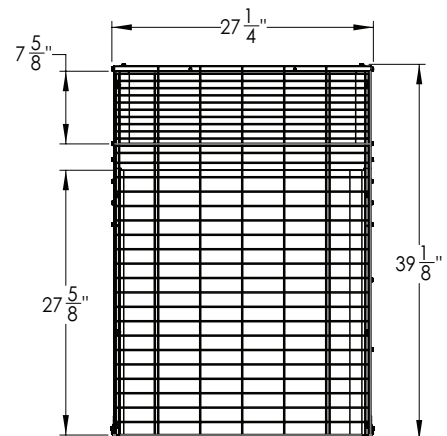
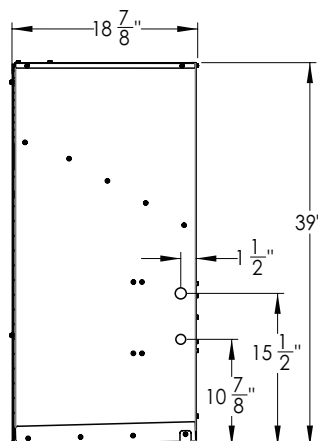
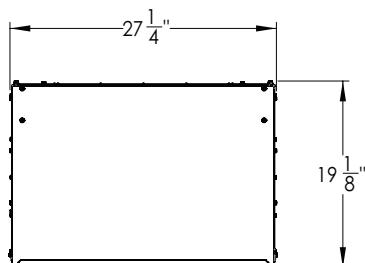



**NHP 3000 SERIES-Heat Pump**

Performance Data					
Models	Rated Cooling Capacity (Btu/h)	Rated Heating Capacity (Btu/h)	Dimensions	Efficiency Ratings	Shipping Weight
<b>NHP4183000A-**</b>	17,600	@ 47°F - 15,200	24 1/8" W x 32" H x 18 1/2" D	12 SEER2*	170 lbs
		@ 35°F - 12,100			
		@ 17°F - 9,200			
<b>NHP4243000A-**</b>	22,200	@ 47°F - 19,200	24 1/8" W x 32" H x 18 1/2" D	12 SEER2*	170 lbs
		@ 35°F - 15,200			
		@ 17°F - 11,400			

\*When matched with NAH4\*\*MF Air Handlers

Electrical Data				
All Units 208/230-1~60Hz				
Cond. Fan Motor 1/4 HP, 1600 RPM, 1.3 FLA				
Models	Compressor		Minimum Circuit Amps	MOP
	RLA	LRA		
<b>NHP4183000A-**</b>	10.3	45.7	14.8	25
<b>NHP4243000A-**</b>	11.7	59.5	16.6	25

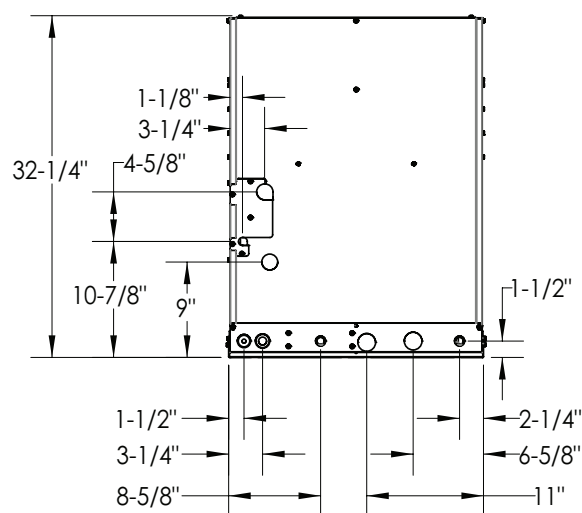
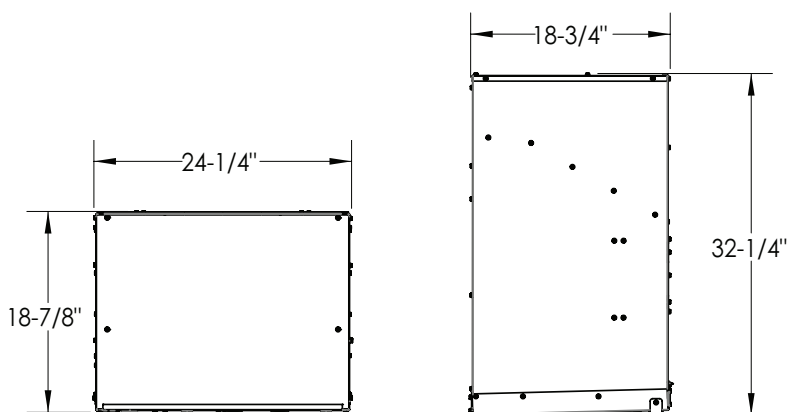
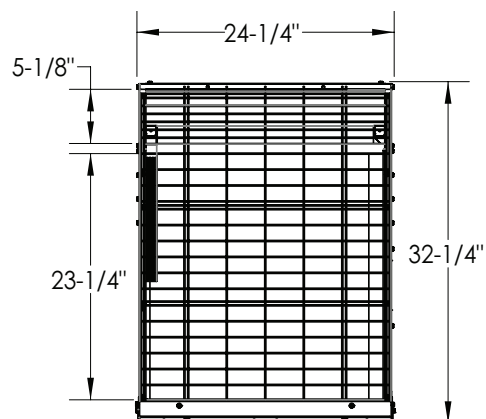

**NHP 5000 SERIES-Heat Pump**

Performance Data					
Models	Rated Cooling Capacity (Btu/h)	Rated Heating Capacity (Btu/h)	Dimensions	Efficiency Ratings	Shipping Weight
<b>NHP4185000A-**-</b>	17,800	@ 47°F - 15,800	26 7/8 W" x 38 7/8" H x 18 1/2" D	13.5 SEER2*	190 lbs
		@ 35°F - 13,000			
		@ 17°F - 9,700			
<b>NHP4245000A-**-</b>	23,600	@ 47°F - 20,800	26 7/8 W" x 38 7/8" H x 18 1/2" D	13.5 SEER2*	200 lbs
		@ 35°F - 17,200			
		@ 17°F - 13,100			
<b>NHP4305000A-**-</b>	26,800	@ 47°F - 23,800	26 7/8 W" x 38 7/8" H x 18 1/2" D	12.5 SEER2*	205lbs
		@ 35°F - 19,400			
		@ 17°F - 14,800			

\*When matched with NAH4\*\*MF Air Handlers

Electrical Data				
All Units 208/230-1~60Hz				
Cond. Fan Motor 1/5 HP, 1650 RPM, 1.8 FLA				
Models	Compressor		Minimum Circuit Amps	MOP
	RLA	LRA		
<b>NHP4185000A-**-</b>	10.3	45.7	15.3	25
<b>NHP4245000A-**-</b>	11.5	59.5	16.8	25
<b>NHP4305000A-**-</b>	12.8	65	18.5	30

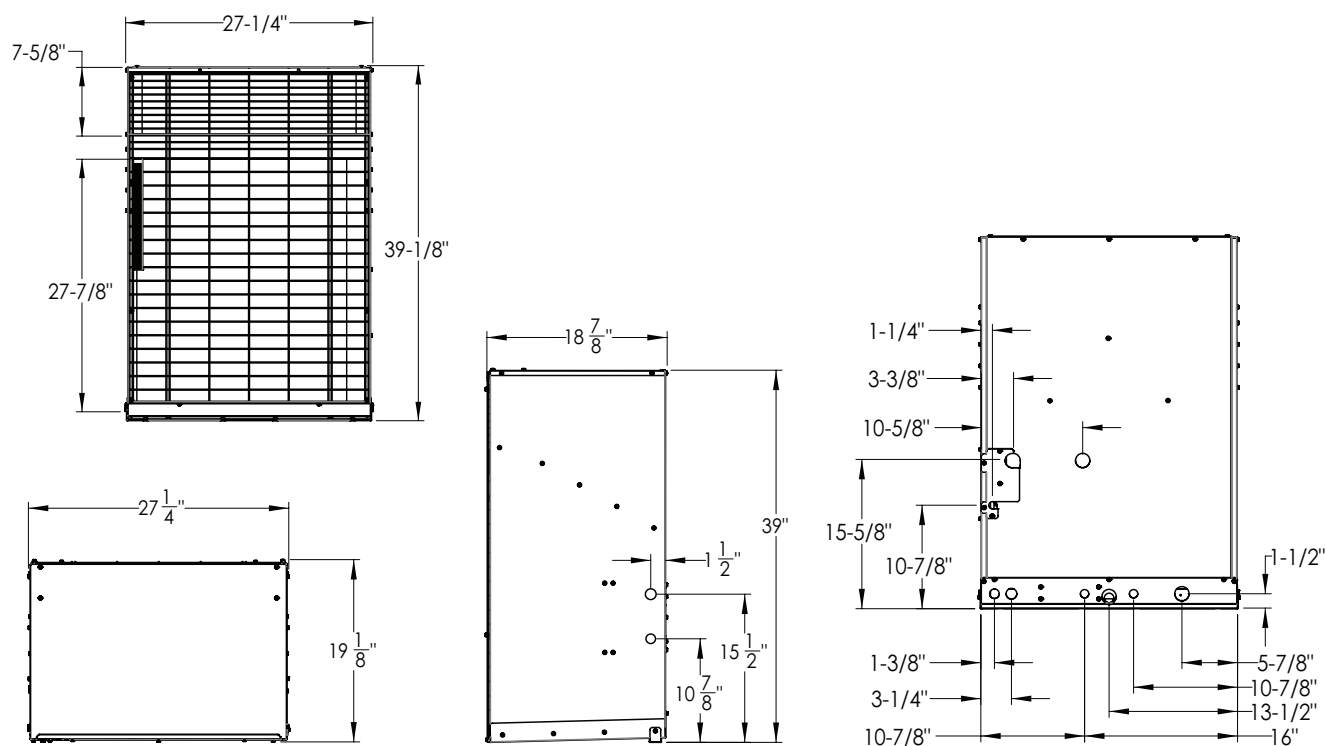

## Project:

### Multi-Family Style Air Handler NAH-MF Series

Performance Data										
All units 208/230V 1 Ph 60 Hz										
Model	Nominal Capacity (Btu/h)	Size (tons)	Nominal Air Flow <sup>1</sup> (CFM)		Motor HP	Motor RPM	FLA	MCA	MOP	Filter Size
NAH424MF*-L*	24,000	2 Ton	700	1080	1/2	1200	3.9	5	15	24" x 20"
NAH424MF*-R*										
NAH430MF*-L*	30,000	2.5 Ton								
NAH430MF*-R*										
Flow Control	Bi-flow Adjustable TXV						Line Size		3/8"& 3/4"	

1. The nominal airflow range is given at 0.1" ESP

Dimensional Data						
Model	Dimensions inch (mm)					Shipping Weight
	Height	Width	Depth	Flow Control	Line Sizes	
NAH424MF*-L*	27-2/3"	24-1/2"	27-1/2"	Adjustable TXV with Internal check valve	3/8" Liquid 3/4" Suction	140 lbs
NAH424MF*-R*						145 lbs
NAH430MF*-L*						
NAH430MF*-R*						

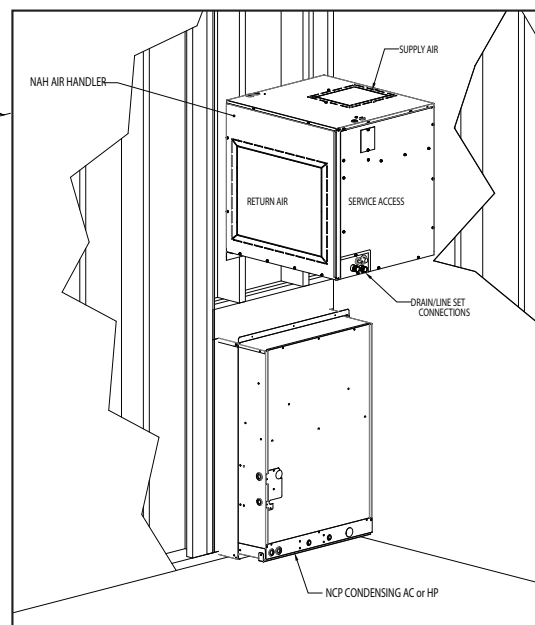
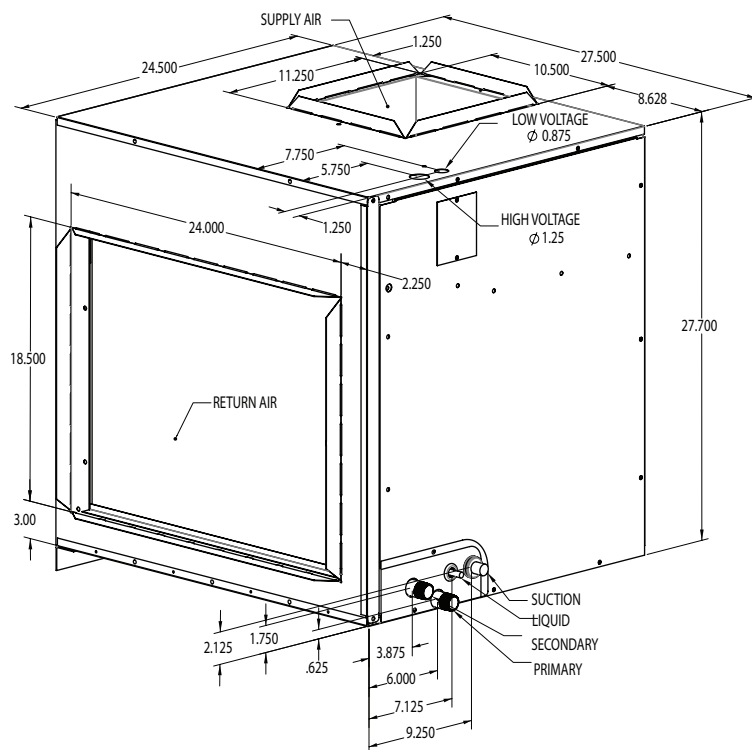

**Project:**

**Electric Heat Kit Option**

Electrical Data wth NAH-MF Series												
Blower Motor Amps		Heat Option	Heating Btuh		Heating kW		Heater Amps		MCA (Min. Circuit Ampacity)		Max Fuse or Breaker Size	
230V	208V		230V	208V	230V	208V	230V	208V	230V	208V	230V	208V
3.8	3.9	None	0	0	0	0	0	0	5	5	15	15
		CPEHK03 (3kW)	8,900	10,900	2.62	3.20	12.60	13.91	20.6	22.1	25	25
		CPEHK05 (5kW)	13,100	16,000	3.83	4.68	18.41	20.35	27.9	30.2	30	35
		CPEHK07 (7kW)	18,400	22,400	5.37	6.58	25.82	28.61	37.2	40.5	40	45
		CPEHK10 (10kW)	26,000	32,000	7.64	9.35	36.73	40.65	50.8	55.6	60	60
		CPEHK15 (15kW)	39,200	47,800	11.47	14.02	36.76	40.64	49.2	54.0	50	60
							18.38	20.32	26.2	28.6	30	30

**Project:**

Cased Coil NCC Series - R410A Models

Dimensional Data										
Model	Size (tons)	Flow Control	Liquid Line	Suction Line	Cabinet Width (W)	Cabinet Depth	Supply Opening Width (W')	Supply Opening Depth	Cabinet Height (H)	Shipping Weight
NCC418AA-1	1.5 Tons	Adj. TXV	3/8"	3/4"	17.50"	21.50"	16"	20"	20.50"	56 lbs.
NCC424AA-1	2 Tons				17.50"	21.50"	16"	20"	24.50"	62 lbs.
NCC430AA-1	2.5 Tons				21.00"	21.50"	19.50"	20"	28.50"	75 lbs.

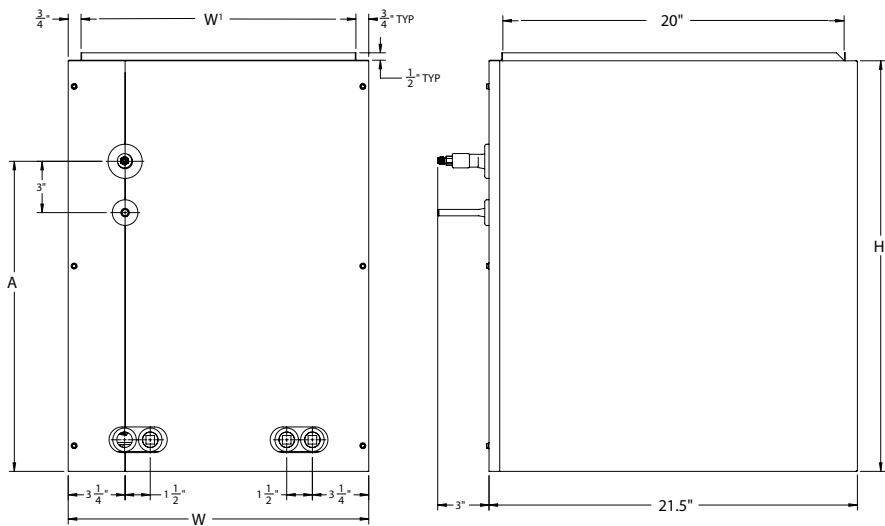
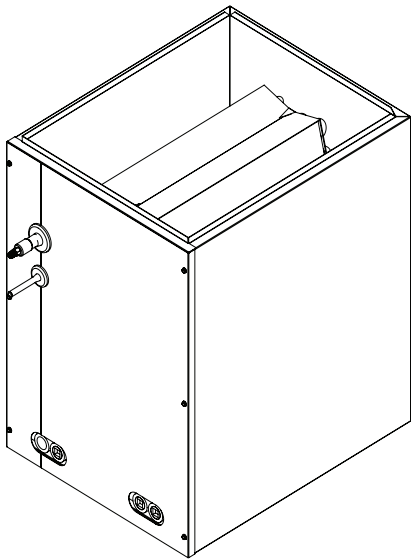

**Project:**

**Wall Sleeve**

**1000 -WSD-12**

26  $\frac{7}{8}$ " W x 29  $\frac{5}{8}$ " H

Rough in at 27  $\frac{3}{8}$ " W x 30  $\frac{1}{8}$ " H

**3000 -WSD-12**

24  $\frac{7}{8}$ " W x 33" H

Rough in at 25  $\frac{3}{8}$ " W x 33  $\frac{1}{2}$ " H

**4000 -WSD-12**

30  $\frac{5}{8}$ " W x 24" H

Rough in at 31  $\frac{1}{8}$ " W x 24  $\frac{1}{2}$ " H

**5000 -WSD-12**

28" W x 39  $\frac{7}{8}$ " H

Rough in at 28  $\frac{1}{2}$ " W x 40  $\frac{3}{8}$ " H

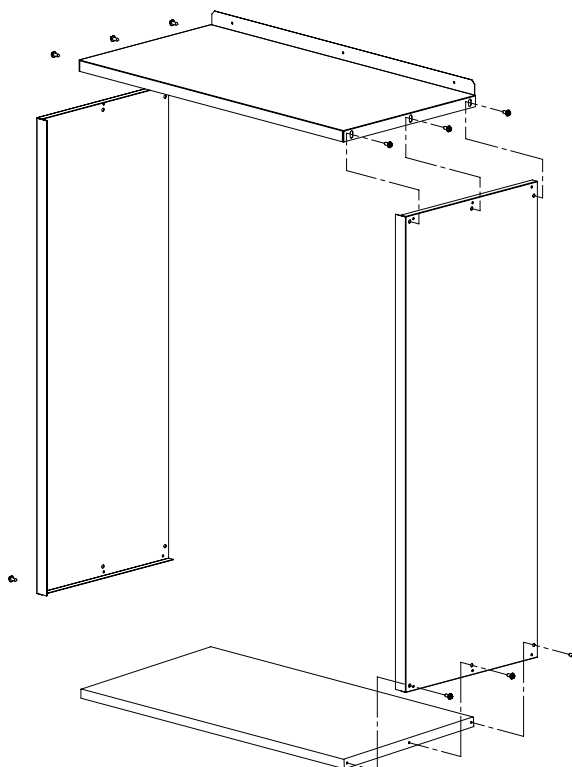
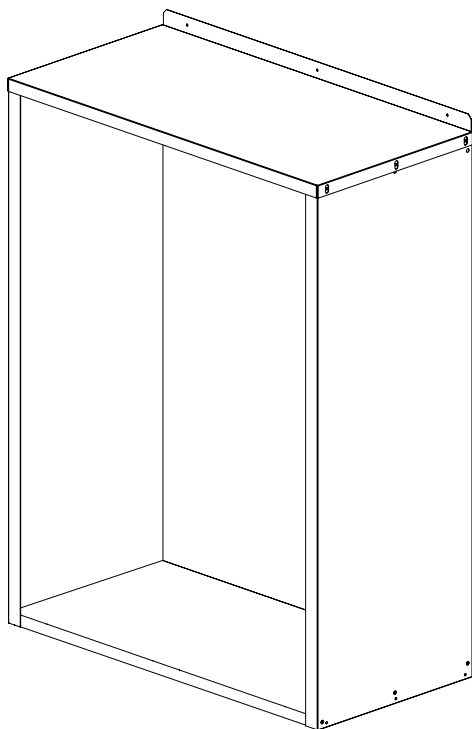

## Architectural Louver Grilles

**14269035 (1000)** (anodized aluminum finish)

**14269035-P (1000)** (painted finish)

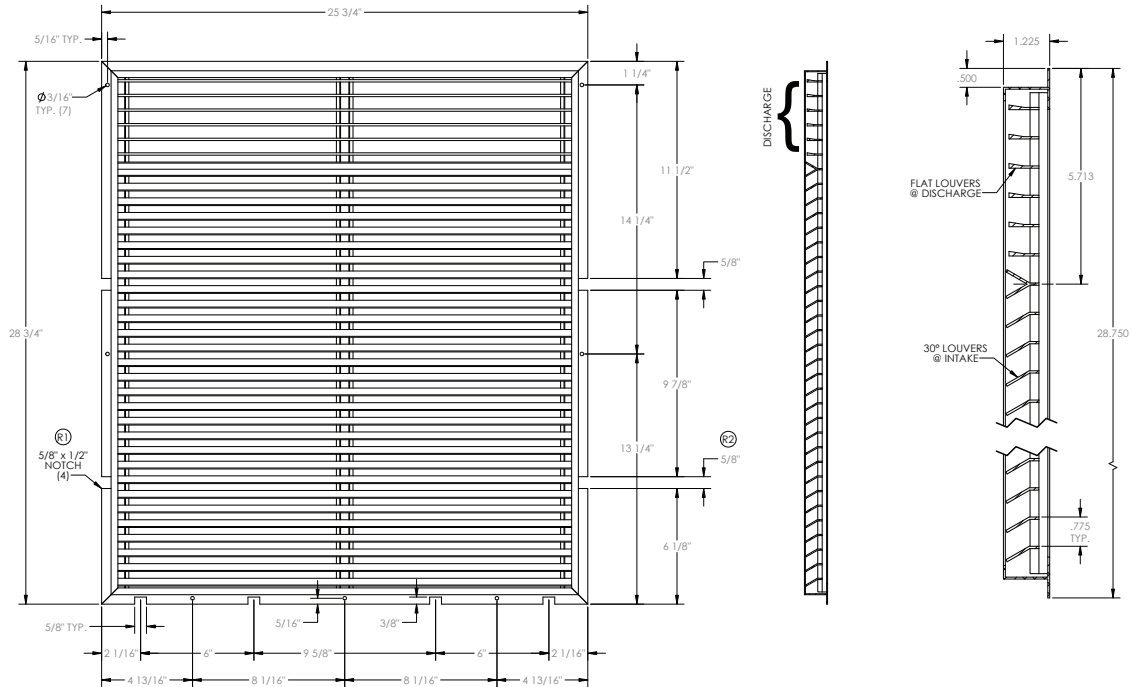

**14269036 (3000)** (anodized aluminum finish)

**14269036-P (3000)** (painted finish)

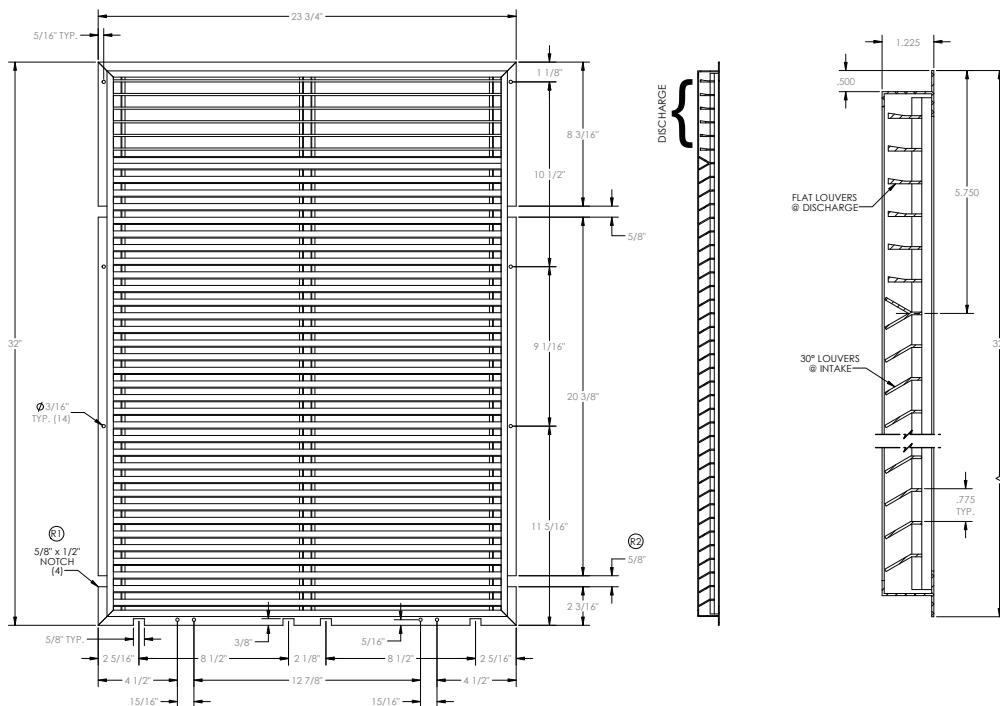

## Architectural Louver Grilles

**14269037 (4000)** (anodized aluminum finish)

**14269037-P (4000)** (painted finish)

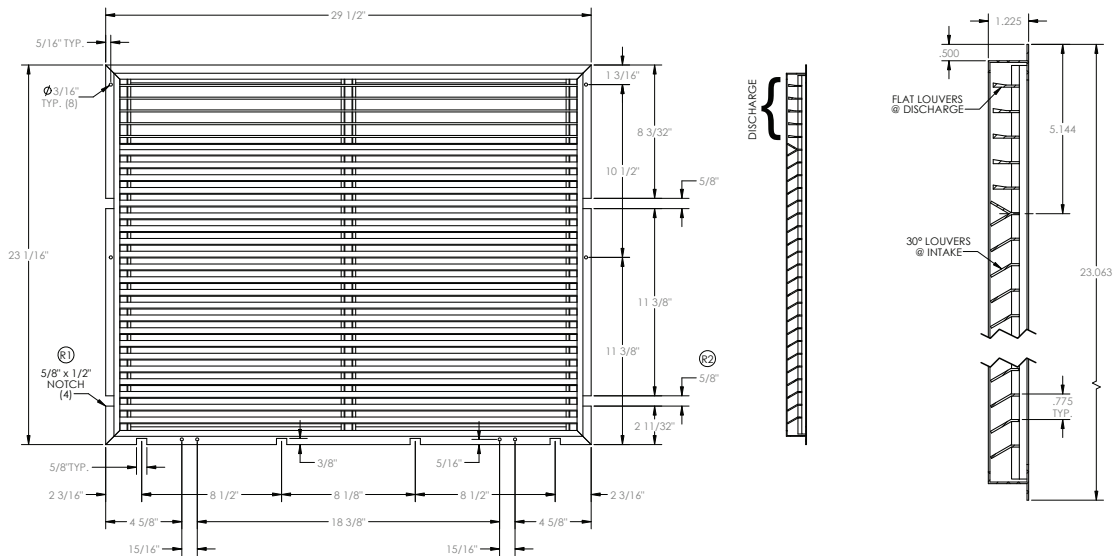

**14269038 (5000)** (anodized aluminum finish)

**14269038-P (5000)** (painted finish)

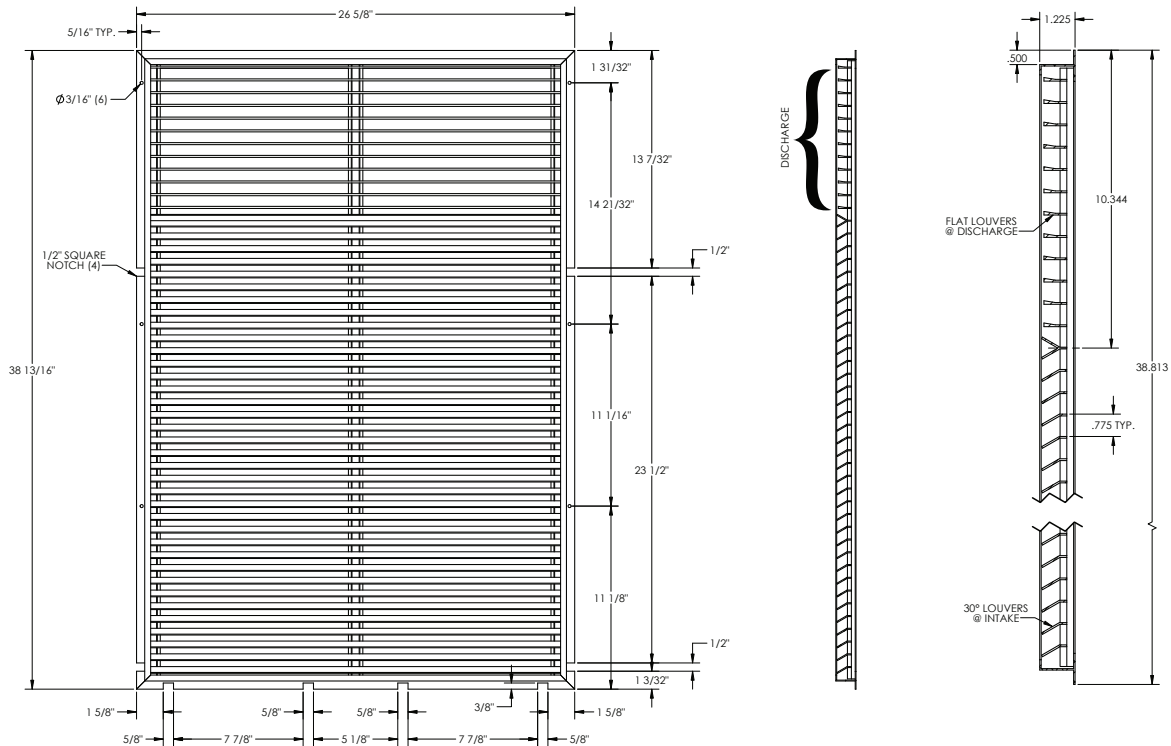



**Project:**

Architectural Louver Grilles to fit sleeve

**14269035-S (1000)** (anodized aluminum finish)

**14269035-SP (1000)** (painted finish)

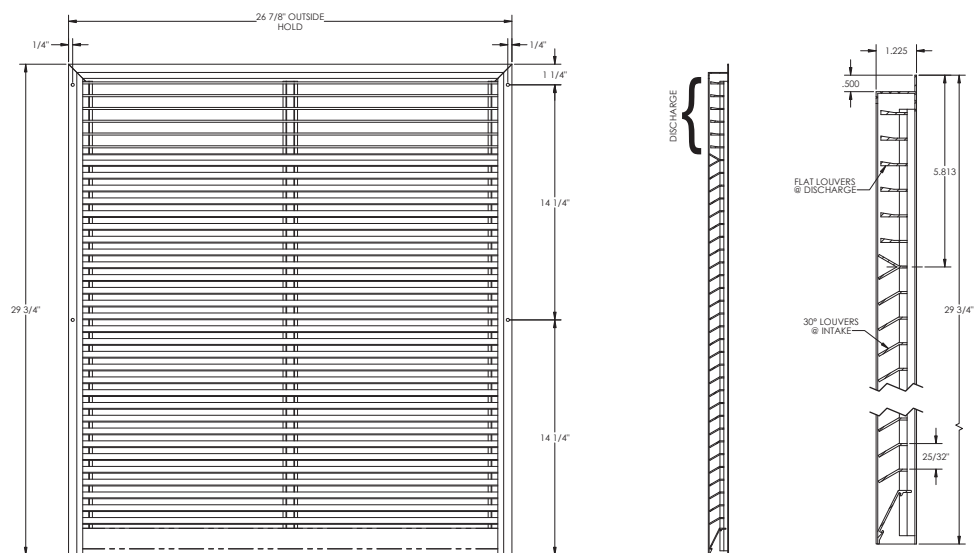

**14269036-S (3000)** (anodized aluminum finish)

**14269036-SP (3000)** (painted finish)

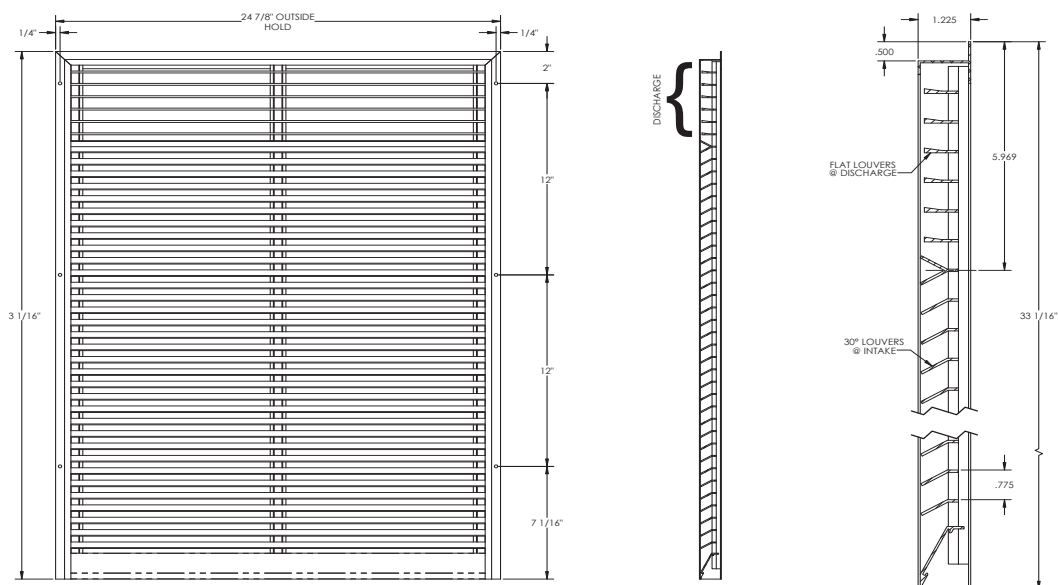

**Project:**

Architectural Louver Grilles to fit sleeve

**14269037-S (4000)** (anodized aluminum finish)

**14269037-SP (4000)** (painted finish)

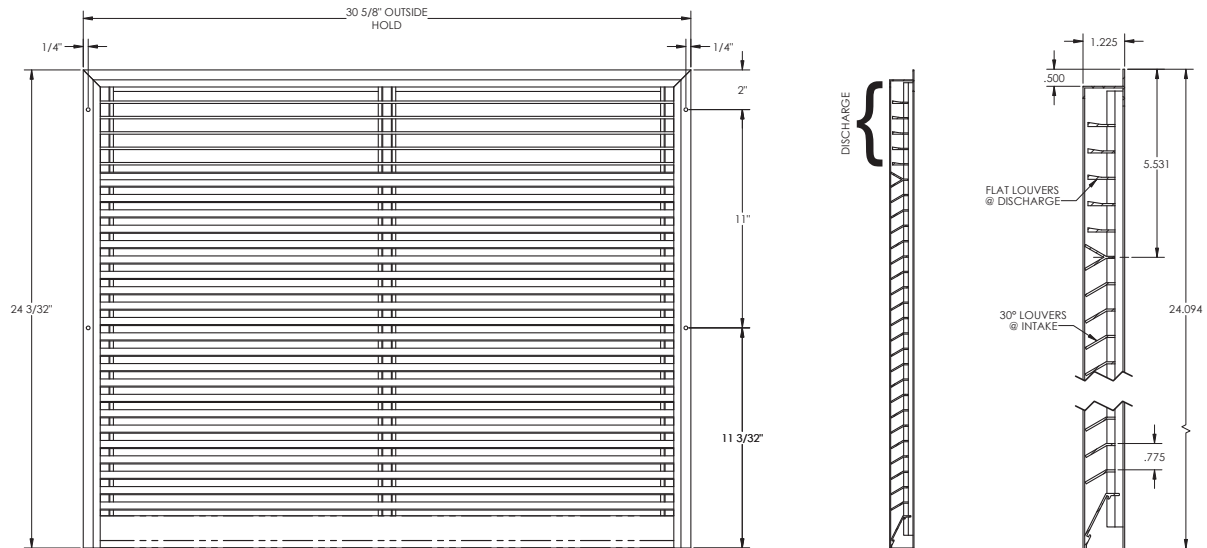

**14269038-S (5000)** (anodized aluminum finish)

**14269038-SP (5000)** (painted)

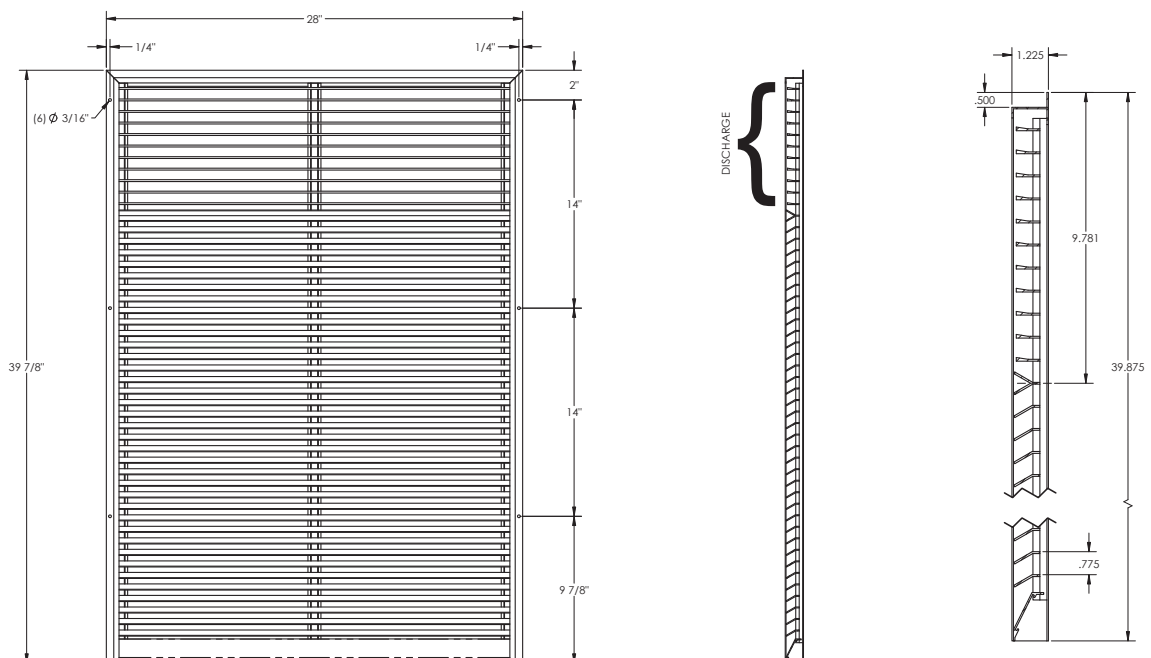

## Notes

This image shows a single sheet of white paper with horizontal ruling lines. The lines are evenly spaced and run across the width of the page. There are no margins, text, or other markings on the paper.

## Thru the Wall Split System Warranty

