

# MSZ-FS12NA 12,000 BTU/H DELUXE WALL MOUNT



Job Name:

System Reference:

Date:



## GENERAL FEATURES

- Slim wall-mounted indoor units provide zone comfort control
- Dual Barrier Coating applied to the heat exchanger, vanes and fan to prevent hydrophilic and hydrophobic dirt build-up
- Multiple fan speed options: Quiet, Low, Medium, High, Super-high, Auto
- 3D i-see Sensor® enables advance features:
  - Indirect or Direct Airflow for personalized comfort
  - Absence Detection for energy-saving mode
  - Double Vane features:
    - Separates airflow to deliver air across a large area
    - Simultaneously deliver to air separate sections of a room
  - Generates more comfortable natural airflow pattern
- Multiple control options available:
  - Back-lit screen handheld remote controller (provided with unit)
  - kumo cloud® smart device app for remote access
  - Third-party interface options
  - Wired or wireless controllers
- Triple-action Filtration: Nano Platinum Filter, Deodorizing Filter, & Electrostatic Anti-Allergy Enzyme Filter
- Hot-Start Technology: no cold air rush at equipment startup or when restarting after Defrost Cycle
- Quiet operation

| Specifications                  |                                     |                     | System   |
|---------------------------------|-------------------------------------|---------------------|--|
| Unit Type                       |                                     |                     | MSZ-FS12NA   |
| Cooling Capacity <sup>1,3</sup> |                                     | BTU/H               | 12,000   |
| Heating Capacity <sup>2,3</sup> |                                     | BTU/H               | 12,300   |
| Electrical                      | Voltage, Phase, Frequency           |                     | 208/230, 1, 60   |
|                                 | Guaranteed Voltage Range            | V AC                | 187- 253V  |
|                                 | Voltage: Indoor - Outdoor, S1-S2    | V AC                | 208/230  |
|                                 | Voltage: Indoor - Outdoor, S2-S3    | V DC                | 24   |
|                                 | Short-circuit Current Rating [SCCR] | kA                  | 5  |
| Indoor Unit                     | MCA                                 | A                   | 1.0  |
|                                 | Fan Motor Full Load Amperage        | A                   | 0.65   |
|                                 | Fan Motor Output                    | W                   | 40   |
|                                 | Airflow Rate at Cooling, Dry        | CFM                 | 137-226-221-304-424                                    |
|                                 | Airflow Rate at Cooling, Wet        | CFM                 | 117-143-190-261-364                                    |
|                                 | Airflow Rate at Heating, Dry        | CFM                 | 155-226-282-367-454                                    |
|                                 | Sound Pressure Level [Cooling]      | dB[A]               | 21-24-29-36-44   |
|                                 | Sound Pressure Level [Heating]      | dB[A]               | 21-28-32-38-43   |
|                                 | Drain Pipe Size                     | In. [mm]            | 5/8 [15.88]  |
|                                 | Coating on Heat Exchanger           |                     | Dual Barrier Coating                                   |
|                                 | External Finish Color               |                     | Munsell 1.0Y 9.2/0.2                                   |
|                                 | Unit Dimensions                     | W x D x H: In. [mm] | 36-7/16 x 9-3/16 x 12 (+11/16) [925 x 234 x 305 (+17)] |
|                                 | Package Dimensions                  | W x D x H: In. [mm] | 39 x 12-1/4 x 15-1/2 [990 x 310 x 400]                 |
|                                 | Unit Weight                         | Lbs. [kg]           | 29 [13.5]  |
|                                 | Package Weight                      | Lbs. [kg]           | 39 x 12-1/4 x 15-1/2</br>[990 x 310 x 400]             |
| Refrigerant                     | Type                                |                     | R410A  |
| Piping                          | Gas Pipe Size O.D. [Flared]         | In.[mm]             | 3/8 [6.35]   |
|                                 | Liquid Pipe Size O.D. [Flared]      | In.[mm]             | 1/4 [6.35]   |

NOTES:  
Conditions

<sup>1</sup>Cooling (Indoor // Outdoor)

°F 80 DB, 67 WB // 95 DB, 75 WB

<sup>2</sup>Heating at 47°F (Indoor // Outdoor)

°F 70 DB, 60 WB // 47 DB, 43 WB

<sup>3</sup>Capacity varies based on the number of indoor units operating and the model of the Multi-zone Outdoor Unit. For reference to connected capacity charts, please refer Multi-zone Outdoor Unit Operational Performance.:

## INDOOR UNIT ACCESSORIES: MSZ-FS12NA

|                            |   |                   |
|----------------------------|---|-------------------|
| Control Interface          | BACnet® and Modbus Interface  | PAC-UKPRC001-CN-1 |
|                            | CN24 Relay Kit  | CN24RELAY-KIT-CM3 |
|                            | IT Extender   | PAC-WHS01IE-E     |
|                            | kumo station® for kumo cloud®   | PAC-WHS01HC-E     |
|                            | Lockdown bracket for remote controller  | RCMKP1CB          |
|                            | System Control Interface  | MAC-334IF-E       |
|                            | Thermostat Interface  | PAC-US444CN-1     |
|                            | USNAP Adapter   | PAC-WHS01UP-E     |
|                            | Wireless Interface for kumo cloud®  | PAC-USWHS002-WF-2 |
| Remote Sensor              | Wired Remote Sensor   | M21EAA307         |
|                            | Wireless temperature and humidity sensor for kumo cloud®                                    | PAC-USWHS003-TH-1 |
| Wired Remote Controller    | Deluxe Wired MA Remote Controller†  | PAR-40MAAU        |
|                            | Simple MA Remote Controller†  | PAC-YT53CRAU-J    |
|                            | Touch MA Controller†  | PAR-CT01MAU-SB    |
| Wireless Remote Controller | kumo touch™ RedLINK™ Wireless Controller  | MHK2              |
| Condensate                 | Blue Diamond (Advanced) Mini Condensate Pump w/ Reservoir & Sensor (208/230V) [recommended] | X87-721           |
|                            | Blue Diamond (MicroBlue) Mini Condensate Pump (110/208/230V) up to 18,000 BTU/H             | X85-003           |
|                            | Blue Diamond Alarm Extension Cable — 6.5 Ft.  | C13-192           |
|                            | Blue Diamond MultiTank — collection tank for use with multiple pumps                        | C21-014           |
|                            | Blue Diamond Sensor Extension Cable — 15 Ft.  | C13-103           |
|                            | Drain Pan Level Sensor/Control  | SS610E            |
|                            | Fascia Kit for MicroBlue Pump, mounts the MicroBlue and sensor directly beneath indoor unit | T18-016           |
|                            | Sauermann Condensate Pump   | SI30-230          |
| Disconnect Switch          | (30A/600V/UL) [fits 2" X 4" utility box] - Black  | TAZ-MS303         |
|                            | (30A/600V/UL) [fits 2" X 4" utility box] - White  | TAZ-MS303W        |
| Filter                     | Electro Static Anti-allergy Enzyme Filter   | MAC-2330FT-E      |
|                            | Platinum Deodorizing Filter   | MAC-3000FT-E      |
| Lineset                    | 15' x 1/4" x 15' / 1/2" Lineset (Twin-Tube Insulation)                                      | MLS141212T-15     |
|                            | 30' x 1/4" x 30' / 1/2" Lineset (Twin-Tube Insulation)                                      | MLS141212T-30     |
|                            | 50' x 1/4" x 50' / 1/2" Lineset (Twin-Tube Insulation)                                      | MLS141212T-50     |
|                            | 65' x 1/4" x 65' / 1/2" Lineset (Twin-Tube Insulation)                                      | MLS141212T-65     |

### NOTES:

†Requires MAC-334IF-E

•Allows indoor units to connect to an MA Controller:

Deluxe MA Remote Controller

Simple MA Controller

Touch MA Controller

# INDOOR UNIT DIMENSIONS: MSZ-FS12NA

Unit: inch

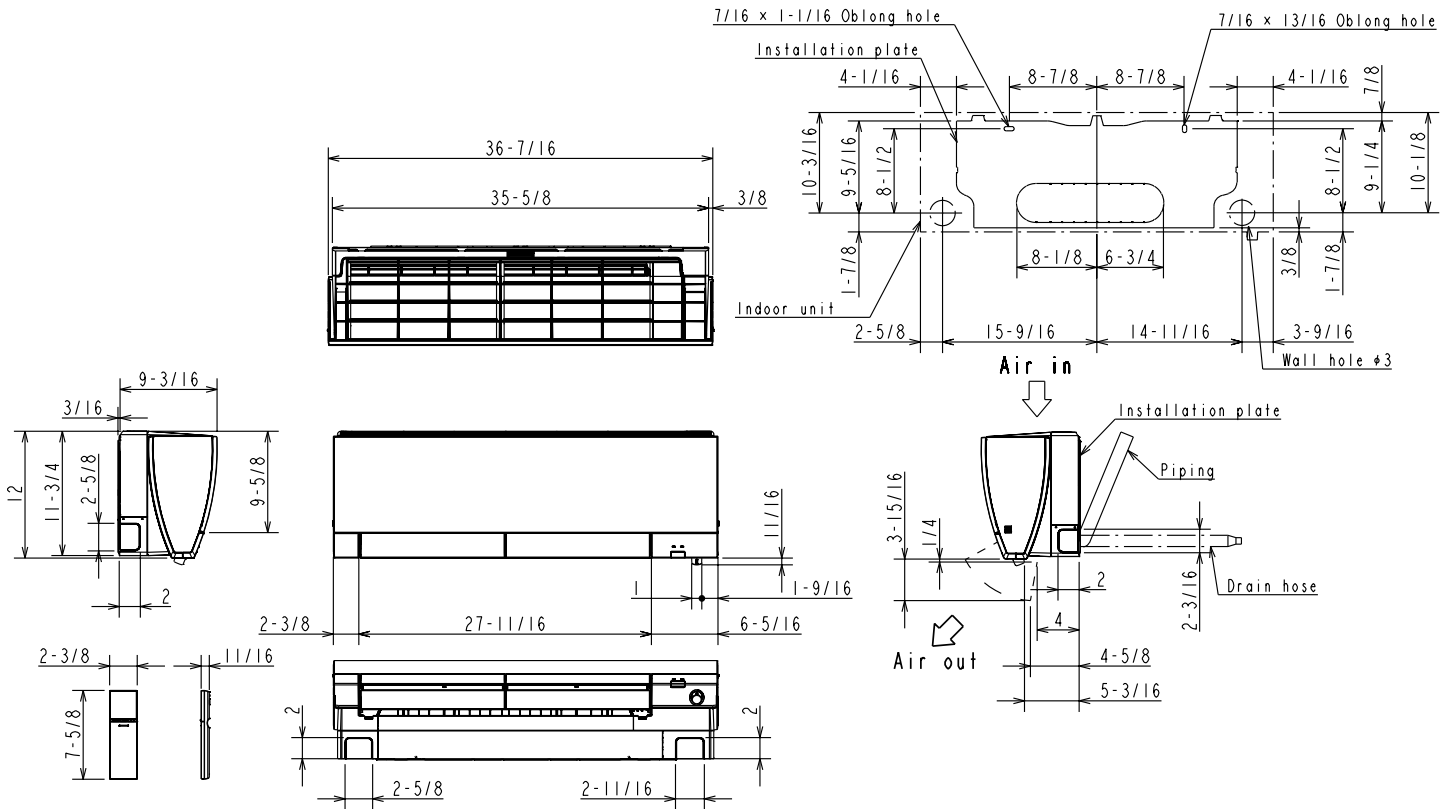

(06/09/12 KBTU/H)

|        |             |  |
|--------|-------------|--|
| Piping | Insulation  | 1-7/16 O.D.                              |
|        | Liquid line | 1/4 19-11/16 (Flared connection 1/4)     |
|        | Gas line    | 3/8 16-15/16 (Flared connection 3/8)     |
|        | Drain hose  | Insulation 1-1/8 Connected part 5/8 O.D. |

(15/18 KBTU/H)

|        |             |  |
|--------|-------------|--|
| Piping | Insulation  | 1-7/16 O.D.                              |
|        | Liquid line | 1/4 19-11/16 (Flared connection 1/4)     |
|        | Gas line    | 3/8 16-15/16 (Flared connection 1/2)     |
|        | Drain hose  | Insulation 1-1/8 Connected part 5/8 O.D. |

1340 Satellite Boulevard Suwanee, GA 30024  
Toll Free: 800-433-4822 www.mehvac.com

FORM# MSZ-FS12NA-U1 - 202102

