

5

4

3

2

1

C

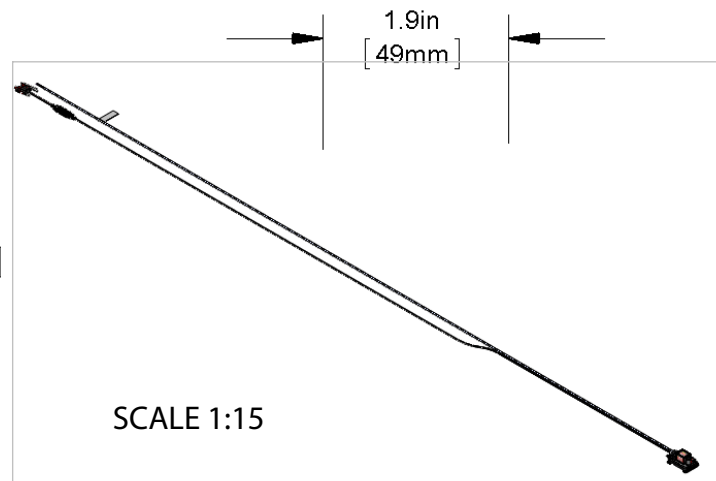
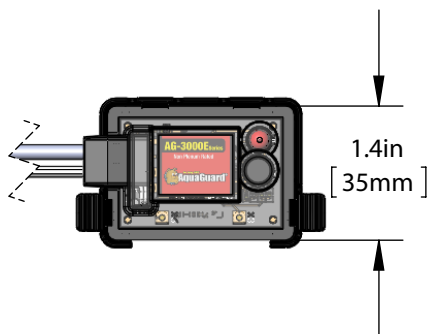
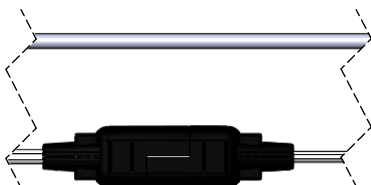
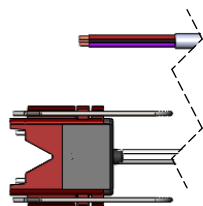

C

B

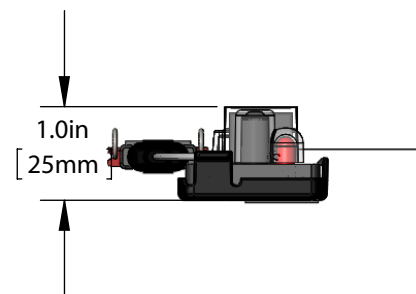
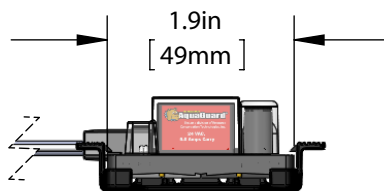

B

NOTES:  
AG-3180 24 VAC, 5.0 AMPS  
BREAKING/CARRYING  
PLENUM RATED

UNLESS OTHERWISE SPECIFIED:

DIMENSIONS ARE IN INCHES  
TOLERANCES:  
FRACTIONAL  $\pm .032$   
ANGULAR: MACH  $\pm .5^\circ$  BEND  $\pm 2^\circ$   
TWO PLACE DECIMAL  $\pm .010$   
THREE PLACE DECIMAL  $\pm .005$

INTERPRET GEOMETRIC  
TOLERANCING PER: ANSI Y14.5, 1994

ENGINEERING	NAME	DATE
DRAWN BY ENG.	JK	3/1/12
CHECKED BY ENG.	DS	3/1/12
ENG APPR.	CC	3/1/12
MFG APPR.	CC	3/1/12

PROPRIETARY AND CONFIDENTIAL

THE INFORMATION CONTAINED IN THIS  
DRAWING IS THE SOLE PROPERTY OF  
RECTORSEAL.  
ANY REPRODUCTION IN PART OR AS A  
WHOLE WITHOUT THE WRITTEN  
PERMISSION OF RECTORSEAL IS  
PROHIBITED.



2601 Spenwick Drive,  
Houston, TX 77055  
800-231-3345

TITLE:

AG-3180 SPEIFICATION SHEET

SIZE  
A

SCALE: 1:2

SHEET 1 OF 1

A

5

4

3

2

1