

# PAC-US444CN-1

Job Name:

System Reference:

Date:

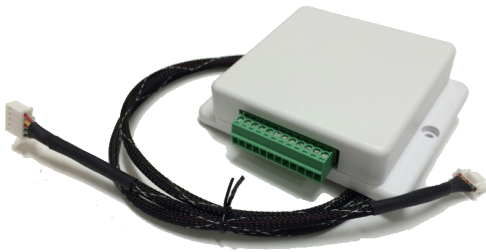

PAC-US444CN-1

## TERMINALS:

| Connector | Purpose      | Purpose          |
|-----------|--------------|------------------|
| TC        | Common (In)  | To Transformer   |
| C         | Common (Out) | To Thermostat    |
| TR        | 24VAC (In)   | To Transformer   |
| R         | 24VAC (Out)  | To Thermostat    |
| G3        | Fan High     | High Fan Speed   |
| G2        | Fan Medium   | Medium Fan Speed |
| G1        | Fan Low      | Low Fan Speed    |
| Y2        | Y2           | Stage 2 Cooling  |
| Y1        | Y1           | Stage 1 Cooling  |
| W2        | W2           | Stage 2 Heating  |
| W1        | W1           | Stage 1 Heating  |
| G         | G            | Fan              |

## SPECIFICATIONS:

- Allows a HVAC Thermostat or I/O Controller to control a Mitsubishi Electric Cooling & Heating CITY MULTI® or M-Series or P-Series indoor unit.
- One Thermostat Interface per indoor unit
- Indoor unit modes: Cool, Heat, Fan, and Off
- Provides 3 input terminals to control fan speed control:
  - High
  - Medium
  - Low
- Addressing: No addressing required
- Connection: CN105 - IT Terminal
- Thermostats Tested:
  - Nest®
  - Honeywell®
  - Lyric®
  - INNCOM® with fan speed control
- Dimensions: (H x W x D) 3.96 in x 3.17 in x 0.93 in
- Terminal Block: 20-30 VAC Rated

## REQUIREMENTS:

- Compatible Mitsubishi Electric indoor unit
  - See compatibility chart on page 3HVAC Thermostat or I/O Controller (field supplied)
- 24VAC circuit for HVAC Thermostat (field supplied)

## ADVANCED FEATURES:

- Delayed Off Adjustable Setting
  - 0, 5 (default), 10, or 30 minutes
- Fan Speed
  - Auto (Default, more efficient than Custom Auto)
  - Medium
  - High
  - Custom Auto (more comfortable than Auto)
- Static Pressure Adjustable Setting
- Set Fan & CN24 operation during Defrost
- Set fan speed in thermal off for heating mode
- INVERTER operation settings:
  - Optimized variable capacity (Preferred)
    - o Conventional 2H/2C thermostat
- Auto recovery after power failure

## ACCESSORIES:

- Transformer (VPL24-210)

# PAC-US444CN-1: DIMENSIONS AND WIRING DIAGRAMS

## DIMENSIONS:

Unit: mm (inch)

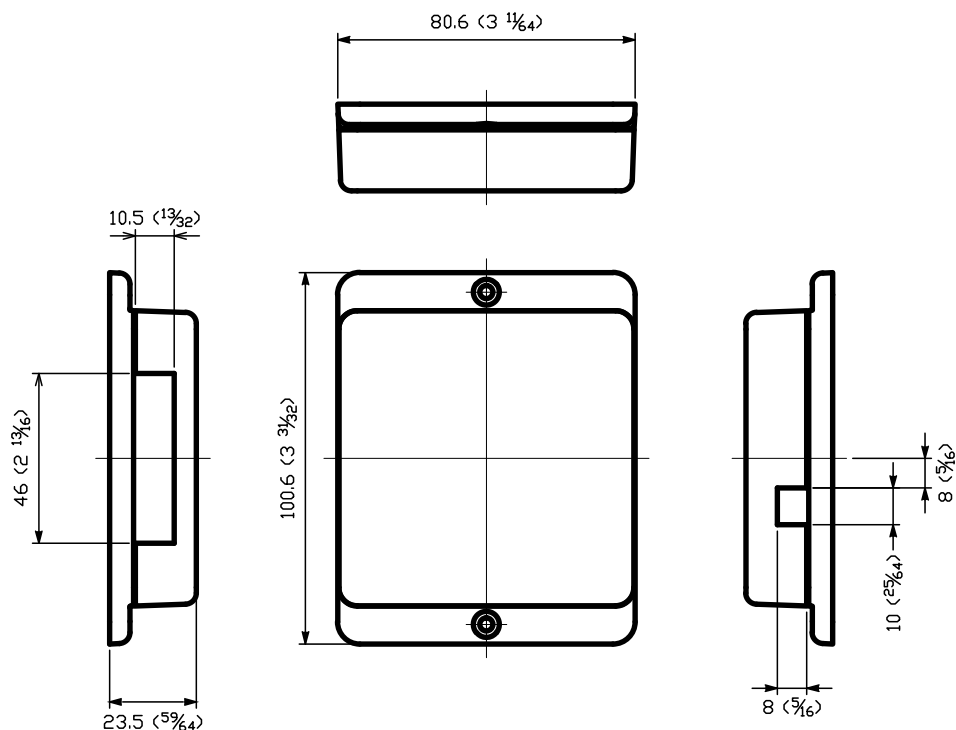

## WIRING DIAGRAMS:

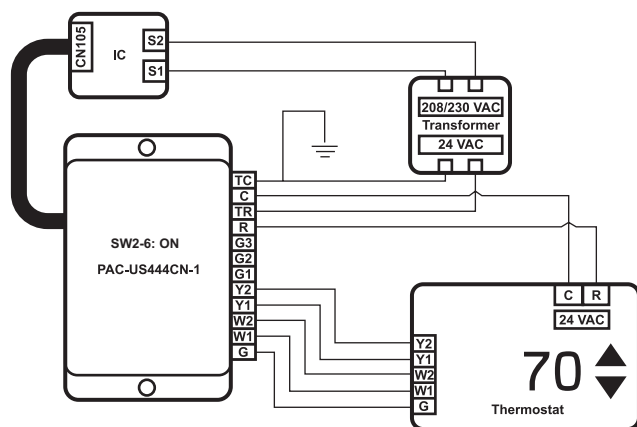

Two-stage Cooling and Heating

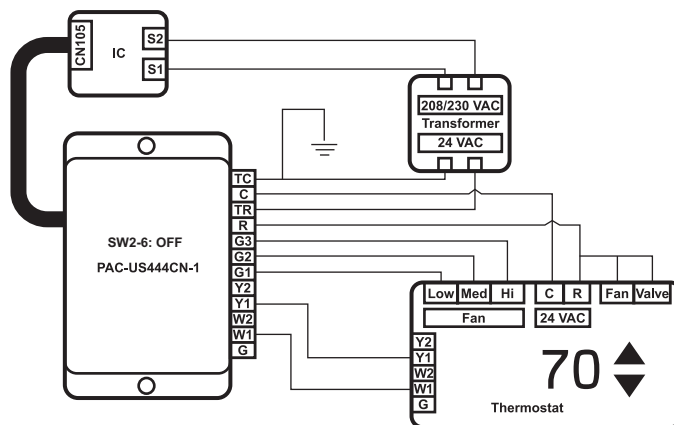

Two-stage Single-stage Cooling and Heating with Dedicated Fan Speed Relays

# PAC-US444CN-1: COMPATIBILITY CHART

PAC-US444CN-1 (Thermostat Interface) must order separately

| CITYMULTI®        |  |                   |   |                   |   |
|-------------------|--|-------------------|---|-------------------|---|
| <b>PMFY-NMBU</b>  | (E) NO<br>(ER5) OK<br>(After April 2012)           | <b>PLFY- NBMU</b> | (E) NO<br>(ER2) OK<br>(After April 2012)                | <b>PV FY-E00</b>  | (A) OK<br>(B) OK<br>(After April 2012)  |
| <b>PEFY-NMU</b>   | (NMU-E) NO<br>(After April 2012)                   | <b>PLFY- NCMU</b> | (E) NO<br>(ER4) OK<br>(After June 2012)                 | <b>PV FY-NAMU</b> | (E) OK<br>(After April 2012)            |
| <b>PEFY-NMAU</b>  | (E) NO<br>(E2) OK<br>(E3) OK<br>(After April 2012) | <b>PLFY- NLMU</b> | (E) NO  | <b>PKFY-NAMU</b>  | (E) NO                                  |
| <b>PEFY-NMHSU</b> | (E) OK<br>(After April 2012)                       | <b>PCFY- VKM</b>  | NO  | <b>PKFY-NFMU</b>  | (E) NO                                  |
| <b>PEFY-NMHU</b>  | (E) OK<br>(E2) OK<br>(After April 2012)            | <b>PCFY- NGMU</b> | (E) NO  | <b>PKFY-NGMU</b>  | (E) NO                                  |
| <b>PEFY-NMLU</b>  | (E) NO   | <b>PCFY- NKMU</b> | (E) NO<br>(E.TH) NO<br>(ER1.TH) OK<br>(After June 2012) | <b>PKFY-NBMU</b>  | (E) NO<br>(E2) OK<br>(After April 2012) |
| <b>PEFY-NMSU</b>  | (E) NO<br>(ER2) OK<br>(After June 2012)            | <b>PFFY-NEMU</b>  | (E) OK<br>(After April 2012)                            | <b>PKFY-NHMU</b>  | (E) NO<br>(E2) OK<br>(After May 2012)   |
| <b>PLFY- NAMU</b> | (E) NO   | <b>PFFY-NRMU</b>  | (E) OK<br>(After April 2012)                            | <b>PKFY-NKMU</b>  | (E) NO<br>(E2) OK<br>(After June 2012)  |

| M-Series   | P-Series  |
|--|---|
| <b>MFZ-KA</b> OK   | <b>PCA</b> (GA) NO<br>(KA) NO<br>(KA4) OK<br>(KA4.TH) OK<br>(KA6) OK                      |
| <b>MSZ/Y-A</b> NO  |   |
| <b>MSZ/Y-D</b> (NA) NO<br>(NA-8) OK  |   |
| <b>MS-WA</b> NO  | <b>PEA</b> (AA) NO<br>(AA4) OK<br>(AA4R1.TH) OK   |
| <b>MSZ-FD</b> NO   |   |
| <b>MSZ-FE</b> 09, 12 (NA) NO<br>09, 12 (NA-8) OK<br>18 (NA) OK                                   | <b>PEAD</b> (AA) NO<br>(AA4) OK<br>(AA5) OK   |
| <b>MSZ-GE</b> 06 (NA) NO<br>06 (NA-8) OK<br>06 (NA-9) OK   | <b>PKA</b> (HA) NO<br>(HAL) NO<br>(HA4) OK<br>(HA6) OK<br>(KA) NO<br>(KA4) OK<br>(KA6) OK |
| <b>MSZ/Y-GE</b> 09, 12, 18 (NA) NO<br>09, 12, 18 (NA-8) OK<br>09, 12, 18 (NA-9) OK<br>24 (NA) OK |   |
| <b>MSZ-FH</b> OK   | <b>PLA</b> (AA) NO<br>(BA) NO<br>(BA-1) NO<br>(BA4) OK<br>(BA6) OK                        |
| <b>MSZ-HE</b> NO   |   |
| <b>MVZ-AA4</b> OK  |   |
| <b>SEZ-KD</b> (NA) NO<br>(NA4) OK  | <b>PVA</b> (AA4) OK   |
| <b>SLZ-KA</b> OK   |   |

Manufactured for MITSUBISHI ELECTRIC US, INC.

1340 Satellite Boulevard, Suwanee, GA 30024

Toll Free: 800-433-4822 www.mehvac.com