



Description

The Clean Comfort™ AM11 Series of MERV 11 media air cleaners for residential applications helps remove a wide range of airborne particles as small as 0.3 micron.

- Intuitively designed with outer dimensions that match original equipment furnace and air handler cabinets for quick installation

Standard Features

- Includes MERV 11 media filter, rated at 492 feet/minute, removes airborne particles down to 0.3 micron
- Filter design features a structured density gradient for sustained efficiency over the life of the filter
- Filter material is constructed of cellulose-free, hydrophobic polyolefin fibers
- Extra deep, 4 1/2 inch pleated filter
- Filter has a tight cabinet fit ensuring minimal air bypass
- Quick and easy filter change
- Dual gasketed door for proper air seal
- Filter frame designed with dual pull tabs for easy removal
- Heavy duty, 20 gauge, pre-painted, corrosion resistant cabinet and door
- All cabinet mounting holes slotted and designed to lineup with original equipment flanges for time saving installation
- Reversible air flow - Horizontal or Vertical

MERV 11 MEDIA AIR CLEANERS



* Warranty doesn't apply to media filter or optional activated carbon VOC filter. Other exceptions apply. Complete warranty details available from your local dealer or at www.cleancomfort.com.

SPECIFICATIONS							
	Furnaces				Air Handlers		
MODEL	AM11-1425-FA	AM11-1625-FB	AM11-2025-FC	AM11-2525-FD	AM11-1620-AB	AM11-2020-AC	AM11-2520-AD
House Size Area	Up to 2400 ft ² (223 m ³)	Up to 3000 ft ² (279 m ³)	Up to 4000 ft ² (372 m ³)	Up to 4000 ft ² (372 m ³)	Up to 2400 ft ² (223 m ³)	Up to 3000 ft ² (279 m ³)	Up to 4000 ft ² (372 m ³)
Airflow	Up to 1200 CFM (2039 m ³ /hr)	Up to 1400 CFM (2379 m ³ /hr)	Up to 2000 CFM (3398 m ³ /hr)	Up to 2000 CFM (3398 m ³ /hr)	Up to 1200 CFM (2039 m ³ /hr)	Up to 1400 CFM (2379 m ³ /hr)	Up to 2000 CFM (3398 m ³ /hr)
Duct Size	14 x 25 in (35.6 x 63.5 cm)	16 x 20 in (40.5 x 63.5 cm)	25 x 20 in (63.5 x 51 cm)	25 x 25 in (63.5 x 63.5 cm)	16 x 20 in (40.5 x 51 cm)	20 x 20 in (51 x 51 cm)	25 x 20 in (63.5 x 51 cm)
Unit Weight	17 lbs. (7.7kg)	18 lbs. (8.2kg)	20 lbs. (9.1kg)	21 lbs. (9.5kg)	17 lbs. (7.7kg)	19 lbs. (8.6kg)	20 lbs. (9.1kg)
Pressure Drop	0.07in. w.g. @ 246 fpm	0.06in. w.g. @ 246 fpm	0.06in. w.g. @ 246 fpm	0.05in. w.g. @ 246 fpm	0.07in. w.g. @ 246 fpm	0.07in. w.g. @ 246 fpm	0.06in. w.g. @ 246 fpm
	0.21in. w.g. @ 492 fpm	0.19in. w.g. @ 492 fpm	0.19in. w.g. @ 492 fpm	0.15in. w.g. @ 492 fpm	0.21in. w.g. @ 492 fpm	0.20in. w.g. @ 492 fpm	0.19in. w.g. @ 492 fpm
MERV Rating	11	11	11	11	11	11	11
Filtration Efficiency E1 (0.3 - 1.0 micron)	30.10%	26.00%	33.50%	33.50%	30.10%	34.30%	33.50%
Filtration Efficiency E2 (1.0 - 3.0 micron)	66.60%	65.5%	66.00%	66.00%	66.60%	66.70%	66.00%
Filtration Efficiency E3 (3.0 - 10.0 micron)	91.10%	85.4%	89.60%	89.60%	91.10%	89.60%	89.60%

DIMENSIONS (in)									
MODEL	A	A2	B1	B2	C	D	E	F	G
AM11-1425-FA	14.1	15.0	27.9	28.5	0.8	0.8	3.3	12.5	23.9
AM11-1620-AB	17.5	17.6	21.0	21.7	1.5	0.8	1.8	14.5	18.5
AM11-1625-FB	17.5	17.6	27.9	28.5	1.5	0.8	3.3	14.4	23.8
AM11-2020-AC	21.0	21.1	21.0	21.7	1.3	0.8	1.8	18.5	18.5
AM11-2025-FC	21.0	21.1	27.9	28.5	1.3	0.8	3.3	18.5	23.9
AM11-2520-AD	25.1	26.0	21.0	21.7	1.8	0.8	1.8	21.4	18.5
AM11-2525-FD	25.1	26.1	27.9	28.5	1.1	0.8	3.3	23.0	23.8

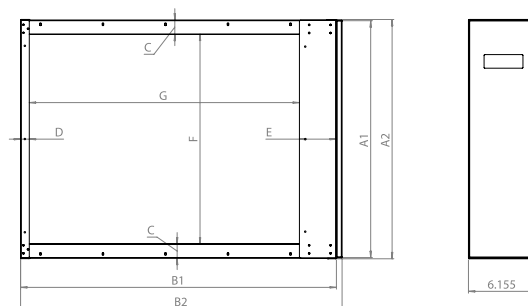

Daikin North America LLC reserves the right to discontinue or change at any time, specifications or designs without notice or without incurring obligations. Performance of the Air Cleaners will depend on house plan design, duct design and heating/cooling equipment.

Replacement Media Filters

	Air Cleaner Model #	Replacement Filter Part #
Furnaces	AM11-1425-FA	AMP-11-1425-45
	AM11-1625-FB	AMP-11-1625-45
	AM11-2025-FC	AMP-11-2025-45
	AM11-2525-FD	AMP-11-2525-45
Air Handlers	AM11-1620-AB	AMP-11-1620-45
	AM11-2020-AC	AMP-11-2020-45
	AM11-2520-AD	AMP-11-2025-45

Replacement filters are packaged 5 per box. Filter should be changed once or twice a year based on conditions within the home.