

Universal Heating  
Cross Reference  
Charts



780-910 Universal Hot Surface  
Ignition Control

The 780-910 Uni-Kit is designed to replace the widest variety of hot surface ignition modules available today, including systems using:

- Local (sense through the hot surface ignitor) or remote flame sensors.
- Single or three ignition attempts or 7 second ignition trial time.
- 17 or 34 second ignitor warm-up time.
- 34 seconds or less pre-purge.
- Natural or L.P. gas controls.
- 120V AC hot surface ignitors.

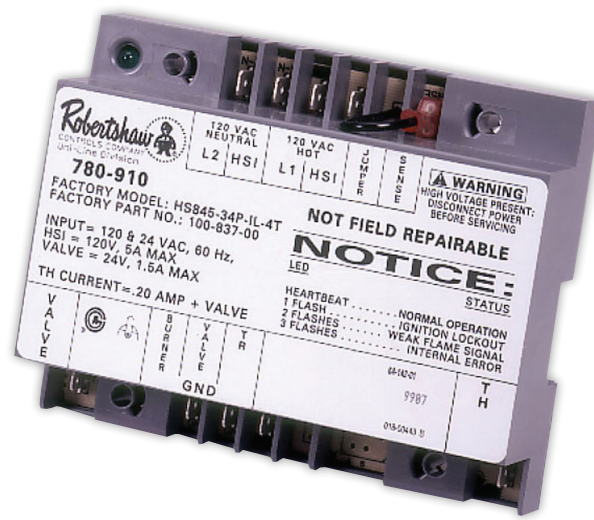

Uni-Line Part No.	Supply Voltage	Input Voltage	Maximum Ignitor Current	Maximum Total Current Load	Thermostat Anticipator Setting	Ambient Temperature	Operating Humidity
780-910	120V AC 50/60 Hz	24V AC 50/60 Hz	5 amps resistive	5 amps at 24V AC	1 amp plus load	-40 to 176°F (-40 to 80°C)	95% noncondensing at 104°F

White-Rodgers Cross Reference

The 780-910 Uni-Kit replaces White-Rodgers 50E47-1 thru 50E47-379 and 50F47-1 thru 50F47-379.

Robertshaw 780-910 replaces all of the following manufacturers' part numbers.

100-00812-01	100-00812-18	100-00812-37	1474-0061/A	780-785	HS780-17/NR-308A
100-00812-02	100-00812-19	100-00812-38	182635	780-786	HS780-34/NL-108A
100-00812-03	100-00812-20	100-00812-39	232252	780-787	HS780-34/NL-304A
100-00812-04	100-00812-21	100-00812-40	30X84	780-788	HS780-34/NL-306A
100-00812-05	100-00812-22	100-00812-42	3200579	780-789	HS780-34/NL-308A
100-00812-06	100-00812-23	100-00812-44	3200624	780-790	HS780-34/NL-312A
100-00812-07	100-00812-24	100-00812-45	3202232	7900005	HS780-34/NR-306A
100-00812-08	100-00812-25	100-00812-47	3704	91DNN-1205	HS780-34/NR-308A
100-00812-09	100-00812-26	100-00812-51	41-AP10758	924547	HS780-34/NR-312A
100-00812-10	100-00812-28	100-00812-58	41-AP10758/5	9365401	HS780-34/PL-308A
100-00812-11	100-00812-29	100-00812-60	601004	94848	HS780-34/PR-304A
100-00812-12	100-00812-30	100-00821-61	62-22578-01	AP11717	HS780-34/PR-308A
100-00812-13	100-00812-31	100-00837-00	62-22578-02	C6485802	HS845-34-1L-4T
100-00812-13	100-00812-32	10423400	6245130	HS780-17/NL-104A	L38-667
100-00812-14	100-00812-33	661618	10528	HS780-17/NL-108A	M1168A
100-00812-15	100-00812-34	1474-004	780-780	HS780-17/NL-304A	M1196X
100-00812-16	100-00812-35	1474-006	780-783	HS780-17/NR-104A	S8910U1000
100-00812-17	100-00812-36	1474-006/A	780-784	HS780-17/NR-306A	X294-47

Universal Electronic Ignition  
Gas Valve Uni-Kit

- Provides dual automatic valves (redundant).
- Installs easier with wiring connections, manual selector and adjustments on top of valve.
- Meets all codes requiring dual valve safety shutoff.
- Reduces service truck stock - freeing up valuable space and saving money.



The 720-079 Universal Electronic Ignition Gas Valve Uni-Kit is designed to work equally well on these applications:

- Intermittent pilot
- Direct spark
- Hot surface

Uni-Line Part No.	Description	Factory Model	Inlet Size (FPT)	Outlet Size (FPT)	Pressure Regulator Setting	Capacity	Comments
720-079	Universal model for Intermittent pilot, Direct spark, or Hot surface	7200IIPER	1/2"	3/4" plus 1/2" side outlets with plugs	3.5" W.C. natural gas Includes LP conversion kit	150,000	Has pilot outlet

Robertshaw 720-079 replaces all of the following manufacturers' part numbers.

1100-260	36E01-238	36E36-235	601231	71B11C018	71J11C018	7A6C3C053	CAEF29CK261	VR8204A2100	VR8440M2057
13885A	36E01-240	36E36-237	60-42462-01	71B11C036	71K01B027	788A8B003	EF32C5194	VR8204A2118	VR8440M2065
14208	36E01-241	36E36-238	60-42462-02	71C11A000	71L11A000	788A8B054	G53DBG-2	VR8204A2126	VR8440M2073
150103-26-01	36E01-243	36E36-244	60-42463-01-00	71C11C007	71L11C018	788C3C013	G53DBG-3	VR8204A2134	VR8440M2081
15691-497	36E01-244	36E36-245	60-42464-01-00	71C11C013	71M11A000	7C0AB0003	G54BBG-1	VR8204A2142	VR8440M2099
15691-498	36E01-245	36E36-254	6244870	71C11N522	71M11A010	7C0C3C017	G54BCG-1	VR8204A2167	VR844M1014
160-89461	36E01-248	36E36-255	65A142161	71C11R523	71N41C007	7D1D5B029	L37-849	VR8204A2175	VR844M1063
20691-011	36E01-305	36E36-303	65A842723	71D01B002	71P11A000	7D1E9C047	PP10085	VR8204C1084	VR844M1162
239-39759-01	36E01-307	36E36-304	65D340052	71D01B004	71P11A016	7D1E9C050	PP10086	VR8204M1091	VR844M1170
239-39759-02	36E01-308	36E36-305	670-368	71D01B005	71P11C013	7D2E9C050	V00719	VR8205A2008	VR844M1186
3452A	36E01-310	36E38-301	700-070	71D01B022	71P11C018	7E2D5B029	V8185A1001	VR8205A2016	VR844M1198
3453A	36E03-205	36E38-302	700-071	71D01B023	71S11A010	7E2E9C050	V8185A1019	VR8205A2024	VR844M1220
35482	36E03-206	41882	700-072	71D01B038	71S41A010	7E3E9C050	V8185A1035	VR8205A2032	VR844M1246
36071-02	36E03-209	42046	700-073	71D01D024	71S41A025	7E4D5B048	V8185B1009	VR8205A2073	VR844M1287
3644932	36E03-211	506300	700-077	71D01D029	71T01S019	7E4E9C050	V8185B1017	VR8440A2001	VR844M1295
3644981	36E03-215	511-044-367	720-070	71D01U039	71T01B004	7C4D5B030	V8247A1000	VR8440A2019	VR844M1303
3644982	36E03-217	511-044-381	720-071	71F11A000	71T01B019	7E4E9C047	V8247B1005	VR8440A2050	VR844R1005
36E01-103	36E03-224	59776A	720-072	71F11A003	71T01D031	7E3D5B-029	V8457A1026	VR8450A2076	VR844M1200
36E01-105	36E03-301	5H71911C	720-073	71F11A010	71U41L020	98204	V845A1018	VR8440A2084	VR8450A2109
36E01-106	36E36-1	5H71912C	720-080	71F11A022	71V11A000	98235	V845A1034	VR8440A2092	VR8450A2117
36E01-201	36E36-2	5H71931C	7100DE	71F11A040	71Y41C034	8071309	V845A1133	VR8440M2040	VR8450M2023
36E01-204	36E36-105	5H73205B1	7100DER-2	71F11A041	7200IIPER	810-0457	VR820A20021	VR8440A2118	VR8450M2064
36E01-205	36E36-106	5H73205B2	7100DER-3	71F11C007	7200PERLP	810-0464	VR820A20227	VR8440R6003	VR8450R6003
36E01-206	36E36-201	5H73206B	7100DER-4	71F11C013	7A5A8B004	9107100	VR820A20335	VR8440A2142	VR845M1013
36E01-221	36E36-210	5H73206B1	7100DER-6	71F11C018	7A5B3G006	93G5601	VR820A20403	VR8440M1000	VR844M1006
36E01-223	36E36-216	601011	71B11A000	71F11C042	7A5D0A023	95P46	VR820A20503	VR8440M2008	
36E01-225	36E36-220	601012	71B11A003	71F11T037	7A5D0E041	95P4601	VR820A20688	VR8440M2016	
36E01-226	36E36-227	601033	71B11A044	71H11A001	7A5D0D040	95P4601	VR820A20766	VR8440M2024	
36E01-227	36E36-230	601170	71B11C007	71H11C007	7A6A8B003	C64235-01	VR820A20848	VR8440M2032	
36E01-233	36E36-232	601230	71B11C013	71J11A000	7A6C3C017	CAEF26CK201	VR820A20922	VR8440M2040	

Universal Ignition Control Uni-Kits

These kits feature a flame sense circuit that will work equally well on a one rod (local sense) and/or two rod (remote sense) systems.

- Reduces service truck stock - freeing up valuable space and saving money.
- Includes vent damper adaptor assembly.
- Installs quickly with complete, detailed installation instructions.

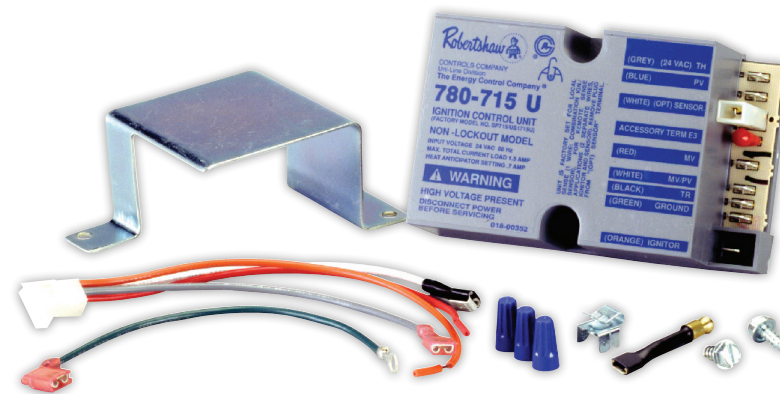

Uni-Line Part No.	Input Voltage	Transformer	Spark Rate	Pilot Valve, Main Valve	Combined Load	Flame Sense Current	Maximum Total Current Load	Flame Failure Reignition Time	Thermostat Anticipator Setting	Ambient Temperature	Operating Humidity
780-001 Nonlockout	24V AC to 50/60 Hz	24V AC / 20 VA	3 to 4 per second	1 amp at .5 PF	1.5 at .4 PF	.7 mA DC @ 25°C / 24V AC	1.5 amp	1.3 seconds maximum	.7 amp	-40 to 175°F (-40 to 80°C)	95% non-condensing at 104°F
780-002 Lockout	24V AC to 50/60 Hz	24V AC / 20 VA	4 to 15 per second	1 amp at .5 PF	1.5 at .4 PF	.7 mA DC @ 25°C / 24V AC	1.5 amp	1 seconds maximum	.7 amp	-40 to 175°F (-40 to 80°C)	95% non-condensing at 104°F
780-003 Lockout with Pre-Purge	24V AC to 50/60 Hz	24V AC / 20 VA	2 to 5 per second	1 amp at .5 PF	1.5 at .4 PF	.7 mA DC @ 25°C / 24V AC	1.5 amp	2 seconds maximum	.7 amp	-40 to 175°F (-40 to 80°C)	95% non-condensing at 104°F

Honeywell to Robertshaw Cross Reference

Honeywell	Robertshaw	Honeywell	Robertshaw	Honeywell	Robertshaw	Honeywell	Robertshaw	Honeywell	Robertshaw	Honeywell	Robertshaw
S86A1001	780-001	S86E1010	780-001	S86F1075	780-001	S86H1147	780-002	S8600H1089	780-002	S8610H1046	780-002
S86A1019	780-001	S86E1016	780-002	S86F1083	780-001	S86H1147	780-002	S8600H1097	780-002	S8610H1053	780-002
S86A1027	780-001	S86E1028	780-001	S86F1091	780-001	S8600C1000	780-003	S8600H1105	780-002	S8610H1061	780-002
S86A1035	780-001	S86E1036	780-001	S86G1008	780-002	S860D1009	780-003	S8600M1005	780-002	S8610H1079	780-002
S86B1009	780-001	S86E1044	780-001	S86G1016	780-002	S860D1017	780-003	S8600M1013	780-002	S8610M1003	780-002
S86B1017	780-001	S86E1051	780-001	S86G1024	780-002	S860A1001	780-002	S8610A1009	780-001	S8610M1011	780-002
S86B1025	780-001	S86E1069	780-001	S86G1032	780-002	S8600B1009	780-002	S8610B1007	780-002	S8610M1029	780-002
S86B1007	780-002	S86E1077	780-001	S86G1057	780-002	S8600C1015	780-002	S8610B1015	780-002	S8610U1003	780-002
S86B1015	780-002	S86E1101	780-001	S86G1073	780-002	S8600F1000	780-001	S8610C1005	780-002	S8620H1002	780-002
S86B1031	780-002	S86E1119	780-001	S86H1006	780-002	S8600F1034	780-001	S8610F1008	780-001	S8620H1028	780-003
S86C1023	780-002	S86E1127	780-001	S86H1047	780-002	S8600F1042	780-001	S8610F1016	780-001	S8660D1002	780-003
S86C1049	780-002	S86F1002	780-001	S86H1022	780-002	S8600H1006	780-002	S8610F1024	780-001	S8670D1000	780-003
S86C1056	780-002	S86F1018	780-001	S86H1048	780-002	S8600H1022	780-002	S8610F1032	780-001	S8670D1018	780-003
S86D1005	780-002	S86F1026	780-001	S86H1089	780-002	S8600H1048	780-002	S8610F1047	780-002	S8670E1007	780-003
S86D1031	780-002	S86F1042	780-001	S86H1097	780-002	S8600H1055	780-002	S8610H1012	780-002	S90A1005	780-001
S86D1021	780-002	S86F1059	780-001	S86H1105	780-002	S8600H1063	780-002	S8610H1020	780-002	S90B1003	780-002
S86E1002	780-001	S86F1067	780-001	S86H1113	780-002	S8600H1071	780-002	S8610H1038	780-002	S90B1011	780-002

† 15 seconds of lockout timing

Johnson Controls to Robertshaw Cross Reference

Johnson Controls	Robertshaw	Johnson Controls	Robertshaw	Johnson Controls	Robertshaw	Johnson Controls	Robertshaw	Johnson Controls	Robertshaw	Johnson Controls	Robertshaw
CSA35A-617R	780-001	G60CAG-8	780-002	G60QAG-3	780-002	G60RBG-3	780-001	G65DKM-1	780-002	G770MGA-1	780-002
CSA35A-618R	780-001	G60CAG-9	780-002	G60QAG-4	780-001	G60RBK-1	780-001	G65DLM-1	780-002	G770MGA-2	780-002
CSA42A-600R	780-001	G60CBG-1	780-001	G60QAK-1	780-002	G60RBK-2	780-001	G65QBM-1	780-002	G770MGA-3	780-002
CSA42A-601R	780-001	G60CBG-10	780-001	G60QBG-1	780-001	G60RCG-1	780-001	G65QBM-3	780-002	G770MGC-1	780-002
CSA42A-602R	780-001	G60CBG-11	780-001	G60QBG-2	780-001	G60RCG-2	780-001	G66AG-1	780-001	G770MGC-2	780-002
CSA42A-603R	780-001	G60CBG-12	780-001	G60QBG-3	780-001	G60RCJ-1	780-001	G66AG-2	780-001	G770MGC-3	780-002
CSA42A-604R	780-001	G60CBG-14	780-001	G60QBG-4	780-001	G60RDG-1	780-001	G66BG-1	780-001	G770MGC-4	780-002
CSA43A-600R	780-001	G60CBG-16	780-001	G60QBG-5	780-001	G60RDK-1	780-001	G66MG-1	780-002	G770MGC-5	780-002
CSA44A-600R	780-001	G60CBG-17	780-001	G60QBG-6	780-001	G60RGL-1	780-002	G66MG-2	780-002	G770MGC-6	780-002
CSA45A-601R	780-001	G60CBG-2	780-002	G60QBG-7	780-001	G60RHL-1	780-002	G66NG-1	780-002	G770MHA-1	780-002
CSA45A-602R	780-001	G60CBG-3	780-002	G60QBG-8	780-001	G60RHP-1	780-001	G670AW-1	780-002	G770MHA-2	780-002
CSA46A-600R	780-001	G60CBG-4	780-002	G60QBG-9	780-001	G60RPL-1	780-001	G670AW-2	780-002	G770MHC-1	780-003
CSA48A-600R	780-001	G60CBG-5	780-002	G60QBH-1	780-001	G60RSL-1	780-002	G67AG-10	780-002	G770NGA-1	780-002
CSA49A-600R	780-002	G60CBG-6	780-002	G60QBK-1	780-001	G60ZAG-1	780-002	G67AG-11	780-002	G770NGC-4	780-002
CSA49A-601R	780-002	G60CBG-7	780-002	G60QBK-2	780-002	G60ZAG-2	780-002	G67AG-3	780-002	G770NGC-5	780-002
CSA49A-605R	780-002	G60CBG-8	780-002	G60QBK-3	780-002	G65BBG-1	780-001	G67AG-4	780-002	G770NGC-6	780-002
CSA51A-601R	780-002	G60CBG-9	780-002	G60QBL-1	780-001	G65BBG-2	780-001	G67AG-7	780-002	G770NGC-7	780-002
CSA52A-600R	780-002	G60CCG-1	780-001	G60QBL-2	780-001	G65BBG-3	780-001	G67AG-8	780-002	G770NHA-1	780-002
G600AX-1	780-001	G60CPG-1	780-001	G600CG-1	780-002	G65BBG-4	780-001	G67AG-9	780-002	G770NHC-1	780-003
G600AX-2	780-002	G60DBG-1	780-001	G600CJ-1	780-001	G65BBG-5	780-001	G67BG-2	780-002	G770RGA-1	780-002
G600AX-3	780-002	G60DBG-2	780-001	G600CL-1	780-001	G65BBG-6	780-001	G67BG-3	780-002	G770RHA-1	780-002
G600AY-1	780-001	G60DCG-1	780-001	G600DG-1	780-001	G65BBG-7	780-001	G67BG-4	780-002	G770RHA-2	780-002
G600KX-1	780-002	G60DCG-2	780-001	G600FL-1	780-002	G65BBG-8	780-001	G67BG-5	780-002	G779LHA	780-002
G600LX-1	780-002	G60DCG-3	780-001	G600GH-1	780-002	G65BBM-1	780-001	G67KG-1	780-002	Y79ABC-1	780-002
G600LX-2	780-002	G60DCG-4	780-001	G600HL-1	780-002	G65BBM-2	780-001	G67LG-1	780-002	Y79ABC-2	780-002
G600LY-1	780-002	G60DGB-1	780-001	G600HL-2	780-002	G65BBM-3	780-001	G67MG-1	780-002	Y79ABC-3	780-002
G600MX-1	780-002	G60PAG-1	780-001	G600JL-1	780-002	G65BBM-4	780-001	G67MG-2	780-002	Y79ABC-4	780-002
G600NX-1	780-002	G60PAG-2	780-001	G600LG-1	780-001	G65BCG-1	780-001	G67MG-3	780-002	Y79ABC-5	780-002
G600RX-1	780-002	G60PAG-3	780-001	G600LK-1	780-002	G65BCM-1	780-001	G67MG-4	780-002	Y79ABC-6	780-002
G600AG-1	780-001	G60PAG-4	780-001	G600PL-1	780-001	G65BFG-1	780-001	G67NG-2	780-002	Y79ABC-7	780-002
G600AG-2	780-002	G60PAG-5	780-001	G600RH-1	780-002	G65BKG-1	780-001	G67NG-4	780-002	Y79ABD-1	780-002
G600AG-3	780-001	G60PAG-6	780-001	G600RH-2	780-002	G65BKG-2	780-001	G770KGA-1	780-002	Y79ABD-2	780-002
G600AG-4	780-001	G60PAJ-1	780-001	G600RH-3	780-002	G65BKG-3	780-001	G770KHA-1	780-002	Y798BA-1	780-002
G600AG-5	780-001	G60PAK-1	780-001	G600RL-1	780-002	G65BKM-1	780-001	G770KHA-2	780-002	Y798BA-2	780-002
G600AG-6	780-001	G60PAK-2	780-001	G600RL-2	780-001	G65BKM-2	780-001	G770LGA-1	780-002		
G600AG-7	780-002	G60PPH-1	780-002	G600RL-3	780-001	G65BKM-3	780-001	G770LGA-2	780-002		
G60CAG-1	780-002	G60PPH-2	780-002	G600SL-1	780-002	G65BLG-1	780-002	G770LGC-1	780-002		
G60CAG-2	780-002	G60PFL-1	780-002	G600TH-1	780-002	G65BLG-2	780-001	G770LGC-2	780-002		
G60CAG-3	780-002	G60PPQ-1	780-001	G600TL-1	780-002	G65DBM-1	780-002	G770LGC-3	780-002		
G60CAG-4	780-002	G60PML-1	780-002	G600UL-1	780-002	G65DBM-2	780-002	G770LGC-4	780-002		
G60CAG-5	780-001	G60PVL-1	780-002	G60RAG-1	780-001	G65DBM-3	780-002	G770LHA-1	780-002		
G60CAG-6	780-002	G60QAG-1	780-002	G60RBG-1	780-001	G65DCM-1	780-002	G770LHA-2	780-002		
G60CAG-7	780-002	G60QAG-2	780-001	G60RBG-2	780-001	G65DFM-1	780-002	G770LHC-1	780-003		





## Relax with Robertshaw®

For comfort and convenience, our Universal Fireplace Remote Control Kits are Simply the Right Choice™ to upgrade millivolt gas fireplaces. Kits include an easy-to-install receiver and remote control with childproof lockout feature.



**Model 55643**  
Convenient and economical remote turns fireplaces on/off from anywhere in the room.

**Model 55644**  
Feature-rich remote lets you program temperature settings and automatically turns fireplaces on/off without pushing a button!

Learn more about these great remote control kits from your Invensys Controls Wholesaler, your Sales Representative or view online at [www.Uni-Line.com](http://www.Uni-Line.com).

inven'sys  
Controls

191 E. North Avenue  
Carol Stream, Illinois 60188 USA  
Customer Service Telephone 1.800.304.6563  
Customer Service Facsimile 1.800.426.0804  
HVA/CustomerService@Invensys.com  
For Technical Service  
Telephone 1.800.463.8299  
Facsimile 1.630.260.7294  
TechnicalService@Invensys.com

Invensys™, Robertshaw® and Uni-Line® are trademarks of Invensys plc, its subsidiaries and/or affiliated companies. All other brands mentioned may be the trademarks of their respective owners.

[www.Uni-Line.com](http://www.Uni-Line.com)  
©2010 Invensys Controls  
3/10 - 150-2139D

## Ignitors

Robertshaw® Ignitors come in three styles to suit your application: Silicon Carbide, Silicon Nitride and Universal models.

Each provides an exact OEM replacement providing a simple selection of the correct product and fast installation. They deliver dependable ignition in heating systems of every description: furnaces, boilers, rooftop heaters, infrared burners, unit heaters, water heaters and many other types of HVAC equipment.

- Choose the **Universal Ignitors** as a perfect truck stock product so you always have the right ignitor for the job. Robertshaw Universal Ignitors replace 130 ignitors currently found in the field today.
- Select **Silicon Nitride Ignitors** to provide exceptional improvement in durability by virtually eliminating breakage as well as being resistant to contaminants and debris from the heating element.
- Use **Silicon Carbide Ignitors** as a more economical replacement ignitor that works equally well in all applications.

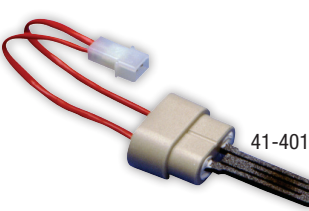

Ceramic Block Styles

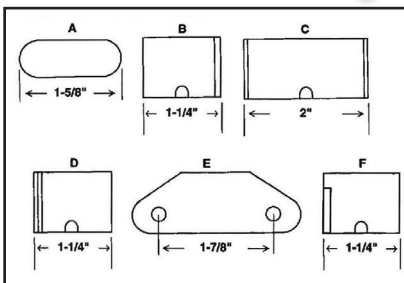

Terminal Block Styles

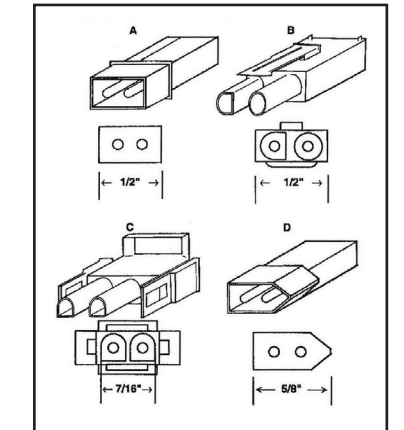

### Ordering Chart for Silicon Carbide and Silicon Nitride Ignitors

Uni-Line Part No.		Factory Model		Ceramic Block Style	Terminal Block Style	Lead Wire Length		OHMS	Comments	Time to Temp.
Carbide	Nitride	Carbide	Nitride			Carbide	Nitride			
<b>41-401</b>	<b>41-401N</b>	271A	SN005	A	A	4-1/2"	5-1/4"	40-75	Includes a gasket	17 sec
<b>41-402</b>	<b>41-402N</b>	271W	SN002	B	None	19"	24"	40-75		17 sec
<b>41-403</b>	<b>41-403N</b>	271M	SN001	C	None	5-1/2"	5-1/4"	40-75		17 sec
<b>41-404</b>	<b>41-404N</b>	271M	SN012	C	D	4-1/2"	5-3/4"	40-75	Includes special mounting	17 sec
<b>41-405</b>	<b>41-405N</b>	271D	SN004	D	None	5-1/2"	9"	40-75		17 sec
<b>41-406</b>	<b>41-406N</b>	271Y	SN006	E	None	10-1/2"	9"	40-75	Includes a gasket	17 sec
<b>41-407</b>	<b>41-407N</b>	271	SN010	C	B	4-1/2"	5-3/4"	40-75		17 sec
<b>41-408</b>	<b>41-408N</b>	271N	SN011	B	C	5"	5-3/4"	40-75		17 sec
<b>41-409</b>	<b>41-409N</b>	271	SN012	C	D	4-1/2"	5-3/4"	40-75		17 sec
<b>41-410</b>	<b>41-410N</b>	271N	SN013	B	B	4-1/2"	5-3/4"	40-75		17 sec
<b>41-411</b>	<b>41-411N</b>	271N	SN011	B	C	4-1/2"	5-3/4"	40-75	Includes special mounting	17 sec
<b>41-412</b>	<b>41-412N</b>	271NM	SN003	F	41-412 - D 41-412N - none	5-1/4"	24"	40-75		17 sec
<b>41-413</b>	<b>N/A</b>	201C	N/A		2" long by 1-3/8" dia.	1-3/8"	N/A	45-400		34 sec
<b>41-414</b>	<b>N/A</b>	271NM	N/A	F	D	5-1/4"	N/A	40-75	Includes special mounting	17 sec
<b>41-418</b>	<b>N/A</b>	271NM	N/A	B	C	5-1/4"	N/A	40-75	Includes bracket	17 sec

## Universal Ignitors

The new Robertshaw® Universal Ignitors are the perfect truck stock item so you always have the right ignitor. All universal ignitors replace over 130 ignitors currently found in the field. To allow for universal applications, mounting brackets and hardware are included. Robertshaw Universal Ignitors are recommended for operating voltage of 120V AC. We offer three models to fit your durability needs. The 41-802N is the best model available with the highest level of durability. The 41-801N offers medium durability and the 41-803 offers good durability.

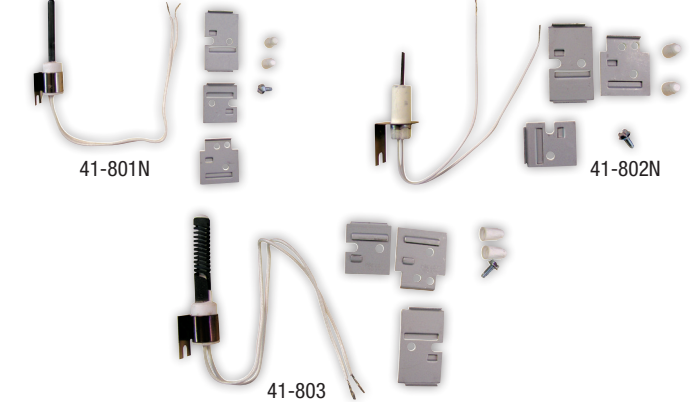

### Ordering Chart for Universal Ignitors

Uni-Line Part No.	Factory Model	Ceramic Length	OHMS	Comments	Time to Temperature	Warranty (years)
<b>41-801N</b>	CM067KU	1"	15 to 30	Silicon Nitride	17 seconds	2
<b>41-802N</b>	SN067KU	1-1/4"	36 to 64	Silicon Nitride	17 seconds	3
<b>41-803</b>	FC067KU	1"	50 to 1,100	Silicon Carbide	17 seconds	1

## Ignitor Cross Reference

OEM	OEM Part No.	Uni-Line Part No.		Exact or Functional	Universal Ignitor Replacement
		Carbide	Nitride		
Amana	10041601	41-401	41-401N	E	No
	10755002	41-402	41-402N	F	Yes
	B1336102	41-401	41-401N	F	No
	B138196P01	41-403	41-403N	F	Yes
	B144676P01	41-410	41-410N	E	Yes
	B144676P02	41-407	41-407N	F	Yes
	B340039P01	41-408	41-408N	F	Yes
	D99182	41-401	41-401N	E	No
American Standard	IGN0030	41-403	41-403N	F	Yes
American Water Heater	6901800	41-406	41-406N	F	No
	6903767	41-406	41-406N	F	No
	6903768	41-406	41-406N	F	No
	6905032	41-402	41-402N	F	Yes
	100-9980	41-402	41-402N	F	Yes
Arco Aire	1096048	41-414	N/A	E	No
Armstrong	38322B001	41-402	41-402N	F	Yes
Barnett Brass	661923	41-401	41-401N	E	No
	661924	41-403	41-403N	E	Yes
	661925	41-406	41-406N	E	No
	661926	41-407	41-407N	E	Yes
	661927	41-409	41-409N	E	Yes
	661928	41-411	41-411N	E	No
	87197	41-413	N/A	E	No
Carling	87197S	41-413	N/A	E	No

OEM	OEM Part No.	Uni-Line Part No.		Exact or Functional	Universal Ignitor Replacement
		Carbide	Nitride		
Carrier	LH332S001A	41-409	41-409N	E	Yes
	LH332S002	41-409	41-409N	F	Yes
	LH332S003	41-409	41-409N	F	Yes
	LH332S004	41-409	41-409N	F	Yes
Claire Brothers	C-238	41-402	41-402N	F	Yes
	C-242	41-402	41-402N	F	Yes
Coleman / Evcon	1474-051	41-402	41-402N	F	Yes
	1474-052	41-402	41-402N	F	Yes
Comfortmaker	1096048	41-414	N/A	E	No
Comfort Zone	1501140401	41-406	41-406N	F	No
	150114-04-01	41-406	41-406N	F	No
DMO Industries	98P78	41-402	41-402N	F	Yes
Ducane Heating Corp.	20015201	41-409	41-409N	F	Yes
Enerco	10399	41-402	41-402N	F	Yes
Ez Flow	62374	41-412	41-412N	F	No
Frigidaire	6320770	41-402	41-402N	F	Yes
	6320880	41-402	41-402N	F	Yes
	632-3540	41-402	41-402N	F	Yes
	RH622286893	41-402	41-402N	F	Yes
GE / Hotpoint	WG37X11	41-403	41-403N	F	Yes
	WG37X34	41-403	41-403N	F	Yes
	IG-106	41-406	41-406N	F	No
Gemline	IG-107	41-412	41-412N	F	No

OEM	OEM Part No.	Uni-Line Part No.		Exact or Functional	Universal Ignitor Replacement
		Carbide	Nitride		
Glow Core	1950001	41-406	41-406N	F	No
	FV 009	41-406	41-406N	F	No
	HSRK7	41-406	41-406N	F	No
Goodman Mfg.	B11726-06	41-402	41-402N	F	Yes
	B14010-1SS	41-414	N/A	F	No
	B1401009	41-412	41-412N	E	No
	B1401018	41-418	N/A	E	No
	ZCO-350	41-402	41-402N	F	Yes
Grimsby Stove	71082	41-412	41-412N	F	No
	86483	41-412	41-412N	F	No
HB Smith	9050	41-402	41-402N	F	Yes
	50018	41-405	41-405N	F	Yes
	101344	41-405	41-405N	F	Yes
	1148245	41-405	41-405N	F	Yes
	2400-048	41-401	41-401N	F	No
Heatmaker	2400-286	41-401	41-401N	F	No
	2600-359	41-401	41-401N	F	No
	3079-100	41-401	41-401N	F	No
	9330-102	41-401	41-401N	F	No
	1001344	41-405	41-405N	F	Yes
Heil Quaker	1009604	41-412	41-412N	F	No
	1096048	41-412	41-412N	F	No
	1148145	41-405	41-405N	F	Yes
	1009604	41-412	41-412N	E	No
	3280618	41-402	41-402N	F	Yes
Integra	6905032	41-402	41-402N	F	Yes
International Comfort Products	1096047	41-412	41-412N	F	No
Johnstone Supply	L37-698	41-401	41-401N	E	No
	L37-699	41-402	41-402N	E	Yes
	L37-700	41-403	41-403N	E	Yes
	L37-812	41-405	41-405N	E	Yes
	L37-813	41-406	41-406N	E	No
	L37-814	41-407	41-407N	E	Yes
	L37-815	41-408	41-408N	E	Yes
Lennox Industries	36N77	41-403	41-403N	E	Yes
	96P01	41-401	41-401N	E	No
	98P77	41-405	41-405N	E	Yes
	98P78	41-408	41-408N	E	Yes
	LCV727021G	41-406	41-406N	F	No
Majestic	PLJ2702	41-406	41-406N	F	No
	75-92-104	41-402	41-402N	F	Yes
	75-92-105	41-402	41-402N	F	Yes
Modine	SH75032A	41-418	N/A	E	No
	3200580	41-406	41-406N	F	No
	3200618	41-402	41-402N	F	Yes
Mor-Flo Industries	3210401	41-406	41-406N	F	No
	105141000	41-402	41-402N	F	Yes
Nordyne	632-0770	41-402	41-402N	F	Yes
	632-0880	41-402	41-402N	F	Yes

OEM	OEM Part No.	Uni-Line Part No.		Exact or Functional	Universal Ignitor Replaceme
		Carbide	Nitride		
Norton	201	41-403	41-403N	F	Yes
	271	41-403	41-403N	F	Yes
	271	41-409	41-409N	F	Yes
	201A	41-401	41-401N	F	No
	201B	41-406	41-406N	F	Yes
	201C	41-413	N/A	E	No
	201D	41-405	41-405N	F	Yes
	201J	41-406	41-406N	F	No
	201K	41-402	41-402N	F	Yes
	201L	41-402	41-402N	F	Yes
	201M	41-406	41-406N	E	No
	201N	41-402	41-402N	F	Yes
	201P	41-402	41-402N	F	Yes
	201R	41-402	41-402N	F	Yes
	201W	41-402	41-402N	F	Yes
	201Y	41-406	41-406N	F	No
	271A	41-401	41-401N	E	No
	271D	41-405	41-405N	F	Yes
	271M	41-403	41-403N	F	Yes
	271M	41-404	41-404N	F	Yes
	271M	41-407	41-407N	F	Yes
	271N	41-402	41-402N	F	Yes
	271N	41-408	41-408N	F	Yes
	271N	41-410	41-410N	F	Yes
	271N	41-411	41-411N	F	No
	271NM	41-412	41-412N	F	No
	271NM	41-418	N/A	E	No
271NM	41-414	N/A	F	No	
271P	41-405	41-405N	F	Yes	
271W	41-402	41-402N	F	Yes	
271Y	41-406	41-406N	F	No	
Olsen Ind.	26789	41-402	41-402N	F	Yes
Perfection Schwank	108803-G1	41-406	41-406N	F	No
Raytheon	D9918202A	41-401	41-401N	E	No
Raypak Inc.	50015	41-403	41-403N	F	Yes
	600915	41-403	41-403N	F	Yes
Rheem	90434300	41-409	41-409N	F	Yes
	62-22441-01	41-402	41-402N	F	Yes
	62-22441-01	41-408	41-408N	E	Yes
	62-22868-93	41-408	41-408N	F	Yes
	62-22868-82	41-411	41-411N	E	No
Roberts Gordon Appl.	90436600	41-402	41-402N	F	Yes
	1380654	41-403	41-403N	F	Yes
Snyder General	1380672	41-409	41-409N	F	Yes
	1380680	41-409	41-409N	E	Yes