

Description

The Daikin Premium Air Cleaner is an in-line air cleaner that treats home air for airborne particulate matter found in the home. The high efficiency MERV 15 media filter removes more than 85% of particles down to 0.3 microns in size at 492 fpm.

- Intuitively designed with outer dimensions that match original equipment furnace and air handler cabinets for quick installation

Standard Features

- Magnetic door design ensures tool-less, easy access to filter components for quick and easy filter changes
- Insulated cabinet to reduce risk of condensation.
- The new Daikin Premium Air Cleaner is a MERV 15 media filter that removes more than 85% of particles down to 0.3 microns*
- Pleated media filter removes over 98% of *Aspergillus fumigatus*, *Aspergillus versicolor*, and *Stachybotrys chartarum* from the airstream*
- Pleated media filter removes over 99% of Ragweed, over 72% of Cat Dander, and over 73% of Dust Mites from the airstream*
- Extra deep, 5¼" pleated filter constructed of cellulose-free, hydrophobic polyolefin fibers
- Designed for multi-position horizontal or vertical installations
- Filter design features a structured density gradient for sustained efficiency over the life of the filter
- Filter has a tight cabinet fit ensuring negligible air bypass
- Filter frame designed with dual pull tabs for easy removal
- Fully gasketed door for proper air seal
- Heavy duty, 20 gauge, post-forming painted, corrosion-resistant door
- All cabinet mounting holes are slotted and designed to line-up with original equipment flanges for time-saving installation
- Filter should be changed once or twice a year based on conditions within the home

* Independent testing performed by LMS Technologies, Inc.



	Furnaces	Air Handlers
Air Cleaner Model #	DV15-2814-FA	DV15-2117-AB
	DV15-2817-FB	DV15-2121-AC
	DV15-2821-FC	DV15-2124-AD
	DV15-2824-FD	



* Complete warranty details available from your local dealer or at www.daikincomfort.com. To receive the 12-Year Parts Limited Warranty, online registration must be completed within 60 days of installation. Online registration is not a requirement in California or Quebec.

Specifications							
MODEL	DV15-2117-AB	DV15-2121-AC	DV15-2124-AD	DV15-2814-FA	DV15-2817-FB	DV15-2821-FC	DV15-2824-FD
Airflow - up to maximum rated flow	Up to 1200 cfm (2039 m³/h)	Up to 1600 cfm (2718 m³/h)	Up to 1800 cfm (3058 m³/h)	Up to 1200 cfm (2039 m³/h)	Up to 1600 cfm (2718 m³/h)	Up to 2000 cfm (3398 m³/h)	Up to 2000 cfm (3398 m³/h)
Duct Size	21 x 17 in (53 x 43 cm)	21 x 21 in (53 x 53 cm)	21 x 24 in (53 x 61 cm)	28 x 14 in (71 x 36 cm)	28 x 17 in (71 x 43 cm)	28 x 21 in (71 x 53 cm)	28 x 24 in (71 x 61 cm)
Pressure Drop* (Filter Only)	0.09 in. w.g. @ 600 cfm	0.09 in. w.g. @ 800 cfm	0.09 in. w.g. @ 900 cfm	0.08 in. w.g. @ 600 cfm	0.08 in. w.g. @ 800 cfm	0.08 in. w.g. @ 1000 cfm	0.06 in. w.g. @ 1000 cfm
	0.26 in. w.g. @ 1200 cfm	0.29 in. w.g. @ 1600 cfm	0.25 in. w.g. @ 1800 cfm	0.25 in. w.g. @ 1200 cfm	0.24 in. w.g. @ 1600 cfm	0.22 in. w.g. @ 2000 cfm	0.17 in. w.g. @ 2000 cfm
MERV Rating*	15	15	15	15	15	15	15

Notes:

1. Installation with units with ECM motors recommended.
2. Two filters should be considered for any airflow rates above maximum rated flow or when duct pressure loss is excessive.

Furnace Size	A	B	C	D
Furnace Riser	AMP-BSRB-2814	AMP-BSRB-2817	AMP-BSRB-2821	AMP-BSRB-2824

When using a furnace riser use DV15-2824-FD on all size furnaces

MERV Rating 15 - Minimum Filtration Efficiency @492 fpm: • E1 85% (0.3 - 1.0 micron) • E2 90% (1.0 - 3.0 micron) • E3 95% (3.0 - 10.0 micron)

*Independent testing performed by LMS Technologies, Inc.



Furnace Riser

Dimensions (in)								
MODEL	A	B1	B2	C	D	E	F	G
DV15-2117-AB	17.5	21.1	21.7	1.4	0.8	1.3	14.7	19.4
DV15-2121-AC	21.0	21.1	21.7	1.4	0.8	1.3	18.2	19.4
DV15-2124-AD	24.5	21.1	21.7	1.4	0.8	1.3	21.7	19.4
DV15-2814-FA	14.0	28.0	28.6	0.8	0.8	3.8	12.5	23.9
DV15-2817-FB	17.5	28.0	28.6	0.8	0.8	3.8	16.0	23.9
DV15-2821-FC	21.0	28.0	28.6	0.8	0.8	3.8	19.5	23.9
DV15-2824-FD	24.5	28.0	28.6	0.8	0.8	3.8	23.0	23.9

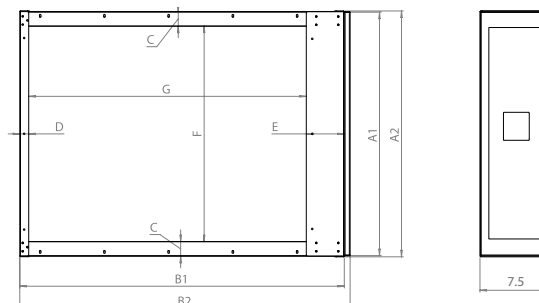

Replacement Media Filters

Air Cleaner Model ⁽¹⁾	Replacement Filter Part ⁽²⁾
DV15-2117-AB	0160M00013
DV15-2121-AC	0160M00014
DV15-2124-AD	0160M00015
DV15-2814-FA	0160M00016
DV15-2817-FB	0160M00017
DV15-2821-FC	0160M00018
DV15-2824-FD	0160M00019

Filter should be changed once or twice a year based on conditions within the home.

⁽¹⁾EPA EST. NO. 073316-TEX-001 • ⁽²⁾EPA EST. NO. 71027-MEX-001

Filter Match-up Options

Air Handler Filter Options		
Air Handler Size	Bottom/Top Return	Plenum Return
B	21x17	21x21
C	21x21	21x24
D	21x24	21x24

Furnace Filter Options			
Furnace Size	Bottom/Top Return	Side Return	Side Return with Furnace Riser
A	28x14	28x17	28x24
B	28x17	28x17	28x24
C	28x21	(2) 28x17	28x24
D	28x24	(2) 28x17	28x24

NOTE: Not all installation options are included below.

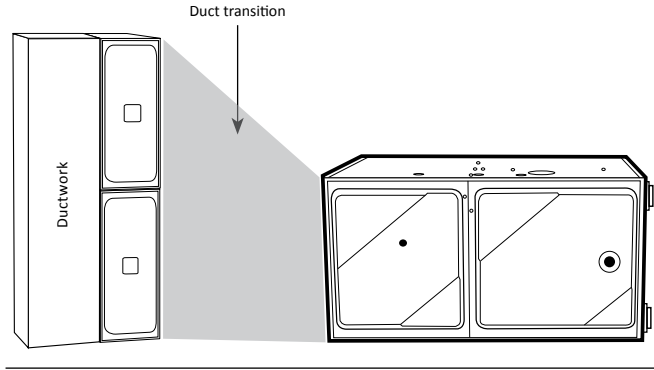

**Duct transition for side flow dual filter installation
furnace/air handler application**

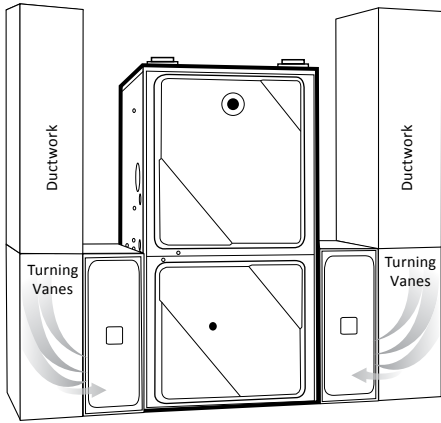

Dual filter furnace application, side return
(For any side return on a furnace
without a furnace riser, use one
DV15-2817-FB on A & B or two
DV15-2817-FB on C & D furnace sizes)

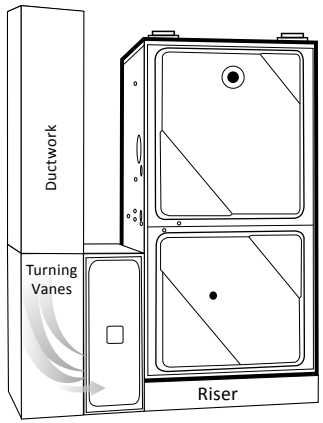

**Single filter furnace application, side return
with furnace riser (When using a furnace riser,
use DV15-2824-FD on all furnace sizes)**



Furnace Riser

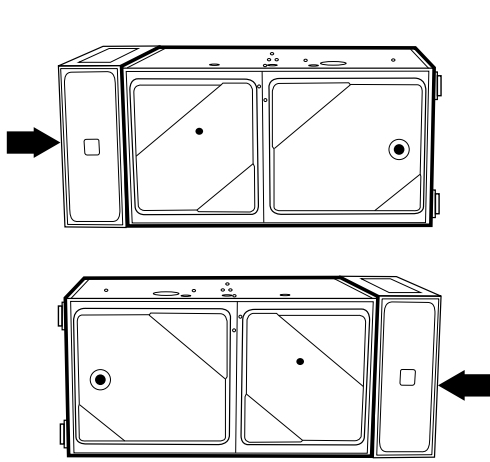

HL/HR furnace/airhandler application

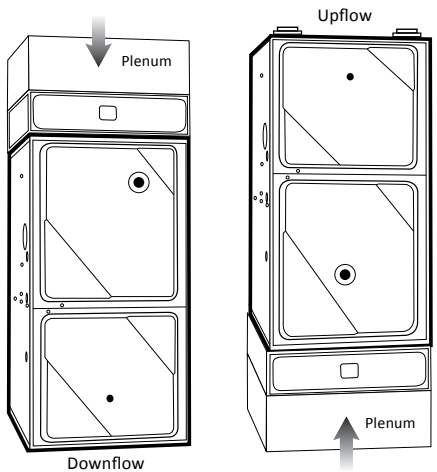

**Upflow/downflow
furnace/airhandler application**

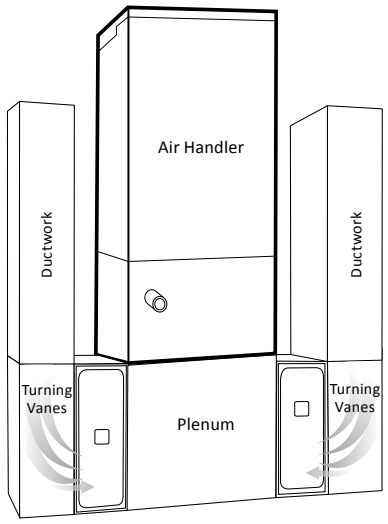

Dual filter air handler application

Daikin North America LLC reserves the right to discontinue or change at any time, specifications or designs without notice or without incurring obligations. Performance of the Air Cleaners will depend on house plan design, duct design and heating/cooling equipment.