



Remote Control and Receiver Module

INSTALLATION / USER'S MANUAL

FOR MODELS

PTAC49CH3ZC
PTAC412HP3ZC

PTAC49HP3ZC
PTAC415CH3ZC

PTAC412CH3ZC
PTAC415HP3ZC

PTAC49CH3VC
PTAC412HP3VC

PTAC49HP3VC
PTAC415CH3VC

PTAC412CH3VC
PTAC415HP3VC

Please read carefully before installing or operating. Retain this manual for future reference.

CONTENTS

INSTRUCTION.....	1
INSTALLATION PROCEDURE.....	1
REMOTE CONTROL OPERATION.....	3
STAR-UP GUIDE.....	5
OTHER FEATURE.....	5
WARRANTY.....	6
TECHNICAL ASSISTANCE.....	6

INSTRUCTION

This Manual provides information for ease of installation and operation of the receiver module and remote control.

Keep these instructions for future reference.

CONTENTS



REMOTE CONTROL

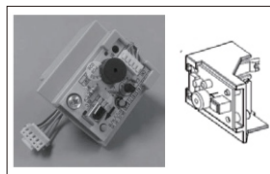

RECEIVER MODULE

WARNING

DISCONNECT ALL ELECTRICAL POWER TO UNIT BEFORE INSTALLING THE RECEIVER MODULE. FAILURE TO DO SO MAY CAUSE PROPERTY DAMAGE, PERSONAL INJURY OR DEATH.

INSTALLATION PROCEDURE

Step 1: Remove front panel from PTAC unit by pulling the panel out at the bottom ① and then lift up ②.

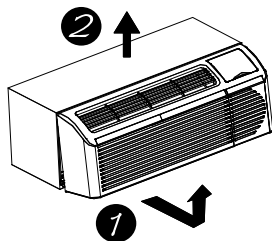

Step 2: Locate the receiver module mounting holes and electrical connector on the front plate of the electrical box.

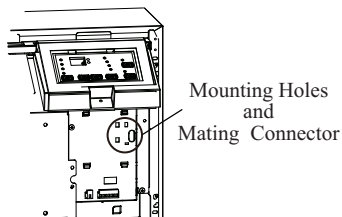

Step 3: Place the Receiver wires in the strain relief notch on the back of the module.



Receiver Module

Step 4: Insert receiver connector to mating connector.

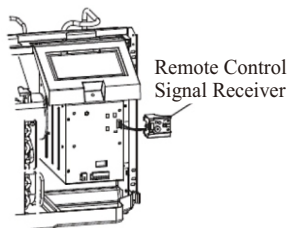

Step 5: Attached the Receiver module by inserting the three mounting legs into the corresponding holes on the electrical control box. Verify the electrical wires remain in strain relief notch.

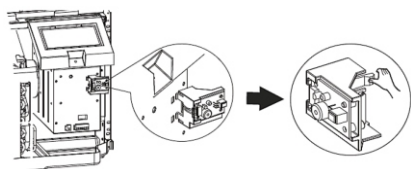

Step 6: Replace front panel on PTAC unit by lining up tabs on top of the unit ①. Then swing the front panel down and inward until it snaps into place ②.

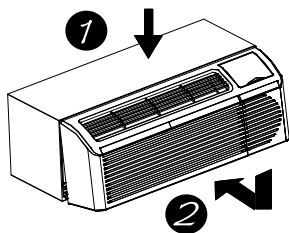

Step 7: Installation is completed. Plug in unit and energize the PTAC unit. The remote Control is ready for operating. (No additional configuration or setup is required).

REMOTE CONTROL OPERATION

NOTE: Be sure there is no obstruction between receiver and remote control. Do not drop or throw the remote control. Do not let any liquid in the remote control and put the remote control directly under the sunlight or any place where is very hot.

BUTTONS AND FUNCTIONS OF REMOTE CONTROL

Not All Features Are Activated

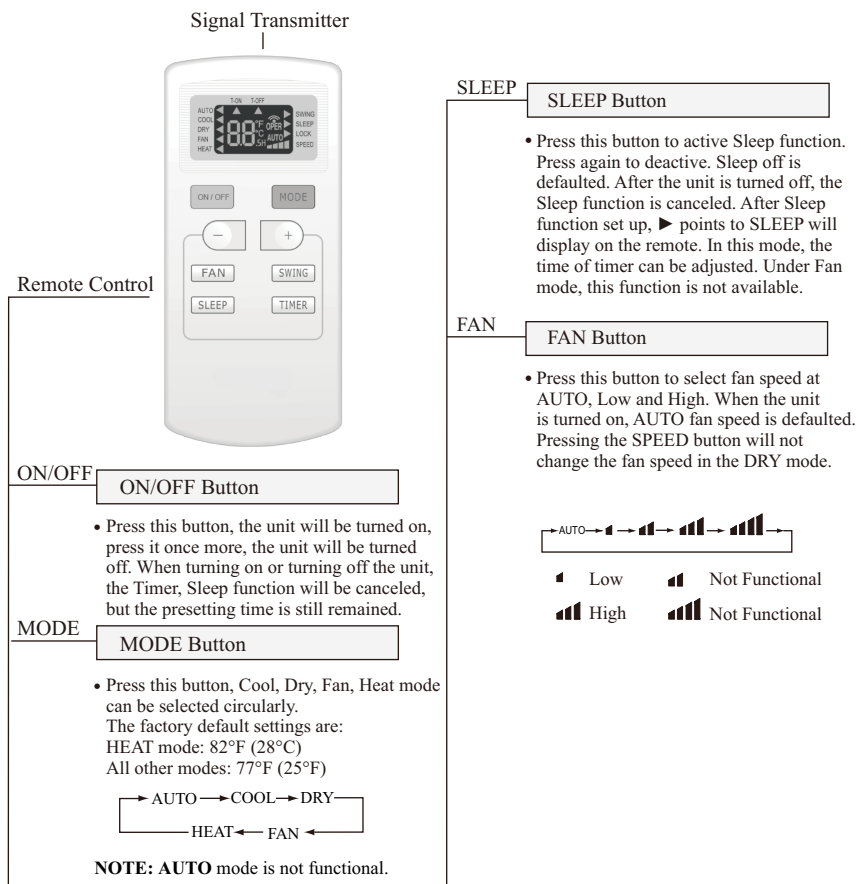

REMOTE CONTROL OPERATION

BUTTONS AND FUNCTIONS OF REMOTE CONTROL

Not All Features Are Activated

Remote Control



+

+ Button

- For presetting temperature increasing. Press this button to raise the temperature, when unit is on. Hold this button for more 2 seconds to decrease the temperature quickly before releasing the button
Fahrenheit setting range: 61-68 °F
Celsius setting range: 16-30 °C.

-

- Button

- Presetting temperature can be decreased. Press this button to lower the temperature, when unit is on. Hold this button for more 2 seconds to decrease the temperature quickly before releasing the button.
Fahrenheit setting range: 61-68 °F
Celsius setting range: 16-30 °C.

TIMER

TIMER Button

- Press the TIMER button while the unit off. Selecting the setting hours 0.5 - 24 will turn the unit on after the selected hours have expired. The characters "T-ON" and "H" will flash for 5 seconds after pressing this button. Press "+" or "-" to increase or decrease the time in 5 seconds. Time changes 0.5 hour for each press. Hold the "+" or "-" button to change the time setting rapidly, the setting time will be displayed for 2 seconds and then back to the preset temperature. Press the TIMER button in 2 seconds while setting, the timer function will be canceled.
Press the TIMER button again after setting to inquire the remaining setting time for auto switch-on.
Press the NO/OFF button to cancel the timer setting and turn on the unit directly.
- Press the TIMER button while the unit on. Selecting the setting hours 0.5 - 24 will turn the unit off after the selected hours have expired. The characters "T-ON" and "H" will flash for 5 seconds after pressing this button. Press "+" or "-" to increase or decrease the time in 5 seconds. Time changes 0.5 hour for each press. Hold the "+" or "-" button to change the time setting rapidly, the setting time will be displayed for 2 seconds and then back to the preset temperature. Press the TIMER button in 2 seconds while setting, the timer function will be canceled.
Press the TIMER button again after setting to inquire the remaining setting time for auto switch-off.
Press the NO/OFF button to cancel the timer setting and turn off the unit directly.

START-UP GUIDE

1. Energize the unit, and then press ON/OFF button to turn on the unit.
2. Press MODE button to select the running mode (Cool, Dry, Fan or Heat).
3. Press + or - button to set the desired temperature.
4. Press FAN button to select the fan speed (High, Low or Auto).

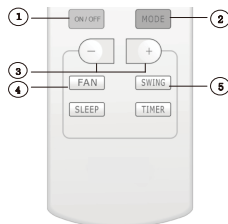

1. Press SLEEP button to select the sleep function.
2. Press Timer button to active Timer On or Timer Off function.

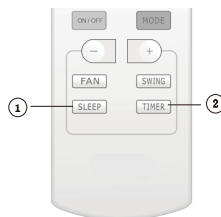

OTHER FEATURES

Lock Keypad

Hold the "+" and "-" buttons simultaneously for 2 seconds to lock the key pad. When the key pad is locked the mode, temperature set point and other settings are fixed as selected.

°F or °C

Turn unit off, press "MODE" and "-" buttons simultaneously to switch °C or °F

CHANGING BATTERIES AND NOTICES

1. Carefully press the locking tap down to remove the battery cover.
2. Remove old batteries and dispose of properly.
3. Insert two new AAA 1.5V batteries into remote control, paying attention to the polarity
4. Re-attach battery cover on the remote control.

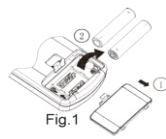

Fig.1



Note:

Do not use the old, different, or rechargeable batteries.

If the remote control will not be used for a long period of time, remove the batteries.

The remote control will operate the unit from a distance of up to 25 ft. (7.6m) as long as there is no obstruction. This is one-way communication only (from the remote control to unit).

If the remote control does not operate properly, remove the batteries for 30 seconds and re-install (resets the remote).

WARRANTY

International Refrigeration Products Inc. warrants that the product supplied is free from defects in material and workmanship. This warranty is valid as long as this product is properly handled, installed, operated, and serviced in accordance with the Installation and Operating Instructions shipped with this unit, and the warranty is completed and mailed no later than 30 days after date of purchase. All warranty claims must be made within one (1) year (five (5) years for compressor) from date of purchase (unless national regulations require a longer registration period).

This warranty provides free replacement of defective parts only. **Labor is not covered under this warrant. Replacement as a result of normal wear and tear is not covered under this warranty.**

Additional claims are excluded, unless required by national regulations.

International Refrigeration Products Inc. is not responsible for incidental, consequential, direct or indirect damages, or expenses relating to the use of, or the inability to use the product for any purpose. Other implied warranties are excluded.

This constitutes International Refrigeration Product Inc.'s warranty obligation and replaces any and all prior warranties for this product.

International Refrigeration Products Inc.

1035 Wheeler Way

Langhorne, PA 19047

Hours: 8:00 AM to 4:30 PM EST

Service Numbers: Tel: +1 (215) 750-9876

Fax: +1 (215) 750-1169