

FLOW RIGHT™ FILTER CABINETS

Ready-To-Assemble filter boxes

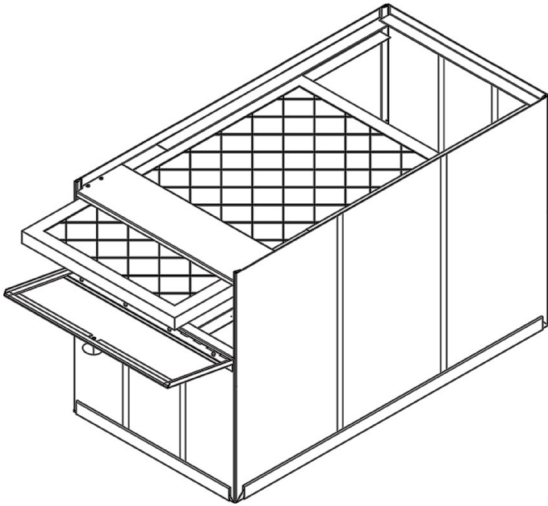

General

Improve your indoor air quality and extend the life of your heating and cooling system with Flow Right™ Filter Cabinets and air quality products.

Our Filter Boxes enhance efficiency, reduce strain on your furnace, and boost performance. Flow Right products offer top-notch quality, cost-effectiveness, and performance.

Features

- Ships in flat carton for easy storage
- Ready-to-assemble (RTA) design allows fast setup
- Improves airflow and enhances equipment efficiency
- Easily adjusts from 4" to 18" in height
- May be used as a booster box without the filter door
- Available in standard galvanized

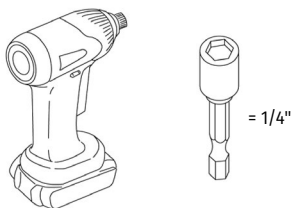

Tools Needed for Assembly

Optional Helpful Tools

- Caulking gun
- Tube of silicone
- Safety gloves

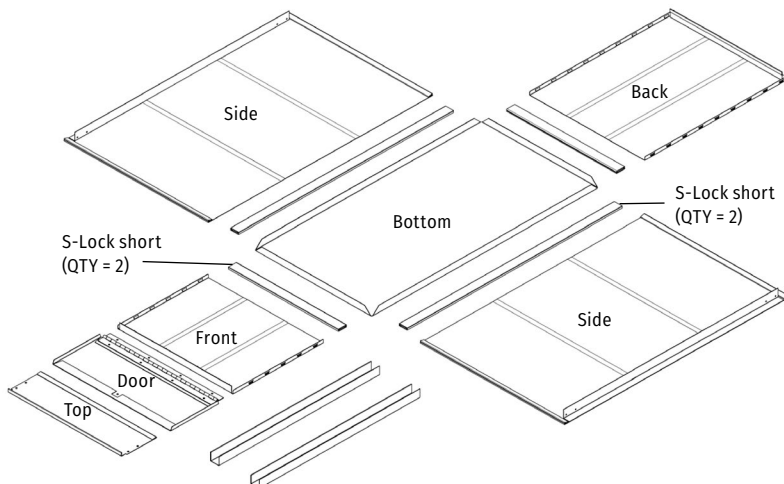

Parts

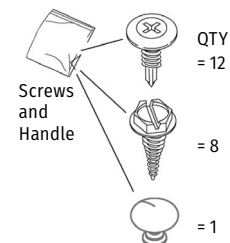

FLOW RIGHT™ FILTER CABINETS

Installation Manual

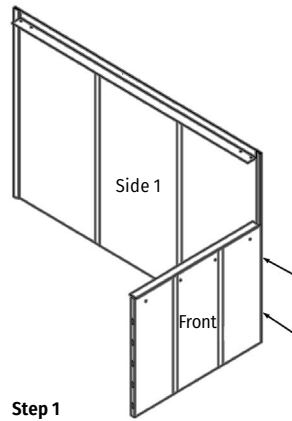

Step 1

Snap Front panel into the end of Side panel 1 with furnace support facing up as shown.

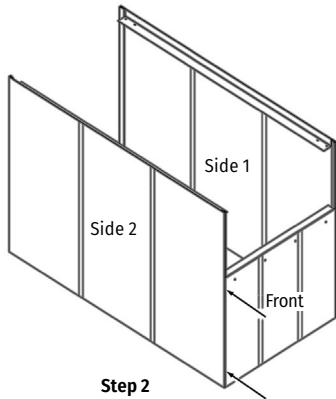

Step 2

Snap Front panel into the end of Side panel 2 with furnace support facing up as shown.

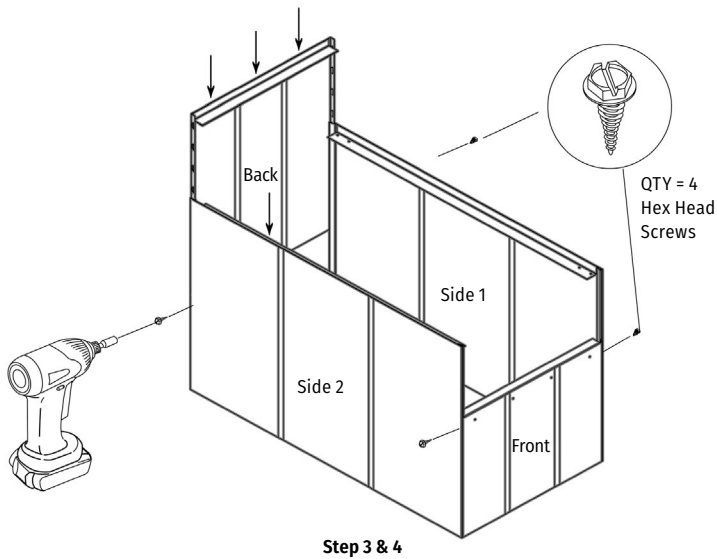

Step 3

Snap Back panel into the end of Side panel 1 and 2 with furnace support facing up and slide down as shown.

Step 4

Ensure the bottom edges are even and all sides are aligned, then drill (4) hex head screws into the Side panels at the locations indicated.

FLOW RIGHT™ FILTER CABINETS

Installation Manual

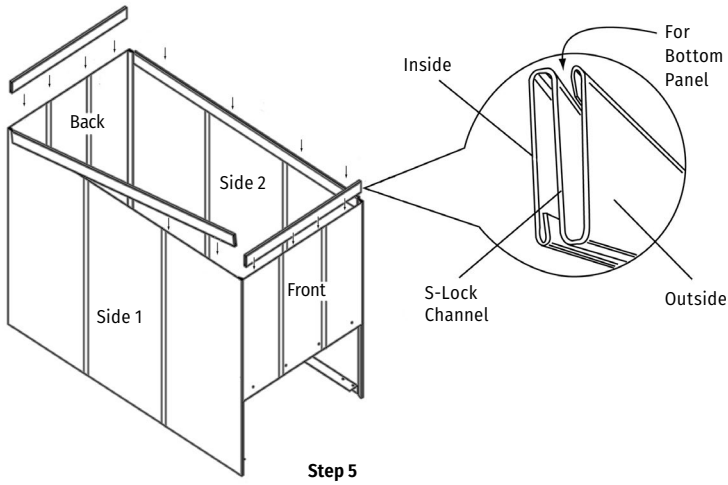

Step 5

Place the box upside down and slide the short S-Locks onto the bottom edges of the Front and Back panels. Slide the long S-Locks onto the bottom edges of the Side panels while ensuring the open S-Lock Channels are on the outside of each panel, as shown.

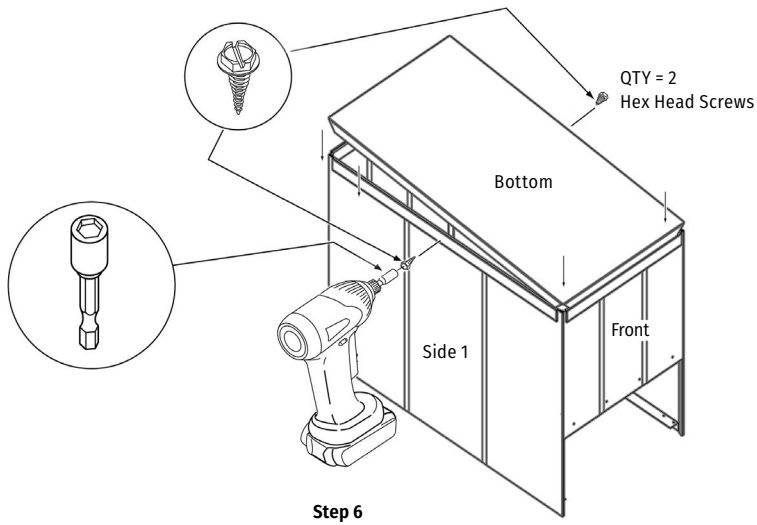

Step 6

Insert the Bottom panel into each of the (4) S-Lock Channels. Once the Bottom panel has been pushed down into place, drill (2) hex head screws into the middle of the long S-Locks as indicated.

IMPORTANT: If the box needs to be cut down, please do so prior to beginning Step 6.

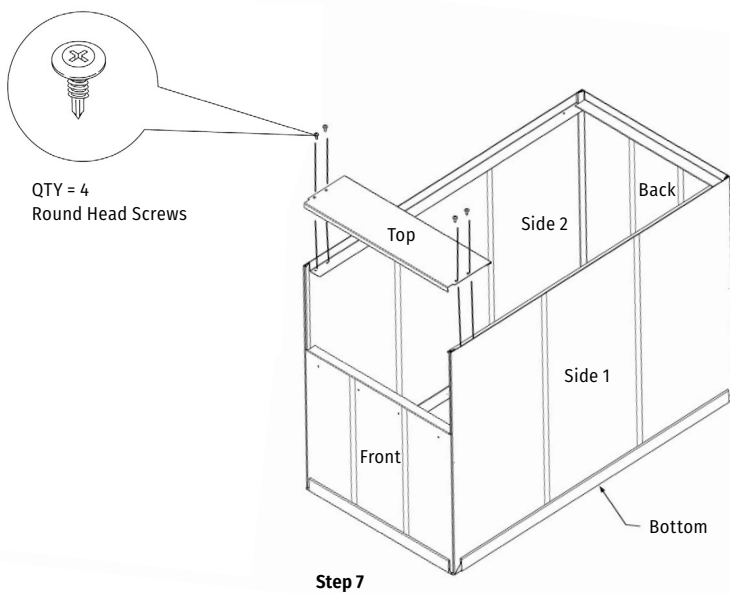

Step 7

Place the box upright, align the assembly holes on the Top panel with those on the Side panels, and secure with (4) round head screws as shown.

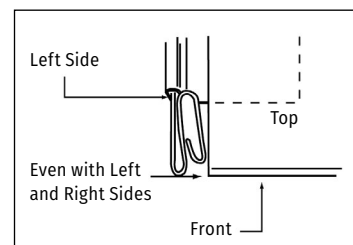

FLOW RIGHT™ FILTER CABINETS

Installation Manual

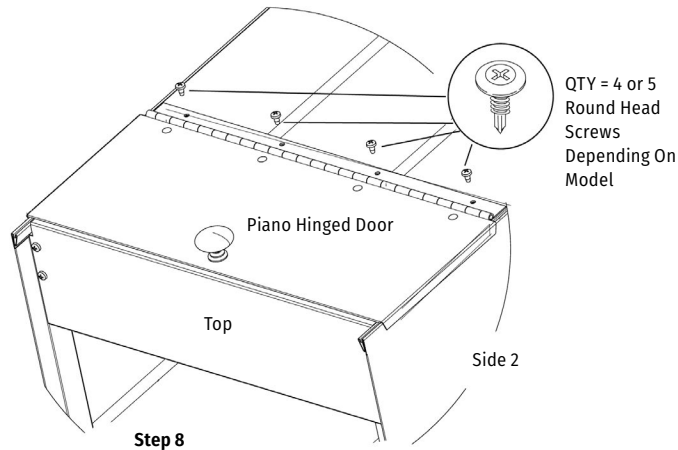

Step 8

Place the box on its back, align the assembly holes on the piano hinge with those on the Front panel, and secure with (4) or (5) round head screws as shown. Then secure the knob handle to the Piano Hinged Door via the assembly hole on the Door and screw included within the handle.

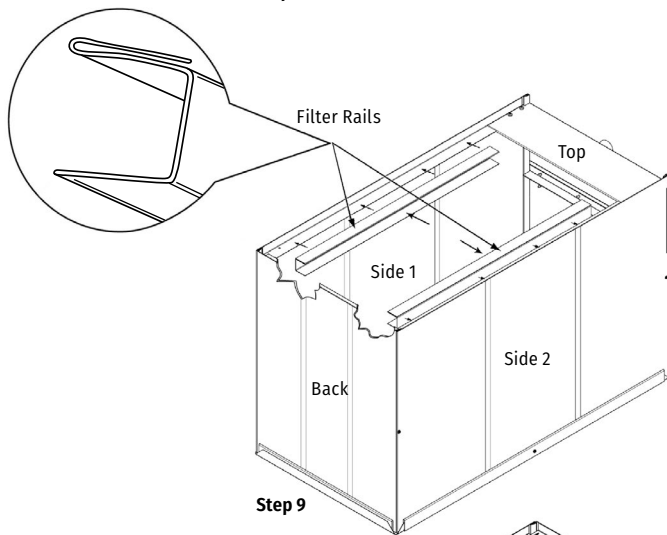

Step 9

Slide the (2) Filter Rails onto the filter box furnace supports on the Side panels, and then slide them all the way back so they are secured between the furnace supports on the Back panel and Side panels.

⚠ ATTENTION

Do not use screws to fasten the filter rails.

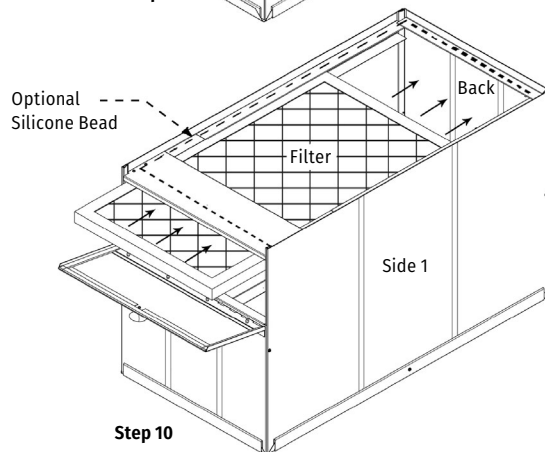

Step 10

Your Flow Right Filter Box is now fully assembled and ready for a filter and your furnace.

IMPORTANT: Side panels 1, 2, or the back panel may be cut to attach the return air duct.

Limited Warranty



For more information on our product limited warranty, visit RectorSeal.com

Manufactured by

RectorSeal, LLC

2601 Spenwick Drive, Houston, TX 77055, USA • 800-231-3345 • Fax 800-441-0051 • rectorseal.com

A CSW Industrials Company. RectorSeal, the logos and other trademarks are property of RectorSeal, LLC, its affiliates or its licensors and are protected by copyright, trademark and other intellectual property laws, and may not be used without permission. RectorSeal reserves the right to change specifications without prior notice. ©2025 RectorSeal. All rights reserved. R51227-0225