

ADC 10 SHUT-OFF DAMPER W MOTOR

Item no. **44691**

Document type: **Product card**
 Document date: **2017-02-16**
 Generated by: **Systemair Online Catalogue**

Description

Shut-off damper ADC is a 2-position, motorized damper without end switch. The damper is powered open with 24V AC, and is normally closed with spring return. Power supply wiring is connected to the lead wires attached to the damper motor. Positive closure is provided by a tight seal.



Technical parameters

Duct connection, Ø (inches)	10"
Weight	5 lbs.

Dimensions

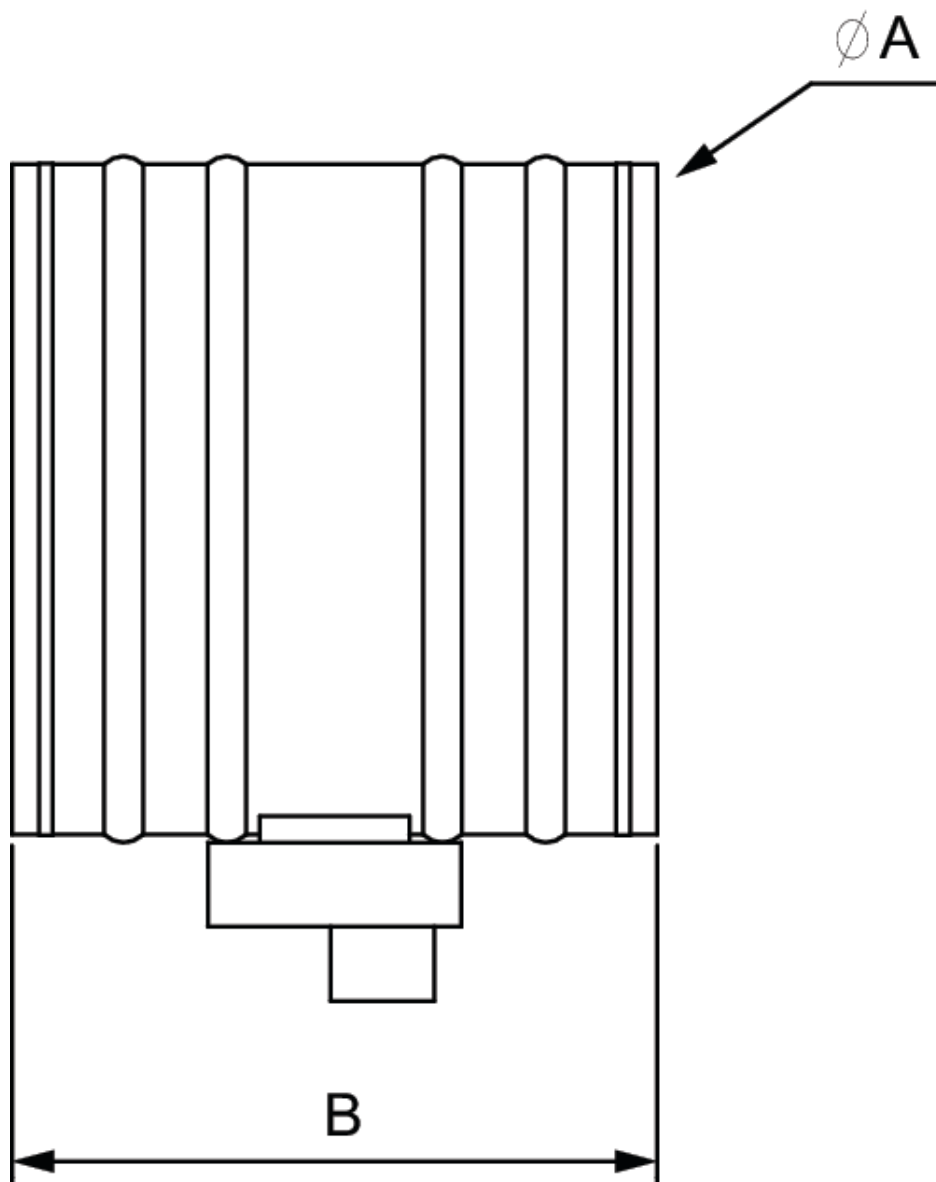

Model name	A	B
ADC 4	4 (102)	10 (254)
ADC 6	6 (152)	10 (254)
ADC 8	8 (203)	10 (254)
ADC 10	10 (254)	10 (254)
ADC 12	12 (305)	12 (305)
ADC 16	14 (356)	14 (356)

Dimensions in inches (mm)

Wiring

Motorized Damper

