

FORD DUAL CHECK VALVE REPAIR KIT FIELD INSTRUCTIONS

Refer to the Ford® website (www.fordmeterbox.com) for additional and most recent installation instructions and product information.

1. Locate the stamped model number on the valve body, and reference the most recent version of Ford® Catalog Section I under "Check Valve Repair Kits" to ensure your repair kit is correct.
2. Shut off the inlet water supply going to the Dual Check Valve and shut off or drain the house side water supply.
3. Carefully remove the access cap as the internal parts are spring loaded. Remove internal parts.
4. Inspect the check valve brass seats in the valve body for signs of wear or corrosion. If the seats are worn and provide a rough sealing surface, replace the entire valve.
5. Reassemble the Dual Check Valve by following the assembly instructions #6 through #12. (Refer to diagram on reverse side of card)
6. Remove O-ring from access cap and replace with the new O-ring (7). If valve has flat rubber washer in the access cap, remove and discard.
7. Install Rubber Damper (8) over the access cap stem housing and make sure it fits squarely against the base of the access cap.

- Instructions continued on reverse side -



The Ford Meter Box Company, Inc.

P.O. Box 443, Wabash, Indiana, USA 46992-0443

Telephone: 260-563-3171 FAX: 800-826-3487 Overseas FAX: 260-563-0167

www.fordmeterbox.com

#020275

08/22

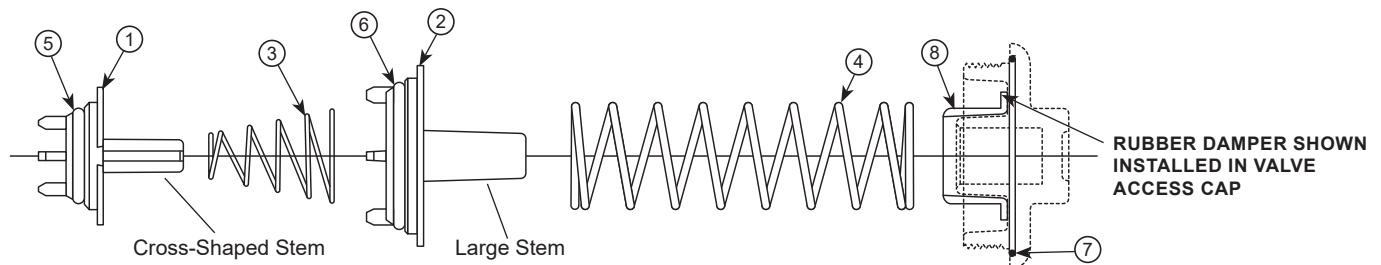

ITEM	DESCRIPTION
1	Small Stem
2	Large Stem

ITEM	DESCRIPTION
3	Small Spring
4	Large Spring

ITEM	DESCRIPTION
5	"O" - Ring
6	"O" - Ring

ITEM	DESCRIPTION
7	"O" - Ring
8	Rubber Damper

8. Position springs as shown in drawing. The straight large spring (4) must fit into the spring groove of the large stem (2). The large spring (4) must also fit squarely against the rubber damper (8) in the access cap. Large spring coils should not catch on the leading edge of the rubber damper when compressed.
9. The large end of the small conical spring (3) must fit inside the large stem guides (2), and the small end of the conical spring fits over the stem of the small check stem (1).
10. The Cross-Shaped Stem of the small check stem (1) must be aligned with the receiver of the large check stem (2) when the check stems are installed in the valve body. Rotate the Large Stem very slightly to insure the large check stem's receiver will slide over the small check stem during assembly.
11. Compress the large spring with the access cap and tighten the cap into the valve body.
12. Turn on the inlet water supply and insure the access cap is water tight.



The Ford Meter Box Company, Inc.

P.O. Box 443, Wabash, Indiana, USA 46992-0443

Telephone: 260-563-3171 FAX: 800-826-3487 Overseas FAX: 260-563-0167

www.fordmeterbox.com

#020275

08/22