



www.Source1Parts.com

# GM8S SERIES - 80% DOWNFLOW/HORIZONTAL NATURAL GAS FURNACES (STYLE C, SOME B) INCLUDES LO-NOX MODELS LM8S

HVAC SERVICE PARTS

Supersedes: Nothing

035-21291-001 Rev. A (1206)

1 of 8

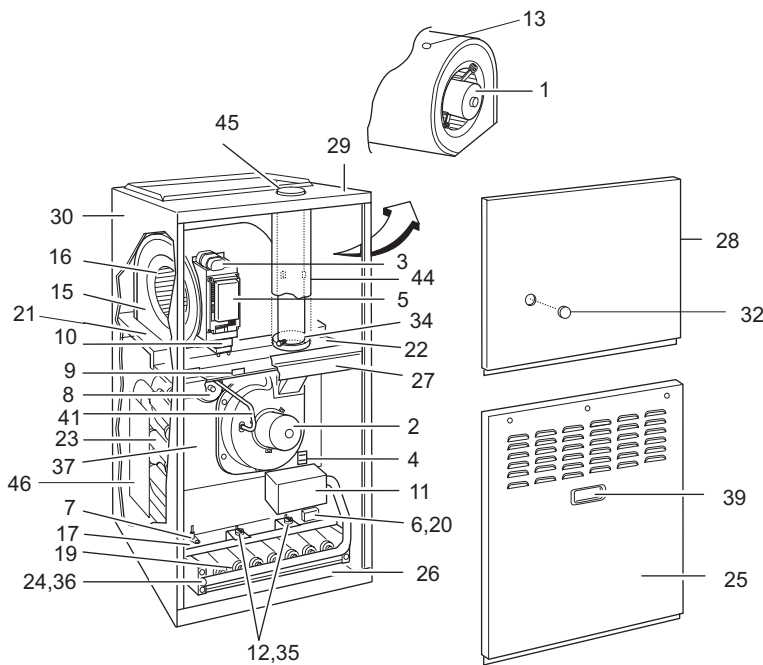

Figure 1: DOWNFLOW/HORIZONTAL NATURAL GAS FURNACES (80%)

FIG	ITEM	DESCRIPTION	GM8S040A12DH11C	GM8S060A12DH11C	GM8S080A12DH11C	GM8S080B16DH11C
			LM8S040A12DH11C	LM8S060A12DH11C	LM8S080A12DH11C	LM8S080B16DH11C
			(2 BURNER)	(3 BURNER)	(4 BURNER)	(4 BURNER)
MOTOR						
1	1	MOTOR, DIRECT DRIVE BLOWER	S1-02435647000	S1-02435647000	S1-02435647000	S1-02426002000
1	2	MOTOR, VENTOR ASS'Y	S1-02435329000	S1-02435329000	S1-02435329000	S1-02435329000
ELECTRICAL						
1	3	CAPACITOR (10MFD/370V) [RC]	S1-02420046000	S1-02420046000	S1-02420046000	S1-02420046000
1	4	CONTROL, HIGH LIMIT [LS1]	S1-02529041011	S1-02529041005	S1-02529041005	S1-02529041011
1	5	CONTROL, FURNACE [FC]	S1-03109166000	S1-03109166000	S1-03109166000	S1-03109166000
1	6	IGNITOR	S1-02532625000	S1-02532625000	S1-02532625000	S1-02532625000
1,2	7	SENSOR, FLAME	S1-02527773000	S1-02527773000	S1-02527773000	S1-02527773000
1	8	SWITCH, AIR PRESSURE [1LP]	S1-02435270000	S1-02435270000	S1-02435271000	S1-02435271000
1	9	SWITCH, DOOR [SW]	S1-02431943000	S1-02431943000	S1-02431943000	S1-02431943000
1	10	TRANSFORMER	S1-02530889000	S1-02530889000	S1-02530889000	S1-02530889000
1,2	11	VALVE, GAS	S1-02537426000	S1-02537426000	S1-02537426000	S1-02537426000
1,2	12	CONTROL, LIMIT (Blower) [ROS1]	S1-02527747016	S1-02527747016	S1-02527747016	S1-02527747016
1	13	CONTROL, AUXILARY LIMIT [LS2]	S1-02527792009	S1-02527792009	S1-02527792009	S1-02527792009
*	14	FUSE	S1-02532746026	S1-02532746026	S1-02532746026	S1-02532746026
AIR MOVING						
1	15	HOUSING, BLOWER	S1-37317827001	S1-37317827001	S1-37317827001	S1-37317829001
*	15A	PANEL, FILLER WRAP	---	---	---	S1-06378006000
1	16	WHEEL, BLOWER	S1-02619654003	S1-02619654003	S1-02619654003	S1-02619654014

NOTE: \*Not Shown

New replacement parts shown in **bold** face type at the first printing of parts list dated 12/06.

Major components and suggested stocking items are shown with shaded item number.

"<" Across from row indicates a change in that row.

--- Not applicable to specified model.

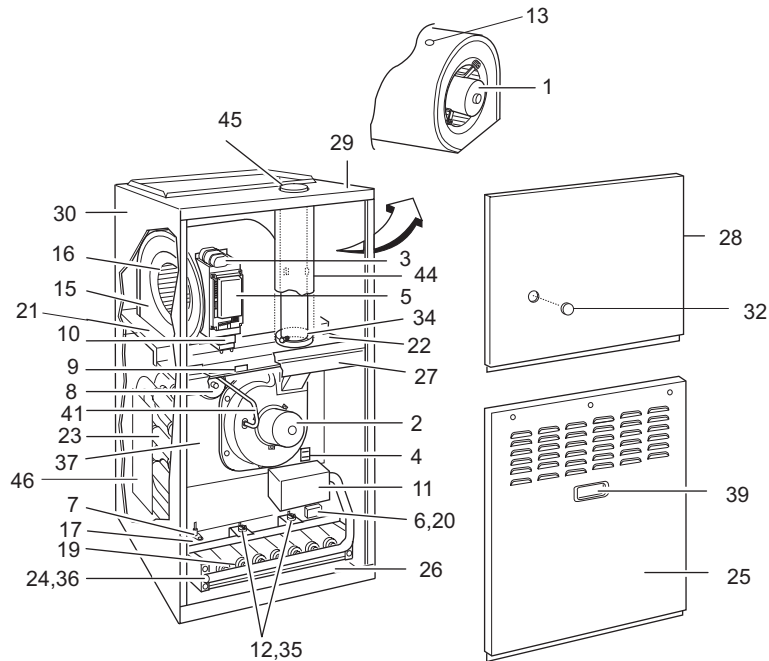

Figure 1: DOWNFLOW/HORIZONTAL NATURAL GAS FURNACES (80%)

FIG	ITEM	DESCRIPTION	GM8S080C16DH11B	GM8S100B12DH11C	GM8S100C16DH11C	GM8S100C20DH11C	<
			LM8S080C16DH11B	LM8S100B12DH11C	LM8S100C16DH11C	LM8S100C20DH11C	<
			(4 BURNER)	(5 BURNER)	(5 BURNER)	(5 BURNER)	
MOTOR							
1	1	MOTOR, DIRECT DRIVE BLOWER	S1-02426002000	S1-02435647000	S1-02423211003	S1-02432056000	
1	2	MOTOR, VENTOR ASS'Y	S1-02435329000	S1-02435329000	S1-02435329000	S1-02435329000	
ELECTRICAL							
1	3	CAPACITOR (10MFD/370V) [RC]	S1-02420046000	S1-02420046000	S1-02420046000	---	
		CAPACITOR (15MFD/370V) [RC]	---	---	---	S1-02425900000	
1	4	CONTROL, HIGH LIMIT [LS1]	S1-02529041011	S1-02529041004	S1-02529041007	S1-02529041002	
1	5	CONTROL, FURNACE [FC]	<b>S1-03109166000</b>	<b>S1-03109166000</b>	<b>S1-03109166000</b>	<b>S1-03109166000</b>	
1	6	IGNITOR	S1-02532625000	S1-02532625000	S1-02532625000	S1-02532625000	
1,2	7	SENSOR, FLAME	S1-02527773000	S1-02527773000	S1-02527773000	S1-02527773000	
1	8	SWITCH, AIR PRESSURE [1LP]	S1-02435271000	S1-02435272000	S1-02435272000	S1-02435272000	
1	9	SWITCH, DOOR [SW]	S1-02431943000	S1-02431943000	S1-02431943000	S1-02431943000	
1	10	TRANSFORMER	S1-02530889000	S1-02530889000	S1-02530889000	S1-02530889000	
1,2	11	VALVE, GAS	S1-02537426000	S1-02537426000	S1-02537426000	S1-02537426000	
1,2	12	CONTROL, LIMIT (Blower) [ROS1,2]	S1-02527747018	S1-02527747018	S1-02527747018	S1-02527747018	
1	13	CONTROL, AUXILARY LIMIT	S1-02527792009	S1-02527792009	S1-02527792009	S1-02527792009	
*	14	FUSE	S1-02532746026	S1-02532746026	S1-02532746026	S1-02532746026	
AIR MOVING							
1	15	HOUSING, BLOWER	S1-37317829001	S1-37317827001	S1-37317829001	S1-37319870502	
1	15A	PANEL, FILLER WRAP	S1-06378006000	---	S1-06378006000	S1-07319870501	
1	16	WHEEL, BLOWER	S1-02619654014	S1-02619654003	S1-02619654014	S1-02638510000	

NOTE: \*Not Shown

New replacement parts shown in **bold** face type at the first printing of parts list code dated 12/06.

Major components and suggested stocking items are shown with shaded item number.

"←" Across from row indicates a change in that row.

--- Not applicable to specified model.