

Ignition Controls

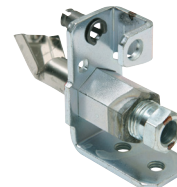

Order #	Mfg. #	Description	OEM/OEM Mfg. #
L38-924	S1-02526363700	Ignition Control Module	Johnson Controls #G67BG4C
L38-969	S1-32542681000	Spark Ignition Control Kit	Johnson Controls #G775RJD-1C

Pilot Burner



Order #	Mfg. #	Description	OEM/OEM Mfg. #
L39-411	S1-9880A0161	Pilot Burner	Robertshaw

Sensors

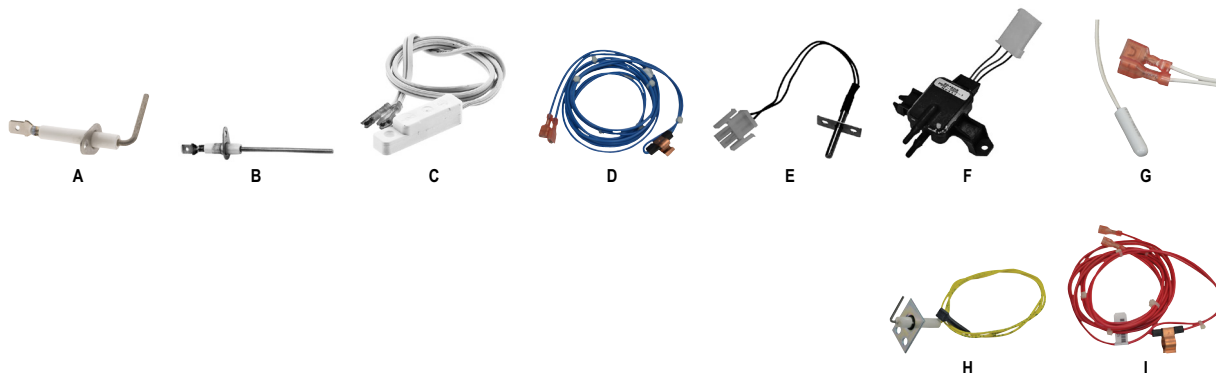

Fig.	Order #	Mfg. #	Description	OEM/OEM Mfg. #
A	L38-809	S1-2702-311P	Sensor Rod	Channel Products #1659-80
A	L38-914	S1-2845-3111	Flame Sensor	Channel Products #1259-95
A	L38-936	S1-02530801000	Flame Sensor	Precision Speed #PSE-Y17
A	L38-937	S1-02530802000	Flame Sensor	Precision Speed #PSE-Y18
A	L40-309	S1-02535306000	Gas Flame Sensor	Precision Speed #PSE-Y32
B	L38-728	S1-02530788700	Flame Sensor	Precision Speed #PSE-Y16
B	L38-928	S1-02527773700	Flame Sensor	Precision Speed #PSE-YK2
B	L39-420	S1-02526362700	Flame Sensor	White-Rodgers #07 60 688 S1
B	L41-979	S1-02537499000	Sensor Rod	York
C	L39-422	S1-03101231700	Flame Sensor	Therm-O-Disc #9RT1H652
C	L39-424	S1-03101232700	Liquid Sensor	Therm-O-Disc #9RT1H653

Fig.	Order #	Mfg. #	Description	OEM/OEM Mfg. #
C	L41-759	S1-02532701000	Temperature Sensor	York
C	L41-760	S1-02532701016	Temperature Sensor	York
D	L41-761	S1-03101276000	Liquid Sensor	York
D	L44-509	S1-03101252000	Temperature Sensor	York
E	L44-301	S1-03109199000	Sensor	York
F	L44-308	S1-02435922000	Pressure Sensor	York
G	L45-703	S1-02542683000	Temperature Sensor	York
H	L39-421	S1-02538950000	Flame Sensor	Johnson Controls #Y75FB-1C
I	L43-453	S1-03101278000	Discharge Sensor	York
—	L48-964	S1-02547281000	Temperature Sensor	York