

REPAIR PARTS

CHPTA Horizontal Cased Coil

CHPTA1822A3AA
CHPTA1822B3AA
CHPTA2426B3AA
CHPTA2426C3AA
CHPTA3026B3AA
CHPTA3026C3AA
CHPTA3630B3AA
CHPTA3630C3AA
CHPTA4230C3AA
CHPTA4830C3AA
CHPTA6030D3AA

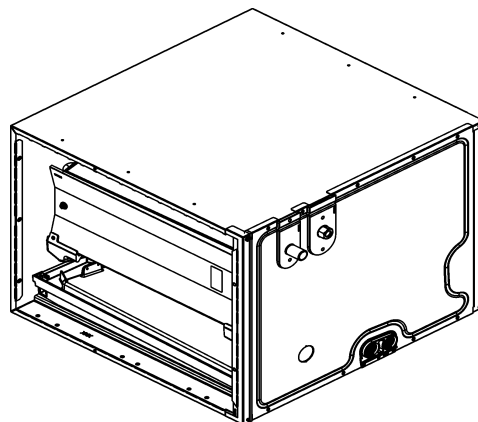

This manual is to be used by qualified technicians only.

© 2024 Goodman Manufacturing Company, L.P. ♦ 19001 Kermier Rd. ♦ Waller, TX 77484

Important Information

Index

Functional Parts List	3
Illustration and Parts	4 - 7

Views shown are for parts illustrations only, not servicing procedures.

Text Codes:

AR - As Required

NA - Not Available

NS - Not Shown

00000000 - See Note

QTY - Quantity Example (QTY 3) (If Quantity not shown, Quantity = 1)

M - Model Example (M1) (If M Code not shown, then part is used on all Models)

Expanded Model Nomenclature:

Example

M1 - Model#1

M2 - Model#2

M3 - Model#3

Goodman Manufacturing Company, L.P. is not responsible for personal injury or property damage resulting from improper service. Review all service information before beginning repairs.

Warranty service must be performed by an authorized technician, using authorized factory parts. If service is required after the warranty expires, Goodman Manufacturing Company, L.P. also recommends contacting an authorized technician and using authorized factory parts.

Goodman Manufacturing Company, L.P. reserves the right to discontinue, or change at any time, specifications or designs without notice or without incurring obligations.

For assistance within the U.S.A. contact:

Homeowner Support

Goodman Manufacturing Company, L.P.

19001 Kermier Road

Waller, Texas 77484

877-254-4729-Telephone

713-863-2382-Facsimile

For assistance outside the U.S.A. contact:

International Division

Goodman Manufacturing Company, L.P.

19001 Kermier Road

Waller, Texas 77484

713-861-2500-Telephone

713-863-2382-Facsimile

Functional Parts

Part

No: **Description:**

SER2A08012	SENSATA, R32 SENSOR
0151R00265	TXV-FX-1.5T-ADJ VALVE (M1, M2)
0151R00272	TXV-FX-2T-ADJ VALVE (M3, M4)
0151R00273	TXV-FX-3T-ADJ VALVE (M5, M6, M7, M8)
0151R00274	TXV-FX-4T-ADJ VALVE (M9, M10)
0151R00275	TXV-FX-5T-ADJ VALVE (M11)

Expanded Model Nomenclature

M1 - CHPTA1822A3AA
M2 - CHPTA1822B3AA
M3 - CHPTA2426B3AA
M4 - CHPTA2426C3AA
M5 - CHPTA3026B3AA
M6 - CHPTA3026C3AA
M7 - CHPTA3630B3AA
M8 - CHPTA3630C3AA
M9 - CHPTA4230C3AA
M10 - CHPTA4830C3AA
M11 - CHPTA6030D3AA

CABINET ASSEMBLY

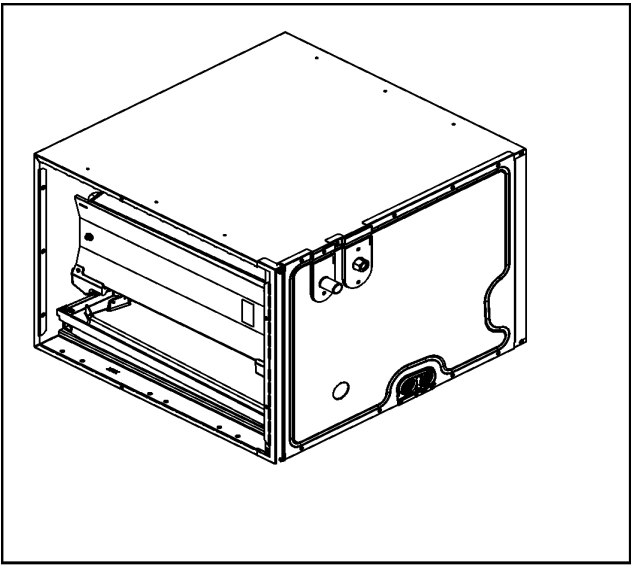

CABINET ASSEMBLY

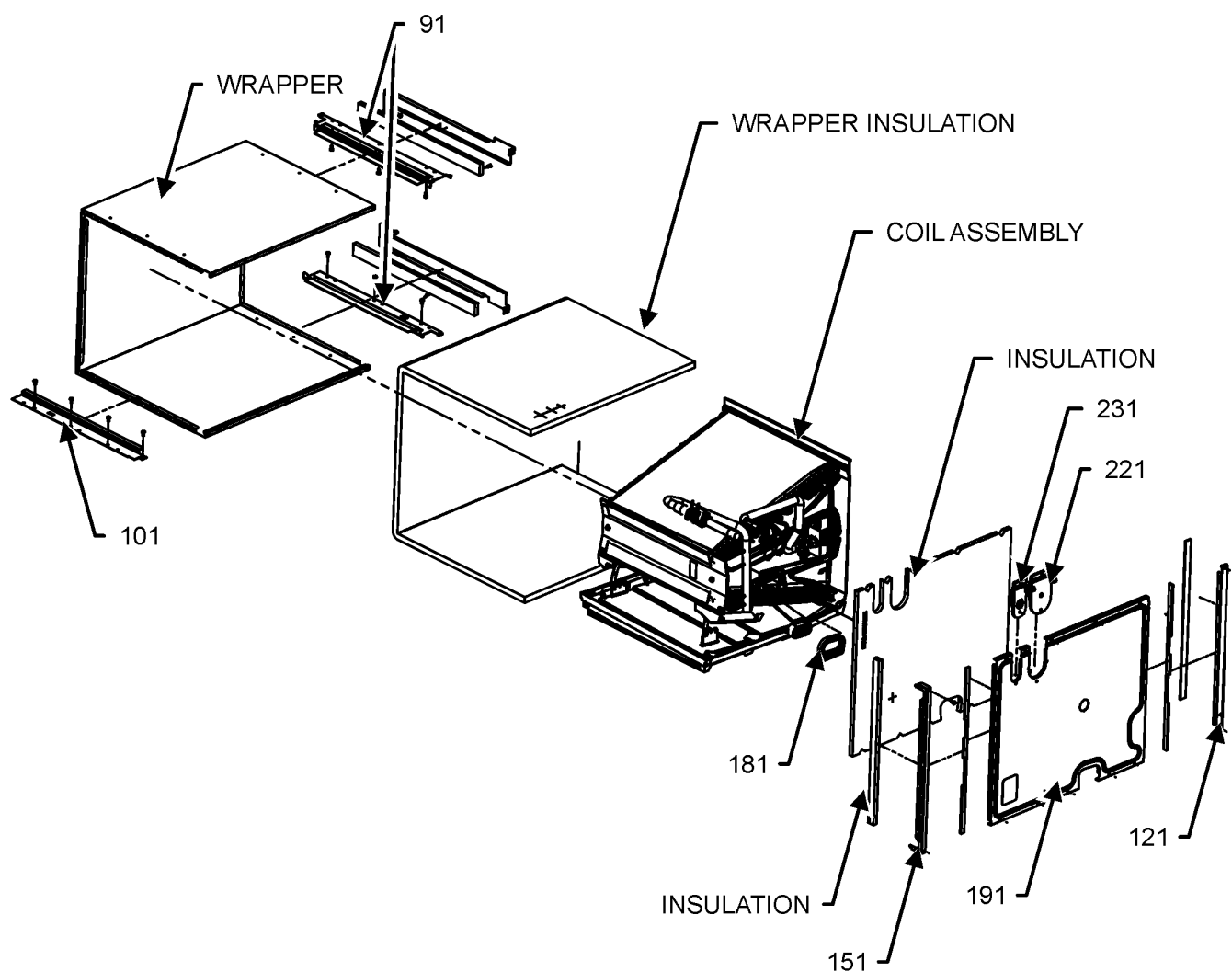

CABINET ASSEMBLY MAY DIFFER FROM WHAT IS SHOWN

CABINET ASSEMBLY

Ref. Part No: No:	Description:	Ref. Part No: No:	Description:
Image 1:			
91	0121D01224		RAIL DRAIN PAN, CASED COIL (QTY 2)
101	0121D00811		RAIL, DRAIN PAN,
121	0121D00502PDG		RAIL BOTTOM,CASED COIL,PAINTED (M1)
121	0121D00503PDG		RAIL BOTTOM,CASED COIL,PAINTED (M2, M3, M5, M7)
121	0121D00504PDG		RAIL BOTTOM,CASED COIL,PAINTED (M4, M6, M8, M9, M10)
121	0121D00505PDG		RAIL BOTTOM,CASED COIL,PAINTED (M11)
151	0121D00906PDG		RAIL TOP PNT, CASED E COIL (M1)
151	0121D00907PDG		RAIL TOP PNT, CASED E COIL (M2, M3, M5)
151	0121D00908PDG		RAIL TOP PNT, CASED E COIL (M4, M6, M8, M9, M10)
151	0121D00909PDG		RAIL TOP PNT, CASED E COIL (M11)
151	0121D00982PDG		RAIL TOP, CASED E COIL, PAINTED (M7)
181	0154A00048		GASKET, DRAIN PAN
191	0121D00572PDG		PNL ACCESS PNT, CASED E COIL (M2)
191	0121D00575PDG		PNL ACCESS PNT, CASED E COIL (M3, M5)
191	0121D00598PDG		PNL ACCESS PNT, CASED E COIL (M4, M6)
191	0121D00690PDG		PNL ACCESS PNT, CASED E COIL (M8, M9, M10)
191	0121D00691PDG		PNL ACCESS PNT, CASED E COIL (M11)
191	0121D01130PDG		PNL ACCESS, CASED EVAP COIL (M1)
191	0121D00981PDG		PNL ACCESS, PAINTED (M7)
221	0154D00015		GROMMET, LIQUID TUBE (M4, M6, M8, M9, M10, M11)
221	0154D00040		GROMMET, LIQUID TUBE (M1, M2, M3, M5, M7)
231	0154D00005		GROMMET, SUCTION (M1, M2)
231	0154D00014		GROMMET, SUCTION (M3, M4, M5, M6, M7, M8, M9, M10, M11)
NS	0163M00097		SCREW WASHERED (QTY 4)

Expanded Model Nomenclature

M1 - CHPTA1822A3AA
M2 - CHPTA1822B3AA
M3 - CHPTA2426B3AA
M4 - CHPTA2426C3AA
M5 - CHPTA3026B3AA
M6 - CHPTA3026C3AA
M7 - CHPTA3630B3AA
M8 - CHPTA3630C3AA
M9 - CHPTA4230C3AA
M10 - CHPTA4830C3AA
M11 - CHPTA6030D3AA

COIL TUBING ASSEMBLY

TUBING ASSEMBLY

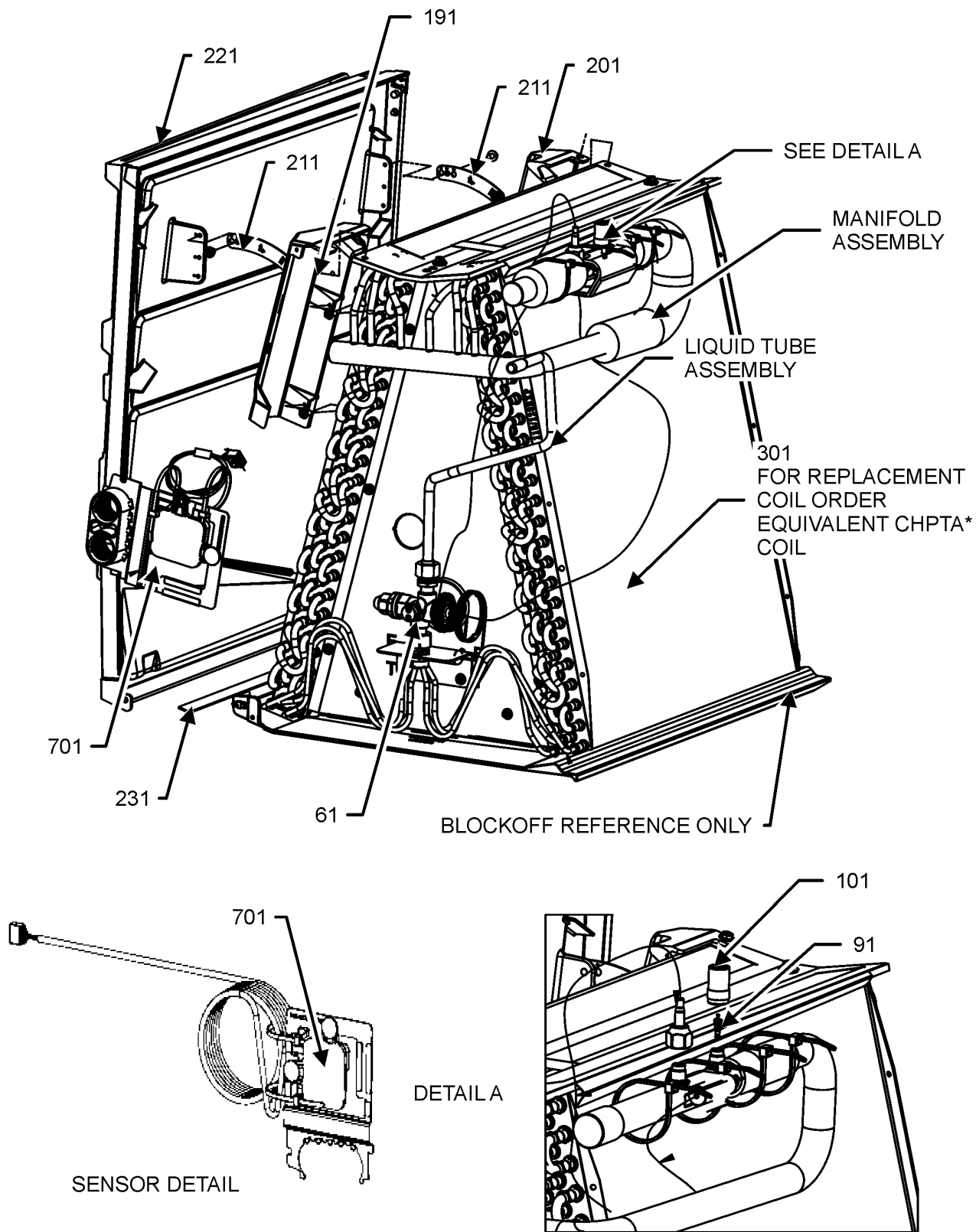

TUBING ASSEMBLY MAY DIFFER FROM WHAT IS SHOWN

COIL TUBING ASSEMBLY

Ref. Part No: No:	Description:	Ref. Part No: No:	Description:
Image 1:			
61	0151R00265		TXV-FX-1.5T-ADJ VALVE (M1, M2)
61	0151R00272		TXV-FX-2T-ADJ VALVE (M3, M4)
61	0151R00273		TXV-FX-3T-ADJ VALVE (M5, M6, M7, M8)
61	0151R00274		TXV-FX-4T-ADJ VALVE (M9, M10)
61	0151R00275		TXV-FX-5T-ADJ VALVE (M11)
91	0151M00104		VALVE CORE
101	0163M00629		RED CAP WITH O-RING
191	0161D00111		CONDENSATE COLLECTOR, FRONT (M2, M3, M4, M5, M6, M7, M8, M9, M10, M11)
201	0161D00112		CONDENSATE COLLECTOR, BACK (M2, M3, M4, M5, M6, M7, M8, M9, M10, M11)
211	0121D01042		BRACKET (M1)
211	0121D00882		BRKT, 2"-C (M4, M7, M8, M9, M10)
211	0121D00897		BRKT, 3" (M3, M6)
211	0121D01262		BRKT, 4"-C (M11)
211	0121D00929		BRKT, C (M2, M5)
221	0161D00046		DRAIN PAD SIDE, EVAP COIL, MED-LG (M3, M4, M5, M6)
221	0161D00110		DRAIN PAN SIDE, EVAP COIL, LG (M7, M8, M9, M10, M11)
221	0161D00045		DRAIN PAN SIDE, EVAP COIL, MED (M1, M2)
231	0154A00016		GASKET, PORON
301	CHPTA1822A3		1.5T HZ CASED E COIL TXV (M1)
301	CHPTA1822B3		1.5T HZ CASED E COIL TXV (M2)
301	CHPTA3026B3		2.5T HZ CASED E COIL TXV (M5)
301	CHPTA3026C3		2.5T HZ CASED E COIL TXV (M6)
301	CHPTA2426B3		2T HZ CASED E COIL TXV (M3)
301	CHPTA2426C3		2T HZ CASED E COIL TXV (M4)
301	CHPTA4230C3		3.5T HZ CASED E COIL TXV (M9)
301	CHPTA3630B3		3T HZ CASED E COIL TXV (M7)
301	CHPTA3630C3		3T HZ CASED E COIL TXV (M8)
301	CHPTA4830C3		4T HZ CASED E COIL TXV (M10)
301	CHPTA6030D3		5T HZ CASED E COIL TXV (M11)
701	SER2A08012		SENSATA, R32 SENSOR
NS	0151M00101		ACCESS VALVE FITTING (QTY 2)
NS	0161D00100		DRAIN PAN EXTN, EVAP COIL LG
NS	0163M00097		SCREW WASHERED (QTY 4)
NS	0121A01738		SENSOR BRACKET

Expanded Model Nomenclature

M1 - CHPTA1822A3AA
M2 - CHPTA1822B3AA
M3 - CHPTA2426B3AA
M4 - CHPTA2426C3AA
M5 - CHPTA3026B3AA
M6 - CHPTA3026C3AA
M7 - CHPTA3630B3AA
M8 - CHPTA3630C3AA
M9 - CHPTA4230C3AA
M10 - CHPTA4830C3AA
M11 - CHPTA6030D3AA

FOR REPLACEMENT COIL, ORDER EQUIVALENT CHPT* COIL