

BK17 & 22 CONDENSATE PUMP

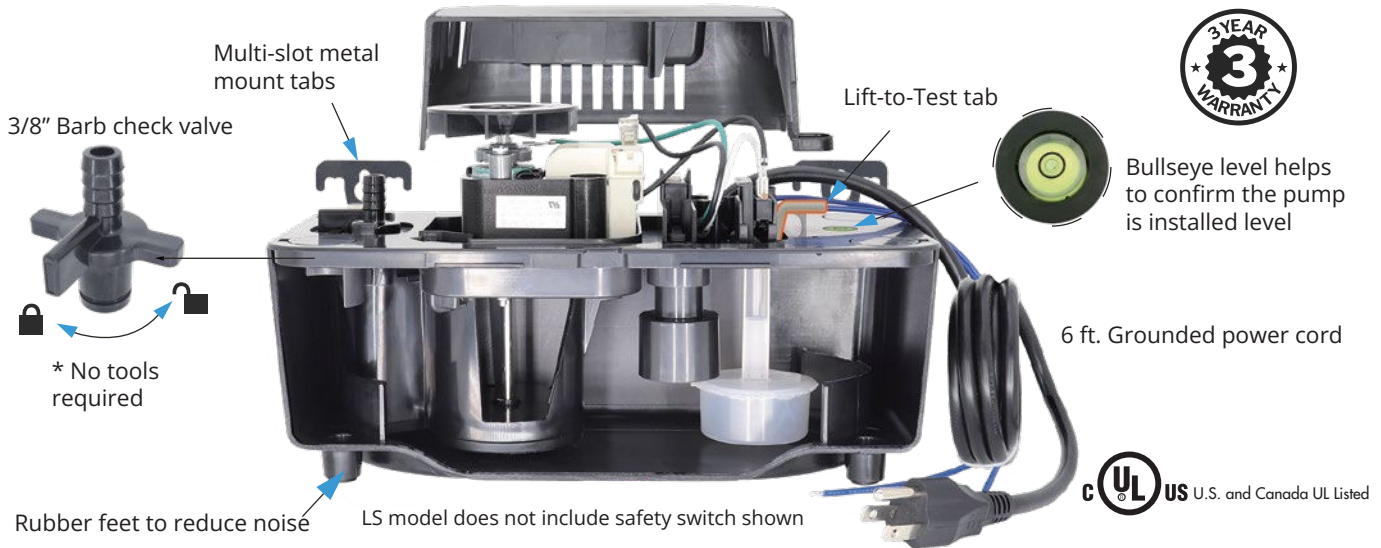

New design offers a longer 3 year warranty life and reduced noise level. Includes lid mounted bullseye level for easy installation. Rated for condensate water up to 150° F. Automatic start/stop operation with thermally protected motor. More water pumped out per cycle means the pump runs less and lasts longer. Larger 2.5 quart tank capacity. This unit is capable of handling acidic condensation from condensing furnaces and tankless water heaters.

| Model | Note | Volts-Hz | Amps Watts | Weight | Flow (GPH)@ | | | Max lift | Outlet | Inlet |
|-----------|-------------------|-----------|------------|---------|-------------|-----|-----|----------|-----------|----------|
| | | | | | 1' | 10' | 15' | | | |
| BK171LSUL | w/o Safety Switch | 115-60 | 1.1-60 | 3.6 lbs | 112 | 64 | 19 | 17' | 3/8" Barb | 4 x 1.1" |
| BK171TUL | w/ Tubing | 115-60 | 1.1-60 | 4.8 lbs | 112 | 64 | 19 | 17' | 3/8" Barb | 4 x 1.1" |
| BK171UL | | 115-60 | 1.1-60 | 3.7 lbs | 112 | 64 | 19 | 17' | 3/8" Barb | 4 x 1.1" |
| BK221LSUL | w/o Safety Switch | 115-60 | 1.2-65 | 3.6 lbs | 125 | 83 | 50 | 22' | 3/8" Barb | 4 x 1.1" |
| BK221TUL | w/ Tubing | 115-60 | 1.2-65 | 4.8 lbs | 125 | 83 | 50 | 22' | 3/8" Barb | 4 x 1.1" |
| BK221UL | | 115-60 | 1.2-65 | 3.7 lbs | 125 | 83 | 50 | 22' | 3/8" Barb | 4 x 1.1" |
| BK222TUL | w/ Tubing | 230-50/60 | 0.9-77 | 5.4 lbs | 156 | 103 | 68 | 22' | 3/8" Barb | 4 x 1.1" |
| BK222UL | | 230-50/60 | 0.9-77 | 4.3 lbs | 156 | 103 | 68 | 22' | 3/8" Barb | 4 x 1.1" |

Average Performance

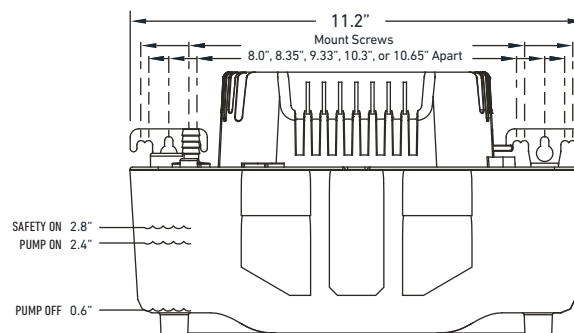
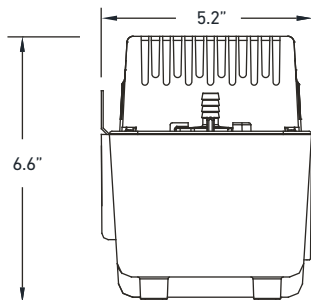

BK17 & 22 CONDENSATE PUMP

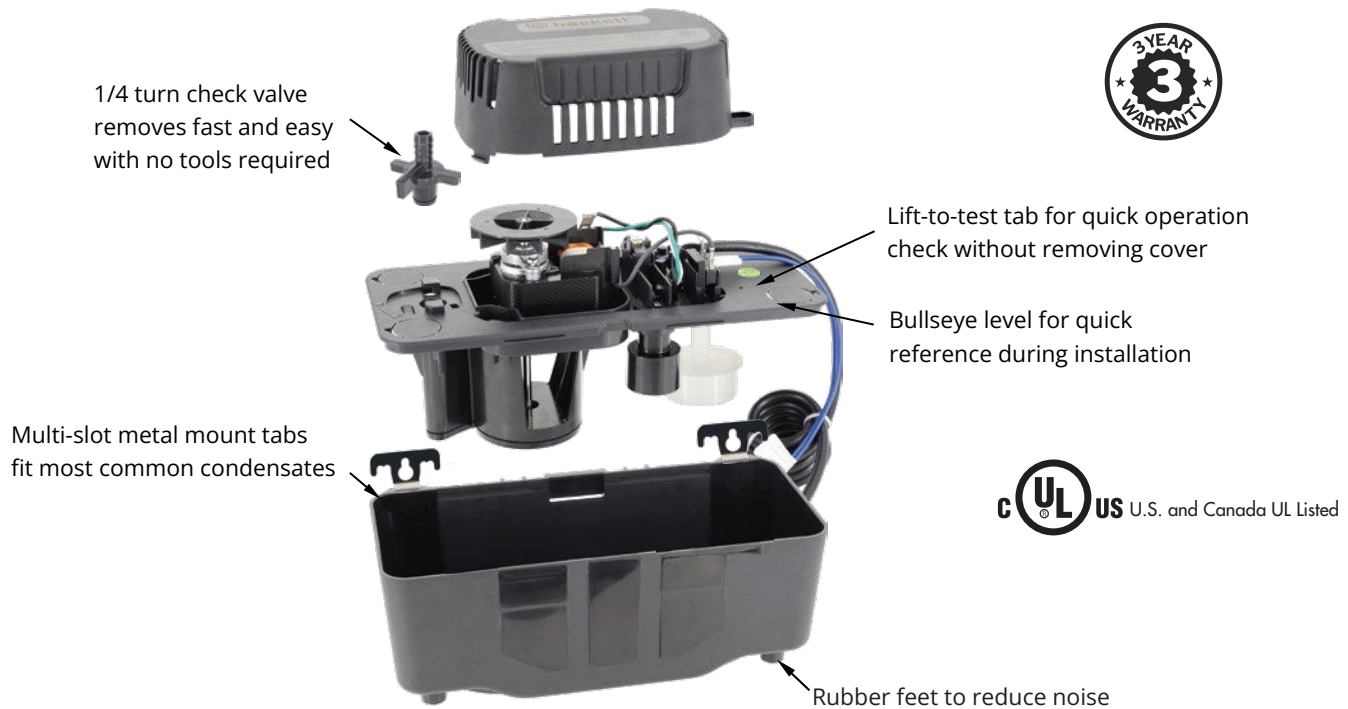

New design offers a longer 3 year warranty life and reduced noise level. Includes lid mounted bullseye level for easy installation. Rated for condensate water up to 150° F. Automatic start/stop operation with thermally protected motor.

| | Warranty | Rated water temp (F) | Life | | Performance | | Run time | | Installation aids | | Sound dampening | | Easy maintenance | | L | W | H |
|----------|----------|----------------------|------------|-----------|-------------|-----------|------------|--|---------------------------------|--------------|-----------------|-------------|------------------------|--|-------|------|------|
| | | | Motor/pump | Heat rise | GPH | Max | Drink (Oz) | | Wall mount | Mounting | Lift to | Rubber feet | Twist lock check valve | | | | |
| | | | temp (K) | temp (K) | Flow @ 1' | lift (Ft) | | | | Level bubble | test tab | | | | | | |
| BK171UL | 3 yrs | 150 ° | 74 | 112 | 17 | 45=Lower | | | Multi-Slot Stainless steel tabs | Y | Y | Y | Y | | 11.5" | 5.2" | 6.6" |
| LGVCMA15 | 1 yr | 140 ° | 87 | 65 | 15.2 | 23=Higher | | | Plastic tank tabs | N | N | N | N | | 11.0" | 5.0" | 7.0" |
| DTCP16 | 2 yrs | 140 ° | 87 | 104 | 15.7 | 20=Higher | | | Metal tabs | N | N | N | N | | 10.8" | 4.5" | 6.3" |
| BK221UL | 3 yrs | 150 ° | 82 | 125 | 22 | 45=Lower | | | Multi-Slot Stainless steel tabs | Y | Y | Y | Y | | 11.5" | 5.2" | 6.6" |
| LGVCMA20 | 1yr | 140 ° | 84 | 80 | 20 | 22=Higher | | | Plastic tank tabs | N | N | N | N | | 11.0" | 5.0" | 7.0" |
| DTCP22 | 2 yrs | 140 ° | 107 | 92 | 22 | 35=Higher | | | Metal tabs | N | N | Y | N | | 11.5" | 5.5" | 6.3" |

*Performance per manufacturer published data

Average Performance

Heat rise: The measurement of how much the motor heats up from cold start to peak hot operation temperature. Higher heat reduces motor & bearing life.
 Drink: The amount of water between on/off switch level or the amount of water pumped out during each cycle. More water pumped out per cycle means the pump runs less and last longer.

