



# PREMIUM M

## Energy Recovery Ventilator EC Motor



### INDOOR UNIT

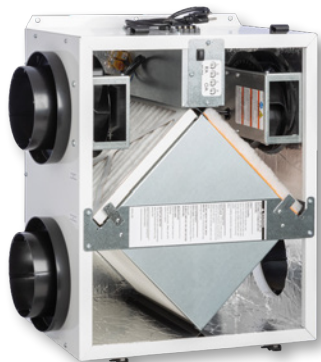

### SPECIFICATIONS

#### Ventilation Type:

Static plate, heat and humidity transfer

#### Typical Airflow Range: 30–225 CFM

#### Unit is HVI Tested/Certified per CSA C439

Protocol: Using one L-50-G5 Core

#### Standard Features:

White painted cabinet  
Line-cord power supply  
Low-voltage circuit for controls  
Unit may be mounted in any orientation  
Cross-core differential pressure ports  
Dial-A-Flow: balance and airflow adjustment  
Variable speed  
Boost-mode

#### Controls:

Onboard digital controller with independent variable speeds

#### Filters:

Total qty. 2, MERV 8, spun-polyester media:  
10 1/2" x 10 1/2" x 1"

#### Unit Weight: 36 lbs.

#### Max. Shipping Dimensions & Weight (in carton):

32" L x 22" W x 18" H  
48 lbs.

#### Motor(s):

Qty. 2, 120V EC motorized impellers

#### Accessories:

Backdraft damper: 6", 8"  
Automatic balancing damper: 4", 5", 6"  
Louvered wall vent 6": white, brown  
Louvered wall vent 8": taupe vinyl, galvanized, paintable galvalume  
Louvered wall vent with 8" round duct connection: 12" W x 8" H  
Hooded wall vent 8": galvanized, paintable galvalume  
Digital time clock: wall mount (TC7D-W), in exterior enclosure (TC7D-E)  
Carbon dioxide sensor/control: wall mount (CO2-W), duct mount (CO2-D)  
IAQ sensor: wall mount (IAQ-W), duct mount (IAQ-D)  
Motion occupancy sensor/control: ceiling mount (MC-C), wall mount (MC-W)  
Push-button boost timer (PBT)  
Percentage timer control (PTL)  
Percentage timer control with furnace interlock (FM)  
Push-button point-of-use controls (PBL), PTL req'd.  
MERV 13 filter: OA airstream (shipped loose)  
Electric duct heater: RH series (1–6 kW); designed for indoor ductwork installation only

### EC MOTOR OPERATING RANGE AND CORE PERFORMANCE

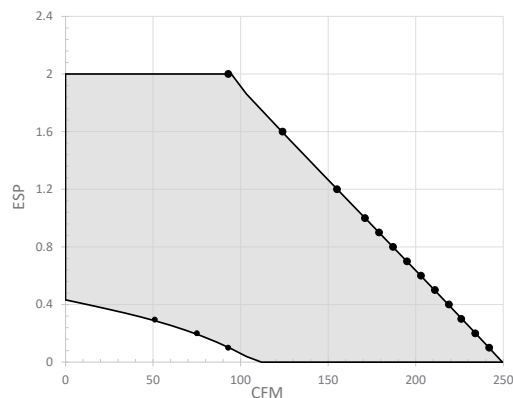

● = Actual tested sample points

| = Operating Curves, airflow is held constant as static pressure varies

Airflow (CFM)	External Static Pressure (Inches Water Column)	Unit Power Consumption (Watts)	Sensible EFF%	Total EFF% Winter/Summer
<b>Max Speed</b>				
242	0.1	191	57	47/28
233	0.2	190	58	48/29
227	0.3	189	59	49/31
218	0.4	189	60	50/32
210	0.5	191	61	52/34
203	0.6	192	62	53/35
195	0.7	189	63	54/37
186	0.8	191	64	56/38
180	0.9	189	65	57/40
172	1	190	66	58/42
155	1.2	191	68	61/45
124	1.6	190	72	66/51
92	2	190	77	71/57
<b>Min Speed</b>				
93	0.1	74	76	71/57
75	0.2	68	79	74/60
51	0.3	58	82	78/65

#### Notes:

- Watts is for the entire unit.
- Airflow performance includes effect of clean, standard filter supplied with unit.
- Refer to CORES for specific operating point electrical data.
- These are core-only ratings and are not HVI certified. Total EFF% calculated at 35/33wb OA and 70/58wb RA (winter) and 95/78wb OA and 75/63wb RA (summer). HVI ratings apply to complete units only. This unit is HVI certified. See HVI certified ratings on pg. 35 of SL & EV Premium Catalog and at hvi.org.

### ELECTRICAL DATA

Watts	Volts	Hz	Phase	FLA per motor	Minimum Circuit Amps	Max Overcurrent Protection Device
85	120	60	1	1.22	10	10

### AUGMENTED REALITY (AR)

Scan QR code to see life size version of EV Premium M, or view here:  
<https://QR.Marketscale.com/EVPremiumM>



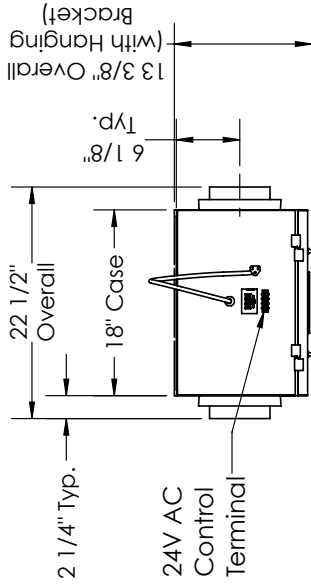

TOP VIEW

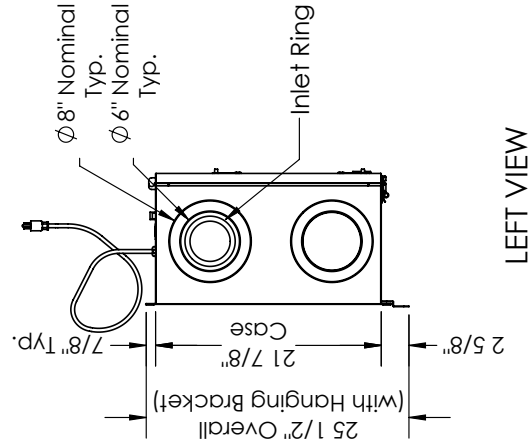

LEFT VIEW

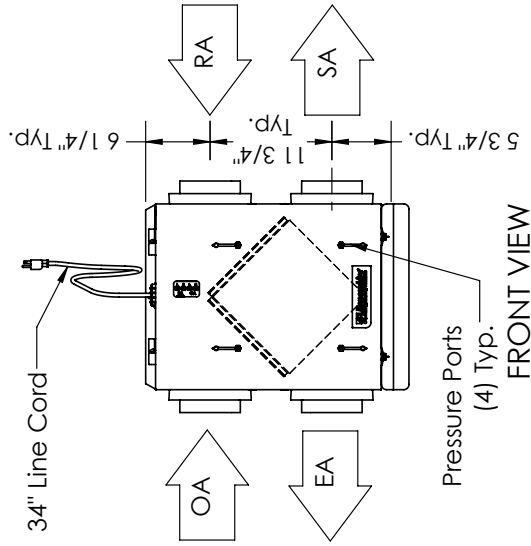

FRONT VIEW

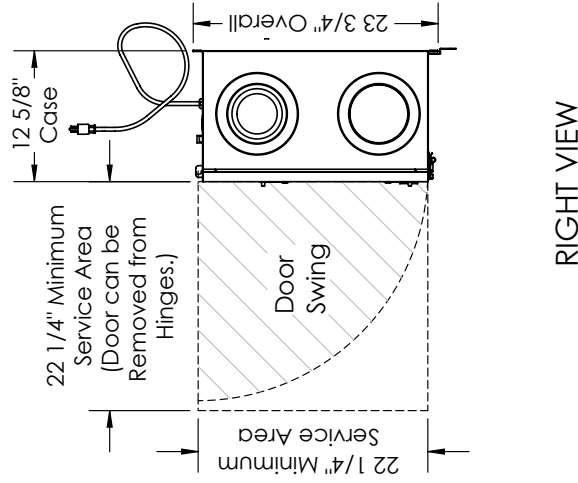

RIGHT VIEW

**ABBREVIATIONS**

EA: Exhaust Air to outside  
OA: Outside Air Intake  
RA: Room Air to be exhausted  
SA: Supply Air to inside

**INSTALLATION ORIENTATION**

Unit may be installed in any orientation.

**NOTE**

1. UNLESS OTHERWISE SPECIFIED, DIMENSIONS ARE ROUNDED TO THE NEAREST EIGHTH OF AN INCH.

2. SPECIFICATIONS MAY BE SUBJECT TO CHANGE WITHOUT NOTICE.

**AIRFLOW ORIENTATION**

Available as shown in dimension drawing.

**UNIT MOUNTING & APPLICATION**

Can be mounted in any orientation. RA/EA airstream can be switched with OA/SA airstream.

