FTXM**VVJU Ductless Indoor Wall Mounted HP Inverter

FTXM09VVJU

FTXM12VVJU

FTXM18VVJU

FTXM24VVJU



This manual is to be used by qualified technicians only.

Important Information

Index

Functional Parts List	3
Illustration and Parts	4 - 7

Views shown are for parts illustrations only, not servicing procedures.

Text Codes:

AR - As Required

NA - Not Available

NS - Not Shown

00000000 - See Note

QTY - Quantity Example (QTY 3) (If Quantity not shown, Quantity = 1)

M - Model Example (M1) (If M Code not shown, then part is used on all Models)

Expanded Model Nomenclature:

Example M1 - Model#1 M2 - Model#2 M3 - Model#3

Daikin Manufacturing Company, L.P. is not responsible for personal injury or property damage resulting from improper service. Review all service information before beginning repairs.

Warranty service must be performed by an authorized technician, using authorized factory parts. If service is required after the warranty expires, Daikin Manufacturing Company, L.P. also recommends contacting an authorized technician and using authorized factory parts.

Daikin Manufacturing Company, L.P. reserves the right to discontinue, or change at any time, specifications or designs without notice or without incurring obligations.

For assistance within the U.S.A. contact:

Homeowner Support
Daikin North America, LLC
19001 Kermier Road
Waller, Texas 77484
855-770-5678-Telephone
713-863-2382-Facsimile

For assistance outside the U.S.A. contact:

International Division
Daikin North America, LLC
19001 Kermier Road
Waller, Texas 77484
713-861-2500-Telephone
713-863-2382-Facsimile

Functional Parts

Part

No: Description:

153875J	FUSE
2490298	HUMIDITY SENSOR
2534970	PRINTED CIRCUIT BOARD ASSY.
2533895	PRINTED CIRCUIT BOARD ASSY. (M3, M4)
2530196	PRINTED CIRCUIT BOARD ASSY.
2534974	PRINTED CIRCUIT BOARD ASSY. (CONTROL) (M4)
2534973	PRINTED CIRCUIT BOARD ASSY. (CONTROL) (M3)
2534972	PRINTED CIRCUIT BOARD ASSY. (CONTROL) (M2)
2534971	PRINTED CIRCUIT BOARD ASSY. (CONTROL) (M1)
4016176	PYROELECTRIC PASSIVE INFRARED SENSOR (M1, M2)
1906543	STEPPING MOTOR (QTY 3)
2490414	THERMISTOR ASSY.
2535233	WIRELESS LAN MODULE

Expanded Model Nomenclature

M1 - FTXM09VVJU
M2 - FTXM12VVJU
M3 - FTXM18VVJU
M4 - FTXM24VVJU

FTXM[09,12]VVJU
FTXM09VVJU / FTXM12VVJU

—TOP—

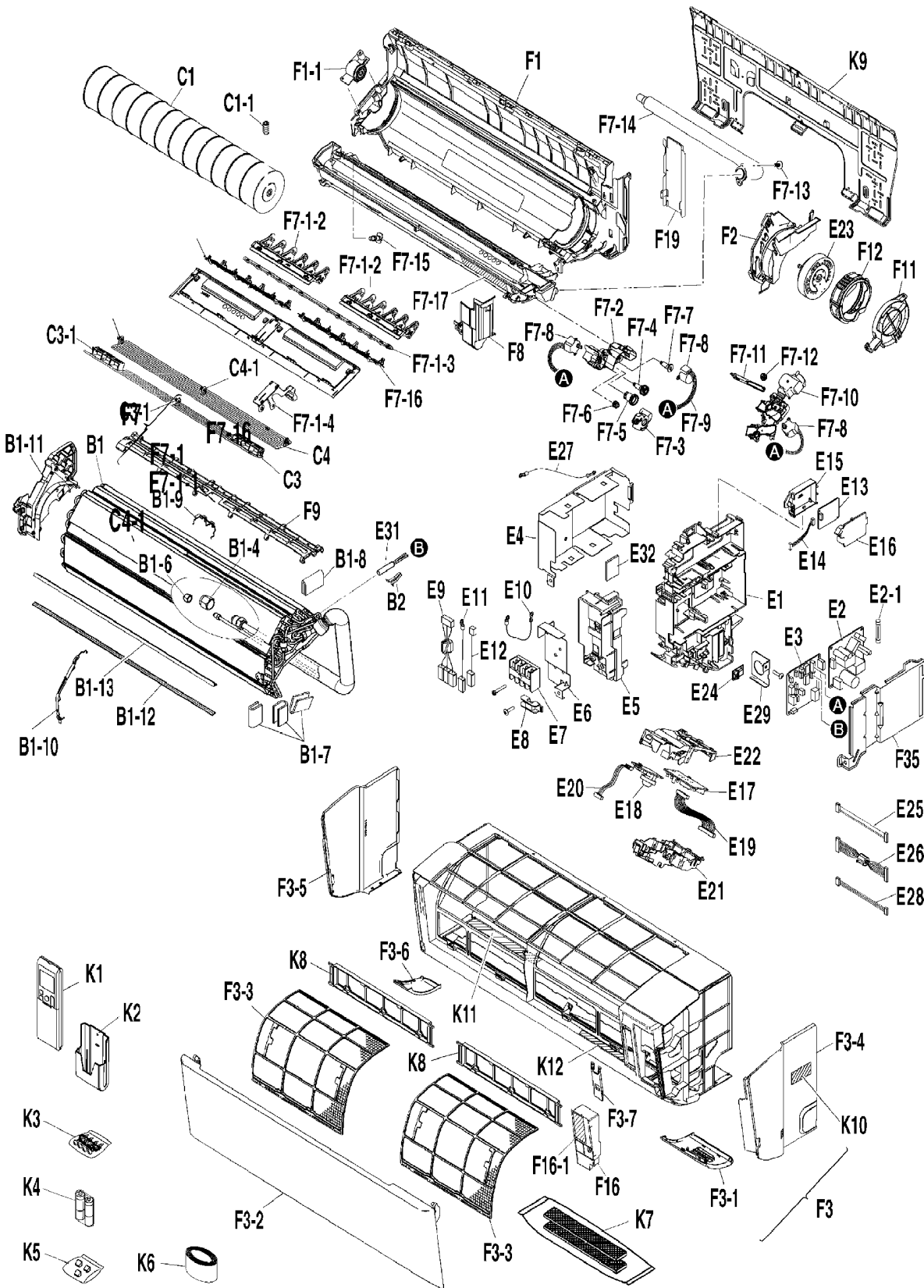

Reference #	Drawing #
1	B1
2	B1-10
3	B1-11
4	B1-12
5	B1-13
6	B1-4
7	B1-6
8	B1-7
9	B1-8
10	B1-9
11	B2
12	C1
13	C1-1
14	C3
15	C3-1
16	C4
17	C4-1
18	E1
19	E10
20	E11
21	E12
22	E13
23	E14
24	E15
25	E16
26	E17
27	E18
28	E19
29	E2
30	E20
31	E21
32	E2-1
33	E22
34	E23
35	E24
36	E25
37	E26
38	E27
39	E28
40	E29
41	E3
42	E31
43	E32
44	E4
45	E5
46	E6
47	E7
48	E8
49	E9
50	F1
51	F11
52	F1-1
53	F12
54	F16
55	F16-1
56	F19
57	F2
58	F3
59	F3-1
60	F3-2
61	F3-3
62	F3-4
63	F3-5
64	F3-6
65	F3-7
66	F3-8
67	F3-9
68	F3-10
69	F3-11
70	F3-12
71	F3-13
72	F3-14
73	F3-15
74	F3-16
75	F3-17
76	F3-18
77	F3-19
78	F3-20
79	F3-21
80	F3-22
81	F3-23
82	F3-24
83	F3-25
84	F3-26
85	F3-27
86	F3-28
87	F3-29
88	F3-30
89	F3-31
90	F3-32
91	F3-33
92	F3-34
93	F3-35
94	F3-36
95	F3-37
96	F3-38
97	F3-39
98	F3-40
99	F3-41
100	F3-42
101	F3-43
102	F3-44

FTXM[09,12]VVJU

Ref. Part No: No:	Description:		Ref. Part No: No:	Description:	
Image 1:			Image 1:		
1	2534967	HEAT EXCHANGER ASSY. (M1, M2)	53	2490609	VIBRATIONISOLATOR (M1, M2)
2	NA	WIRE SPRING ASSY. (8 STAGE) (M1, M2)	54	2535260	SERVICE COVER (M1, M2)
3	NA	SIDE PANEL (LEFT) (M1, M2)	55	NA	CAUTION LABEL (ELECTRIC SHOCK) (M1, M2)
4	NA	SEALING PLATE (HEAT EXCHANGER) (M1, M2)	56	2535261	PIPING FIXTURE (M1, M2)
5	NA	SEALING PLATE (H/E BENDING) (M1, M2)	57	2535259	SIDE PANEL (RIGHT) ASSY. (M1, M2)
6	119848J	FLARE NUT (M1, M2)	58	2534977	FRONT GRILLE ASSY. (M1, M2)
7	1723546	FLARE NUT (M1, M2)	59	2535255	CONTROL PANEL ASSY. (M1, M2)
8	NA	PUTTY (M1, M2)	60	2530202	PANEL ASSY. (M1, M2)
9	NA	PUTTY (M1, M2)	61	2530203	AIR FILTER (M1, M2)
10	NA	WIRE SPRING ASSY. (4 STAGE) (M1, M2)	62	2535252	FRONT GRILLE (SIDE PANEL) R (M1, M2)
11	380120J	FITTING SPRING/ THERMISTOR (M1, M2)	63	2535270	SHIELD PLATE (2) ASSY. (M1, M2)
12	2530534	CROSS FLOW FAN ASSY. (M1, M2)	64	2535253	FRONT GRILLE (SIDE PANEL) L (M1, M2)
13	051605J	HEX SOCKET SCREW (M1, M2)	65	2535254	FRONT GRILLE (DECORATION PANEL) L (M1, M2)
14	2530204	DISCH. GRILLE HOR. BLADE (MAIN) (M1, M2)	66	2535256	SUPPORT PLATE (M1, M2)
15	1840922	ROD/ HORIZONTAL VANE (M1, M2)	67	2530198	DRAIN PAN ASSY. (M1, M2)
16	2530205	DISCH. GRILLE HOR. BLADE (SUB) (M1, M2)	68	2535240	AIR OUTLET (STABILIZER) ASSY. (M1, M2)
17	1840922	ROD/ HORIZONTAL VANE (M1, M2)	69	2535249	GEAR CASE (V-BLADE) (M1, M2)
18	2535227	SWITCH BOX (M1, M2)	70	2535250	GEAR (LACK) (M1, M2)
19	NA	EARTH WIRE (M1, M2)	71	NA	DRAIN PAN (UNDER COVER) (M1, M2)
20	2535230	EARTH WIRE (TERMINAL STRIP) (M1, M2)	72	2535247	GEAR (MOTOR) (M1, M2)
21	2535231	EARTH WIRE (POWER PCB) (M1, M2)	73	2530199	DISCH. GRILLE VERT. BLADE (AUTO) (M1, M2)
22	2535233	WIRELESS LAN MODULE (M1, M2)	74	NA	TAPPING SCREW (M1, M2)
23	2530195	WIRE HARNESS (WIRE LESS LAN ADAPTOR) (M1, M2)	75	2535241	CONNECTING ROD (V-BLADE) (M1, M2)
24	2535234	WIRELESS LAN PCB BOX (M1, M2)	76	2530200	DRAIN HOSE (M1, M2)
25	2535235	WIRELESS LAN PCB COVER (M1, M2)	77	2535242	DRAIN PAN ARM (M1, M2)
26	2530196	PRINTED CIRCUIT BOARD ASSY. (M1, M2)	78	6028456	DRAIN PLUG (M1, M2)
27	4016176	PYROELECTRIC PASSIVE INFRARED SENSOR (M1, M2)	79	2535251	FAN GUARD ASSY. (M1, M2)
28	2530593	WIRE HARNESS (FOR DISPLAY PCB) (M1, M2)	80	NA	CAUTION LABEL (M1, M2)
29	2534970	PRINTED CIRCUIT BOARD ASSY. (M1, M2)	81	2535243	GEAR CASE (BASE)(H_BLADE) (M1, M2)
30	2530197	WIRE HARNESS (PPI SENSOR) (M1, M2)	82	2535244	GEAR CASE (COVER)(H_BLADE) (M1, M2)
31	2535236	INDICATION LAMP COVER (M1, M2)	83	2535245	GEAR SHAFT (H_BLADE) (M1, M2)
32	153875J	FUSE (M1, M2)	84	2535246	GEAR 1 (H_BLADE) (M1, M2)
33	2535269	INDICATION LAMP COVER BASE (M1, M2)	85	2535247	GEAR (MOTOR) (M1, M2)
34	2530536	FAN MOTOR ASSY. (M1, M2)	86	2535248	SHAFT (H_BLADE) (M1, M2)
35	2490298	HUMIDITY SENSOR (M1, M2)	87	1906543	STEPPING MOTOR (M1, M2)
36	2495419	WIRE HARNESS (HIGH VOLTAGE) (M1, M2)	88	2511102	WIRE HARNESS ASSY. (M1, M2)
37	2530594	WIRE HARNESS (LOW VOLTAGE) (M1, M2)	89	2535262	DRIP PROOF PLATE (M1, M2)
38	NA	EARTH WIRE (M1, M2)	90	2535257	SEALING PLATE (TOP) (M1, M2)
39	2533924	WIRE HARNESS (SENSOR) (M1, M2)	91	2535263	REMOTE CONTROLLER ASSY. (WITH LABEL) (M1, M2)
40	2535237	CONDUIT MOUNTING PLATE (M1, M2)	92	NA	PRODUCT LIABILITY CAUTION LABEL (M1, M2)
41	2534971	PRINTED CIRCUIT BOARD ASSY. (CONTROL) (M1)	93	NA	CAUTION LABEL (FLAMMABLE GAS) (M1, M2)
41	2534972	PRINTED CIRCUIT BOARD ASSY. (CONTROL) (M2)	94	NA	CAUTION LABEL (HIGH VOLTAGE) (M1, M2)
42	2490414	THERMISTOR ASSY. (M1, M2)	95	5004122	HOLDER/ REMOTE CONTROLLER (M1, M2)
43	2444389	INSULATION SHEET (RADIATION) (M1, M2)	96	NA	SCREW SET (M1, M2)
44	2535228	SHIELD PLATE (1) (M1, M2)	97	NA	BATTERY KIT (M1, M2)
45	2535267	MOUNTING PLATE (TERMINAL STRIP) (M1, M2)	98	2535265	ACCESSORY SET (SCREW COVER) (M1, M2)
46	2535268	SHIELD PLATE (TERMINAL REAR) (M1, M2)	99	081957J	HEAT INSULATION TAPE (M1, M2)
47	1907786	TERMINAL BLOCK (M1, M2)	100	4017130	PHOTOCATALYST FILTER ASSY. (M1, M2)
48	0812847	WIRE CLAMP (M1, M2)	101	1597259	DUST COLLECTING ELEMENT FRAME (M1, M2)
49	2534975	WIRE HARNESS (POWER SUPPLY) (M1, M2)	102	2535266	INSTALLATION PLATE LETTER (M1, M2)
50	2535238	BOTTOM FRAME ASSY. (M1, M2)			
51	2535258	MOTOR COVER (CAP) (M1, M2)			
52	2535239	FAN BEARING VIBRATION ABSORBER (M1, M2)			

FTXM[09,12]VVJU

Ref. Part

No: No:

Description:

Ref. Part

No: No:

Description:

Expanded Model Nomenclature

M1 - FTXM09VVJU

M2 - FTXM12VVJU

M3 - FTXM18VVJU

M4 - FTXM24VVJU

FTXM18VVJU / FTXM24VVJU

—TOP—

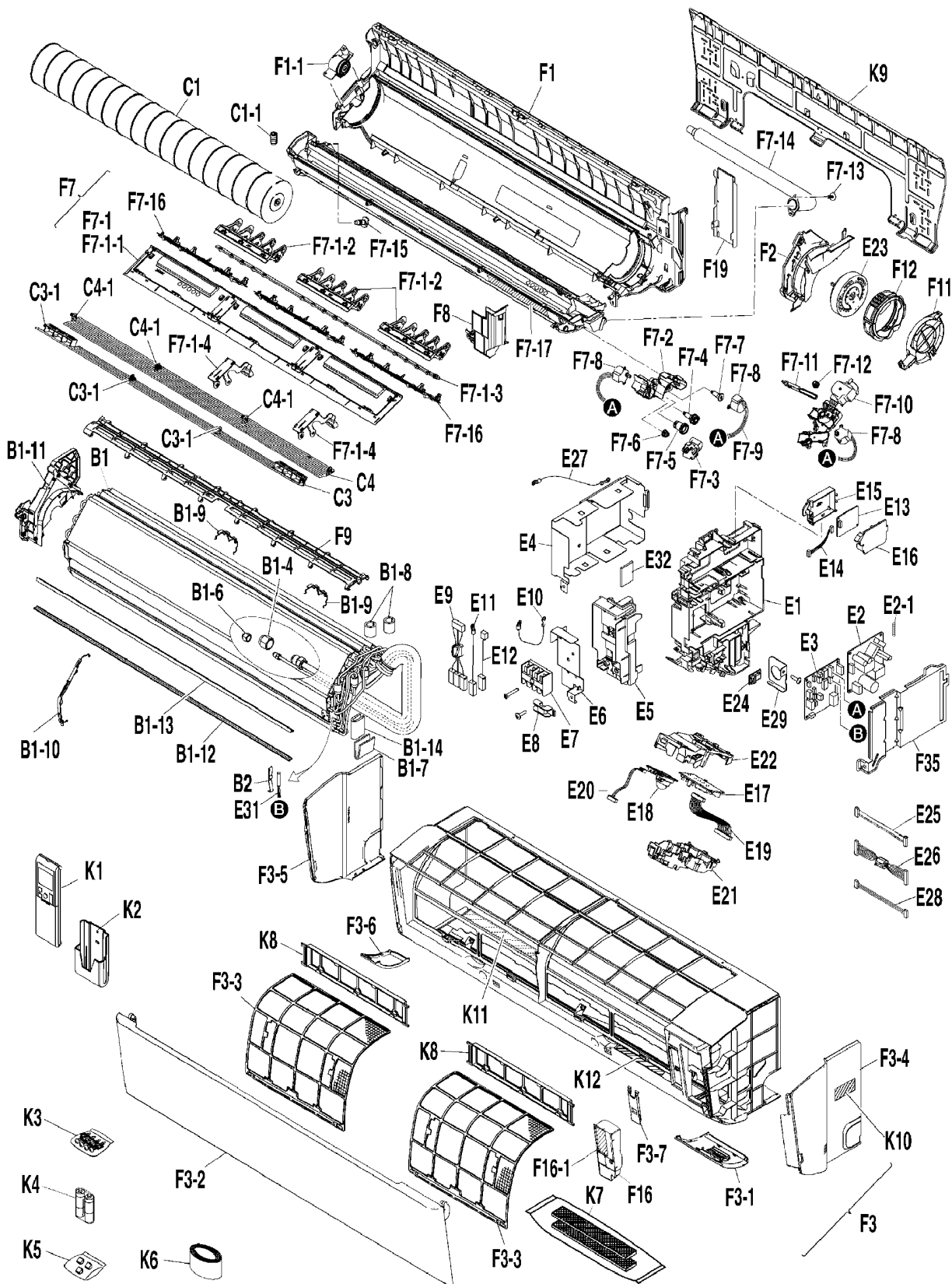

Reference #	Drawing #
1	B1
2	B1-10
3	B1-11
4	B1-12
5	B1-13
6	B1-14
7	B1-4
8	B1-6
9	B1-7
10	B1-8
11	B1-9
12	B2
13	C1
14	C1-1
15	C3
16	C3-1
17	C4
18	C4-1
19	E1
20	E10
21	E11
22	E12
23	E13
24	E14
25	E15
26	E16
27	E17
28	E18
29	E19
30	E2
31	E20
32	E21
33	E2-1
34	E22
35	E23
36	E24
37	E25
38	E26
39	E27
40	E28
41	E29
42	E3
43	E31
44	E32
45	E4
46	E5
47	E6
48	E7
49	E8
50	E9
51	F1
52	F11
53	F1-1
54	F12
55	F16
56	F16-1
57	F19
58	F2
59	F3
60	F3-1
61	F3-2
62	F3-3
63	F3-4
64	F35
65	F3-5
66	F3-6
67	F3-7
68	F7
69	F7-1
70	F7-10
71	F7-11
72	F7-1-1
73	F7-12
74	F7-1-2
75	F7-13
76	F7-1-3
77	F7-14
78	F7-1-4
79	F7-15
80	F7-16
81	F7-17
82	F7-2
83	F7-3
84	F7-4
85	F7-5
86	F7-6
87	F7-7
88	F7-8
89	F7-9
90	F8
91	F9
92	K1
93	K10
94	K11
95	K12
96	K2
97	K3
98	K4
99	K5
100	K6
101	K7
102	K8
103	K9

FTXM[18,24]VVJU

Ref. Part No: No:	Description:	Ref. Part No: No:	Description:
Image 1:		Image 1:	
1 2534968	HEAT EXCHANGER ASSY. (M3)	52 2535258	MOTOR COVER (CAP) (M3, M4)
1 2534969	HEAT EXCHANGER ASSY. (M4)	53 2535239	FAN BEARING VIBRATION ABSORBER (M3, M4)
2 NA	WIRE SPRING ASSY. (8 STAGE) (M3, M4)	54 2490609	VIBRATIONISOLATOR (M3, M4)
3 NA	SIDE PANEL (LEFT) (M3, M4)	55 2535260	SERVICE COVER (M3, M4)
4 NA	SEALING PLATE (HEAT EXCHANGER) (M3, M4)	56 NA	CAUTION LABEL (ELECTRIC SHOCK) (M3, M4)
5 NA	SEALING PLATE (H/E BENDING) (M3, M4)	57 2535261	PIPING FIXTURE (M3, M4)
6 NA	PUTTY (M3, M4)	58 2535259	SIDE PANEL (RIGHT) ASSY. (M3, M4)
7 119849J	FLARE NUT (M3)	59 2534978	FRONT GRILLE ASSY. (M3, M4)
7 119850J	FLARE NUT (M4)	60 2535255	CONTROL PANEL ASSY. (M3, M4)
8 1723546	FLARE NUT (M3, M4)	61 2534862	PANEL ASSY. (M3, M4)
9 NA	PUTTY (M3, M4)	62 2534863	AIR FILTER (M3, M4)
10 NA	PUTTY (M3, M4)	63 2535252	FRONT GRILLE (SIDE PANEL) R (M3, M4)
11 NA	WIRE SPRING ASSY. (4 STAGE) (M3, M4)	64 2535270	SHIELD PLATE (2) ASSY. (M3, M4)
12 380120J	FITTING SPRING/ THERMISTOR (M3, M4)	65 2535253	FRONT GRILLE (SIDE PANEL) L (M3, M4)
13 2533898	CROSS FLOW FAN ASSY. (M3, M4)	66 2535254	FRONT GRILLE (DECORATION PANEL) L (M3, M4)
14 051605J	HEX. SOCKET SCREW (M3, M4)	67 2535256	SUPPORT PLATE (M3, M4)
15 2534864	DISCH. GRILLE HOR. BLADE (MAIN) (M3, M4)	68 2534859	DRAIN PAN ASSY. (M3, M4)
16 1840922	ROD/ HORIZONTAL VANE (M3, M4)	69 2535275	AIR OUTLET (STABILIZER) ASSY. (M3, M4)
17 2534865	DISCH. GRILLE HOR. BLADE (SUB) (M3, M4)	70 2535249	GEAR CASE (V-BLADE) (M3, M4)
18 1840922	ROD/ HORIZONTAL VANE (M3, M4)	71 2535250	GEAR (LACK) (M3, M4)
19 2535227	SWITCH BOX (M3, M4)	72 NA	DRAIN PAN (UNDER COVER) (M3, M4)
20 NA	EARTH WIRE (M3, M4)	73 2535247	GEAR (MOTOR) (M3, M4)
21 2535230	EARTH WIRE (TERMINAL STRIP) (M3, M4)	74 2534860	DISCHARGE GRILLE VERT. BLADE (M3, M4)
22 2535231	EARTH WIRE (POWER PCB) (M3, M4)	75 NA	TAPPING SCREW (M3, M4)
23 2535233	WIRELESS LAN MODULE (M3, M4)	76 2535276	CONNECTING ROD (V-BLADE) (M3, M4)
24 2530195	WIRE HARNESS (WIRE LESS LAN ADAPTOR) (M3, M4)	77 2530200	DRAIN HOSE (M3, M4)
25 2535234	WIRELESS LAN PCB BOX (M3, M4)	78 2535242	DRAIN PAN ARM (M3, M4)
26 2535235	WIRELESS LAN PCB COVER (M3, M4)	79 6028456	DRAIN PLUG (M3, M4)
27 2530196	PRINTED CIRCUIT BOARD ASSY. (M3, M4)	80 2535277	FAN GUARD ASSY. (M3, M4)
28 2533895	PRINTED CIRCUIT BOARD ASSY. (M3, M4)	81 NA	CAUTION LABEL (M3, M4)
29 2530593	WIRE HARNESS (FOR DISPLAY PCB) (M3, M4)	82 2535243	GEAR CASE (BASE)(H_BLADE) (M3, M4)
30 2534970	PRINTED CIRCUIT BOARD ASSY. (M3, M4)	83 2535244	GEAR CASE (COVER)(H_BLADE) (M3, M4)
31 2533896	WIRE HARNESS (MP MOTION SENSOR) (M3, M4)	84 2535245	GEAR SHAFT (H_BLADE) (M3, M4)
32 2535236	INDICATION LAMP COVER (M3, M4)	85 2535246	GEAR 1 (H_BLADE) (M3, M4)
33 153875J	FUSE (M3, M4)	86 2535247	GEAR (MOTOR) (M3, M4)
34 2535269	INDICATION LAMP COVER BASE (M3, M4)	87 2535248	SHAFT (H_BLADE) (M3, M4)
35 2535273	FAN MOTOR ASSY. (M3, M4)	88 1906543	STEPPING MOTOR (M3, M4)
36 2490298	HUMIDITY SENSOR (M3, M4)	89 2511102	WIRE HARNESS ASSY. (M3, M4)
37 2495419	WIRE HARNESS (HIGH VOLTAGE) (M3, M4)	90 2535262	DRIP PROOF PLATE (M3, M4)
38 2530594	WIRE HARNESS (LOW VOLTAGE) (M3, M4)	91 2535278	SEALING PLATE (TOP) (M3, M4)
39 NA	EARTH WIRE (M3, M4)	92 2535279	REMOTE CONTROLLER ASSY. (WITH LABEL) (M3, M4)
40 2533924	WIRE HARNESS (SENSOR) (M3, M4)	93 NA	PRODUCT LIABILITY CAUTION LABEL (M3, M4)
41 2535237	CONDUIT MOUNTING PLATE (M3, M4)	94 NA	CAUTION LABEL (FLAMMABLE GAS) (M3, M4)
42 2534973	PRINTED CIRCUIT BOARD ASSY. (CONTROL) (M3)	95 NA	CAUTION LABEL (HIGH VOLTAGE) (M3, M4)
42 2534974	PRINTED CIRCUIT BOARD ASSY. (CONTROL) (M4)	96 5004122	HOLDER/ REMOTE CONTROLLER (M3, M4)
43 2490414	THERMISTOR ASSY. (M3, M4)	97 NA	SCREW SET (M3, M4)
44 2444389	INSULATION SHEET (RADIATION) (M3, M4)	98 NA	BATTERY KIT (M3, M4)
45 2535228	SHIELD PLATE (1) (M3, M4)	99 2535281	ACCESSORY SET (SCREW COVER) (M3, M4)
46 2535267	MOUNTING PLATE (TERMINAL STRIP) (M3, M4)	100 081957J	HEAT INSULATION TAPE (M3, M4)
47 2535268	SHIELD PLATE (TERMINAL REAR) (M3, M4)	101 4017130	PHOTOCATALYST FILTER ASSY. (M3, M4)
48 1907786	TERMINAL BLOCK (M3, M4)	102 1597259	DUST COLLECTING ELEMENT FRAME (M3, M4)
49 0812847	WIRE CLAMP (M3, M4)	103 2535280	INSTALLATION PLATE LETTER (M3, M4)
50 2534975	WIRE HARNESS (POWER SUPPLY) (M3, M4)		
51 2535274	BOTTOM FRAME ASSY. (M3, M4)		

FTXM[18,24]VVJU

Ref. Part

No: No:

Description:

Ref. Part

No: No:

Description:

Expanded Model Nomenclature

M1 - FTXM09VVJU

M2 - FTXM12VVJU

M3 - FTXM18VVJU

M4 - FTXM24VVJU