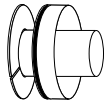
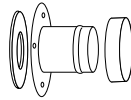

Spin-In Takeoff

1 Ea./Box

Part No.	Duct	Plenum
UPC-22	2.0" (50)	Fbrgls, 1.5"
UPC-23B	2.0" (50)	Fbrgls, 1"

Metal Takeoff Pkg

Includes tape ring and gasket

1 Ea./Box

Part No.	Duct	Plenum
UPC-28	2.0" (50)	Metal, rnd
UPC-28F	2.0" (50)	Metal, flat
UPC-228	2.5" (63)	Metal, rnd
UPC-228F	2.5" (63)	Metal, flat

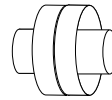
Supply Duct Coupling

Includes supply clamps and tape rings

10 Ea./Box

Part No.	Duct
UPC-38C-10	2.0" (50)
UPC-238C-10	2.5" (63)

Winter Shutoff (2")

20 Ea./Box

Part No.	Duct
UPC-42-20	2.0" (50)
UPC-242-20	2.5" (63)

Mild Weather Kit

For heat pumps operating in mild weather.

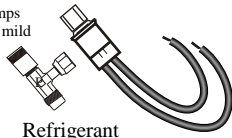

Part No.	Refrigerant
UPC-65	R-22/407C
UPC-65X	R-410A

1 Ea./Box

Outlet Hardware Pkg

Each set includes

- 1 - Toggle
- 1 - Screw, #4-24 x 1.5

UPC-51 12 sets/Pkg

Clamp Pliers

UPC-54 1 Ea./Box

Tubing Clamp

50 Ea./Box

Part No.	Duct Dia	Type
UPC-52-50	2.0" (50)	AL Supply
UPC-53-50	2.0" (50)	Attenuator
UPC-252-50	2.5" (63)	AL Supply
UPC-253-50	2.5" (63)	Attenuator

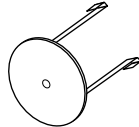
Outlet Deflector

5 Ea./Box

Part No.	Duct
UPC-45-5	2.0" (50)
UPC-245-5	2.5" (63)

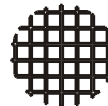
Outlet Screen

20 Ea./Box

Part No.	Duct	Color
UPC-88-20	2.0" (50)	WHITE
UPC-88-20-BLK	2.0" (50)	BLACK
UPC-288-20	2.5" (63)	WHITE
UPC-288-20-BLK	2.5" (63)	BLACK

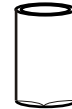
Fiberglass Ductboard Hole Cutter

5 Ea./Box

Part No.	Duct
UPC-55-5	2.0" (50)

Round Outlet, Plastic (Air Register)

Includes: toggles screws attenuator clamp ceiling gasket

Standard: White

1 Ea./Box

Part No.	Duct Dia
UPC-56B	2.0" (50)
UPC-256	2.5" (63)

Optional finishes
-BLK (Black)
-BRS (Brass)
-CHR (Chrome)**Round Outlet, Wood (Air Register)**

Standard: Red Oak (unfinished)

Includes: outlet screen attenuator clamp

1 Ea./Box

Part No.	Duct Dia
UPC-57	2.0" (50)
UPC-257	2.5" (63)

Wood species available

- B (Birch)
- C (Cherry)
- K (Knotty Pine)
- MA (Maple)
- MH (Mahogany)
- PI (Pine)
- PO (Poplar)
- RO (Red Oak)
- WL (Walnut)
- WO (White Oak)

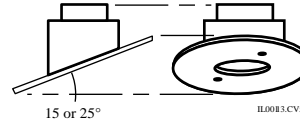
Round Outlet, Sloped Ceiling, Plastic

15 or 25°

IL0081.CVS

Includes: toggles screws attenuator clamp ceiling gasket

Standard: White

1 Ea./Box

Part No.	Duct Dia	Angle
UPC-58-1-15	2.0" (50)	15°
UPC-58-1-25	2.0" (50)	25°

Plenum Outlet

Mounts directly to plenum

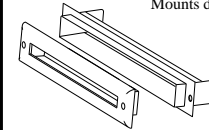

1 Ea./Box

Includes: mounting bracket screws trim plate (white is standard)

UPC-101

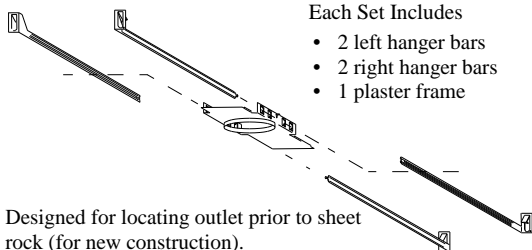
Optional finishes
-BLK (Black)
-BRS (Brass)
-CHR (Chrome)**Plaster Frame Kit**

Each Set Includes

- 2 left hanger bars
- 2 right hanger bars
- 1 plaster frame

Designed for locating outlet prior to sheet rock (for new construction).

Part No.	Duct Size
UPC-86-5	2.0" (50)
UPC-286-5	2.5" (63)

5 Sets/Box

Slotted OutletUPC-66 (Metal)
UPC-67A (Plastic)
UPC-68 (Plastic)

- factory insulated
- fits in standard 2 x 4 construction
- includes mounting bracket with hanger bars
- includes a white plastic trim plate, also available in metallic silver, brass, or unfinished wood.

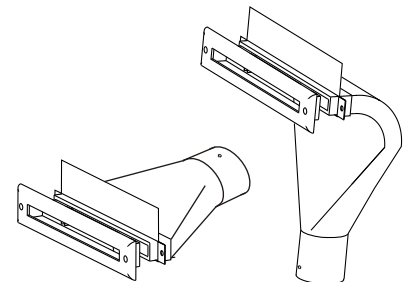

UPC-68

UPC-66/67A

1 Ea./Box