

NCP SPLIT SYSTEM SERIES

1000 | 3000 | 4000 | 5000

Go Thru-the-Wall

**NATIONAL
COMFORT
PRODUCTS**

HEATING & A/C EQUIPMENT



Thru-the-Wall Comfort for all types of Multi-Family Construction

Features

- Units are compatible with NCP Air Handlers, Coils or certain other air handlers with ECM motors
- Available in 1.5 to 2.5 ton sizes
- Heavy-duty water resistant cabinet
- R-410A high efficiency compressor
- Easy access to condenser fan
- High efficiency condenser fan motor
- High efficiency condenser coil
- Brass services valves

Why Thru-the Wall?

- Easily serviced in any weather
- Less expensive installations
- Ground clutter elimination
- No theft or vandalism
- Less refrigerant charge
- No roof penetration
- Short copper tube runs
- Separate meter savings
- Better appearance

THRU THE WALL SPLIT SYSTEM CONDENSING UNITS

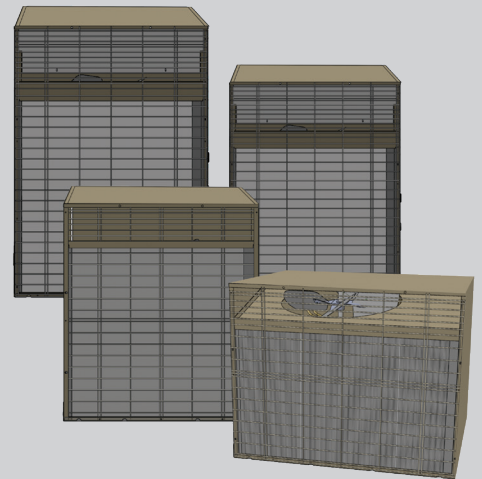

NCP Split System Series
1000 | 3000 | 4000 | 5000

Meets All
2023 DOE Requirements

**NATIONAL
COMFORT
PRODUCTS**
HEATING & A/C EQUIPMENT

National Comfort Products
A Division of National Refrigeration and Air Conditioning Products, Inc.
539 Dunksferry Road • Bensalem, PA 19020-5908
(800) 523-7138 • Fax (215) 639-1674
www.NationalComfortProducts.com



1000 Series w/ matches up to 12.5 SEER2*

All Units 208/230-1~~60Hz					
Model	Shipping weight (lbs)	Compressor		MCA	MOP
		RLA	LRA		
NCP4181000A-**	160	10.3	45.7	14.20	20
NCP4241000A-**	165	11.7	59.5	15.90	25
NCP4301000A-**	Coming Soon				
Cond. Fan Motor Specs		418/424		1/4 HP, 1600 RPM, 1.3 FLA	
Condenser Coil Specs		3.61 ft² Face Area, 16 FPI			
Dimensions		26 1/4" W x 28 5/8" H x 18 1/2" D			
Liquid Valve		3/8"	Suction Valve		3/4"

*When matched with NAH4**MF Air Handler

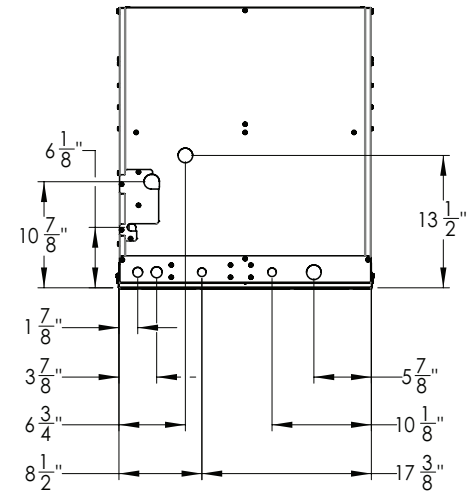
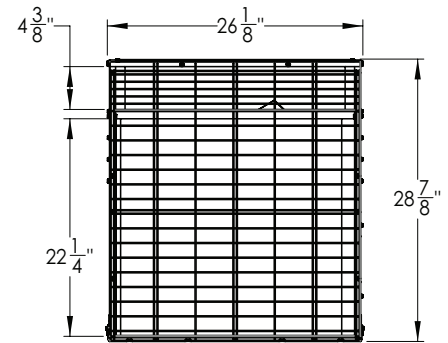
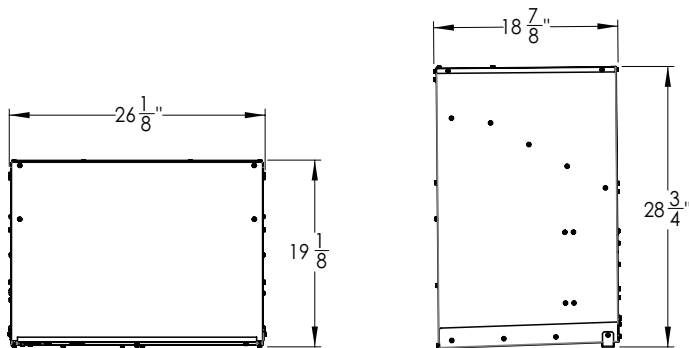

3000 Series w/ matches up to 12.5 SEER2*

All Units 208/230-1~60Hz					
Model	Shipping weight (lbs)	Compressor		MCA	MOP
		RLA	LRA		
NCP4183000A-**	160	10.3	45.7	14.20	20
NCP4243000A-**	165	11.7	59.5	15.90	25
NCP4303000A-**	Coming Soon				
Cond. Fan Motor Specs		418/424		1/4 HP, 1600 RPM, 1.3 FLA	
Condenser Coil Specs		3.77 ft² Face Area, 16 FPI			
Dimensions		24 1/8" W x 32" H x 18 1/2" D			
Liquid Valve		3/8"	Suction Valve		3/4"

*When matched with NAH4**MF Air Handler

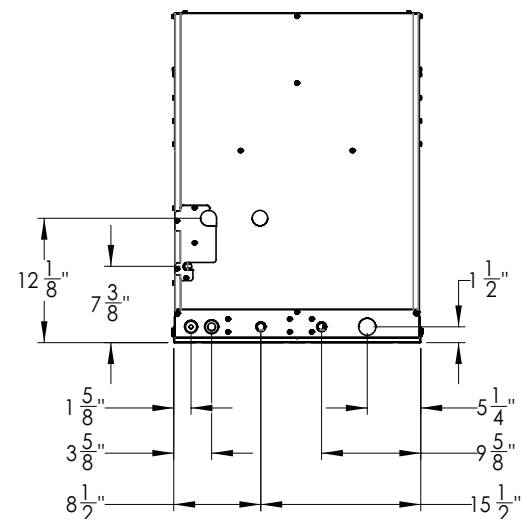
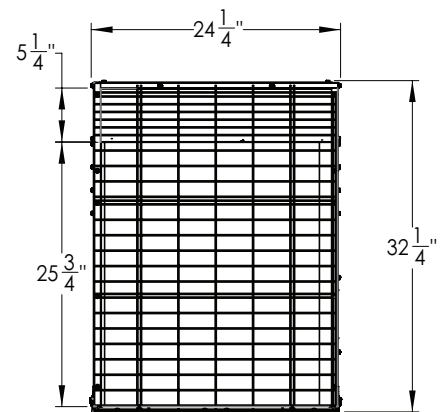
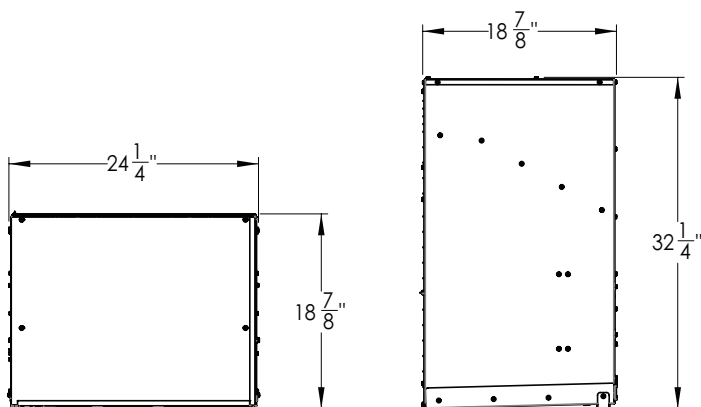

4000 Series w/ matches up to 12.5 SEER2*

All Units 208/230-1~60Hz

Model	Shipping weight (lbs)	Compressor		MCA	MOP
		RLA	LRA		
NCP4184000A-**	160	10.3	45.7	14.70	20
NCP4244000A-**	170	11.7	59.5	16.40	25
NCP4304000A-**	Coming Soon				
Cond. Fan Motor Specs		1/5 HP, 1650 RPM, 1.8 FLA			
Condenser Coil Specs		3.14 ft² Face Area, 16 FPI			
Dimensions		30" W x 23" H x 22 1/2" D			
Liquid Valve		3/8"	Suction Valve	3/4"	

*When matched with NAH4**MF Air Handler

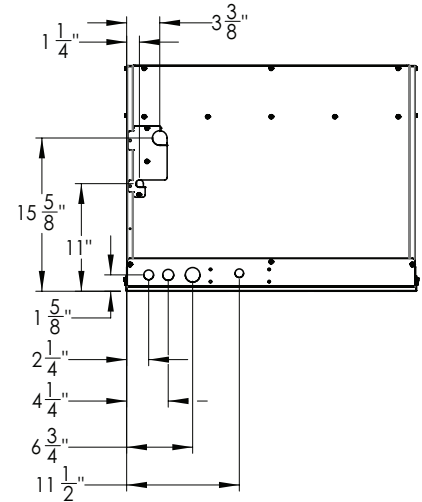
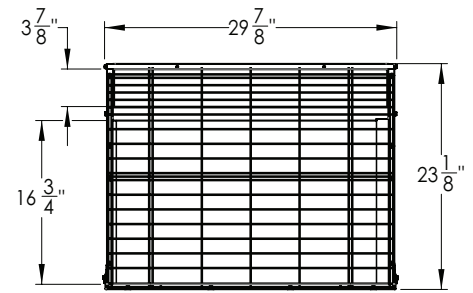
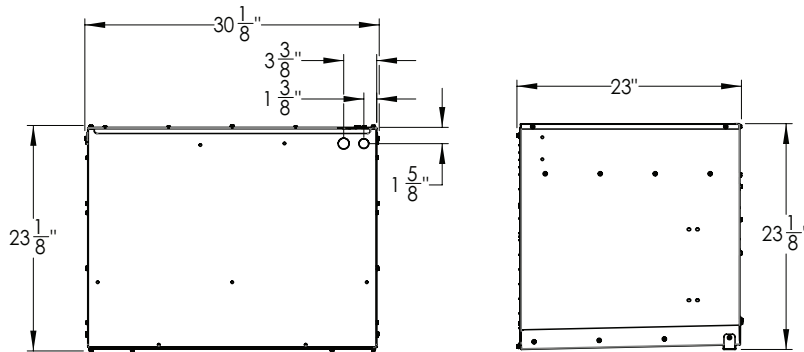

5000 Series w/ matches up to 14 SEER2*

All Units 208/230-1~60Hz

Model	Shipping weight (lbs)	Compressor		MCA	MOP
		RLA	LRA		
NCP4185000A-**	170	10.3	45.7	14.68	20
NCP4245000A-**	185	11.5	59.5	16.18	25
NCP4305000A-**	190	14.1	67.9	19.43	30
Cond. Fan Motor Specs		1/5 HP, 1650 RPM, 1.8 FLA			
Condenser Coil Specs		418		4.59 ft² Face Area 16 FPI	
		424/430		4.59 ft² Face Area 14 FPI	
Dimensions		26 7/8 W" x 38 7/8" H x 18 1/2" D			
Liquid Valve		3/8"	Suction Valve		3/4"

*When matched with NAH4**MF Air Handler

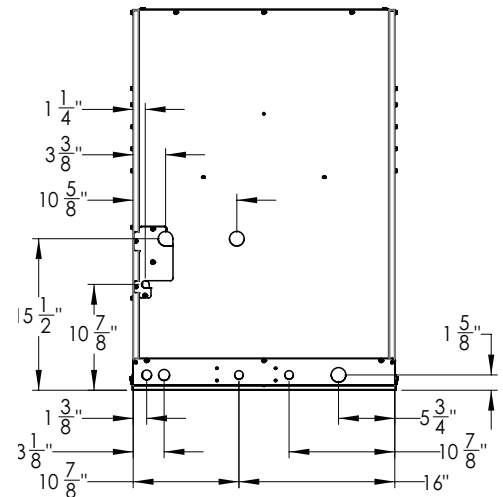
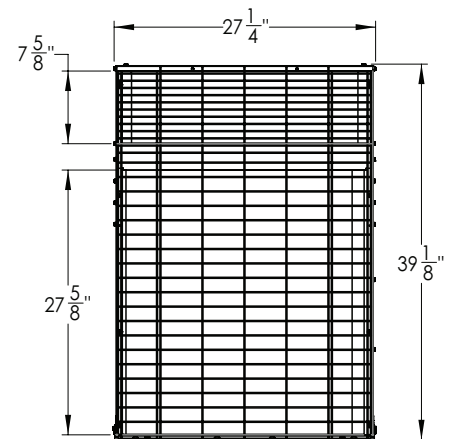
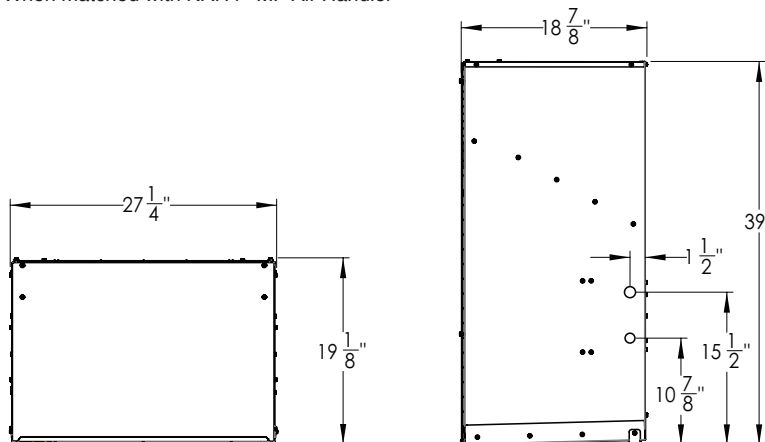

Split System Series

Nomenclature 2023

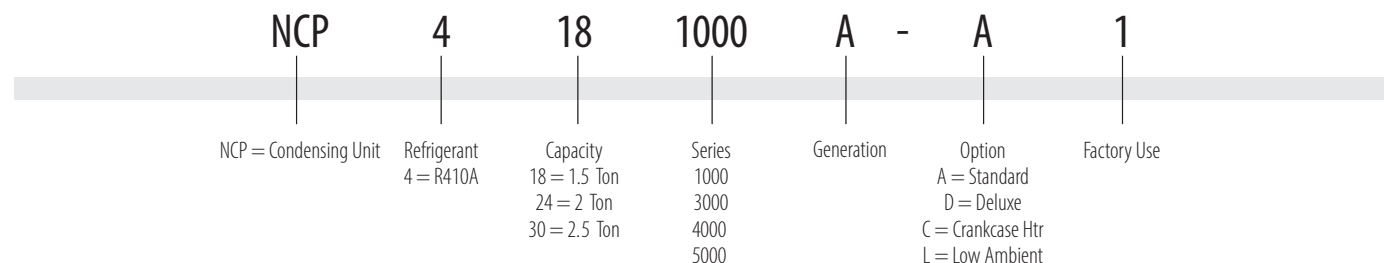

Matching Air Handlers						
Outdoor Model	Indoor Model	Rated EER ²	Rated Capacity	Nominal Airflow ² (SCFM)	SEER ²	Replaces
1000 Series						
NCP4181000A-**-	NAH424MFA-**-	11	18000	600	12.5	Bryant, Carrier, Day & Night, Dunham-Bush, Lennox, Magic Chef, Meyer, Payne, First Co., U.S. A/C (BB)
NCP4241000A-**-	NAH430MFA-**-	11	22600	790	12.5	
3000 Series						
NCP4183000A-**-	NAH424MFA-**-	11	18000	600	13	Carrier, Fedders, Dunham-Bush, Lennox, Magic Chef, Meyer, Rheem, First Co., U.S. A/C (AB)
NCP4243000A-**-	NAH430MFA-**-	11	23000	790	13	
4000 Series						
NCP4184000A-**-	NAH424MFA-**-	11	18000	600	12.5	Dunham-Bush, Hydro-Therm Space Pack, Lennox, Luxaire York, First Co., U.S. A/C (CB)
NCP4244000A-**-	NAH430MFA-**-	11	23000	790	12.5	
5000 Series						
NCP4185000A-**-	NAH424MFA-**-	12	18000	600	14	First Co. (WMU)
NCP4245000A-**-	NAH430MFA-**-	12	24000	790	14	
NCP4305000A-**-	NAH430MFA-**-	11.5	28400	950	13.5	

Matching Cased Coils					
Outdoor Model	Indoor Model	Rated EER ²	Rated Capacity	Nominal Airflow ² (SCFM)	SEER ²
1000 Series					
NCP4181000A-**-	NCC418AA-*	10.2	18000	620	11.7
NCP4241000A-**-	NCC424AA-*	10.5	22600	820	11.7
3000 Series					
NCP4183000A-**-	NCC418AA-*	10.2	18000	620	11.7
NCP4243000A-**-	NCC424AA-*	10.5	22600	820	11.7
4000 Series					
NCP4184000A-**-	NCC418AA-*	10.5	18000	620	11.7
NCP4244000A-**-	NCC424AA-*	10.5	22600	820	11.7
5000 Series					
NCP4185000A-**-	NCC418AA-*	11	18500	620	12
NCP4245000A-**-	NCC424AA-*	11	24000	820	12
NCP4305000A-**-	NCC430AA-*	10.5	28000	920	12



National Comfort Products
 A Division of National Refrigeration and Air Conditioning Products, Inc.
 539 Dunksferry Road • Bensalem, PA 19020-5908
 (800) 523-7138 • Fax (215) 639-1674
www.NationalComfortProducts.com



All specifications are subject to change without notice.

Spec NCP Split System Series 2/2023