

**Revision C:**

• MSZ-EF09/12/15/18NAW/B/S- **U2** have been added.

OBB736 REVISED EDITION-B is void.

# INDOOR UNIT

# PARTS CATALOG

**No. OBB736**  
REVISED EDITION-C

## Models

<b>MSZ-EF09NAW</b> - <b>U1</b> , <b>U2</b>	<b>MSZ-EF12NAW</b> - <b>U1</b> , <b>U2</b>
<b>MSZ-EF15NAW</b> - <b>U1</b> , <b>U2</b>	<b>MSZ-EF18NAW</b> - <b>U1</b> , <b>U2</b>
<b>MSZ-EF09NAB</b> - <b>U1</b> , <b>U2</b>	<b>MSZ-EF12NAB</b> - <b>U1</b> , <b>U2</b>
<b>MSZ-EF15NAB</b> - <b>U1</b> , <b>U2</b>	<b>MSZ-EF18NAB</b> - <b>U1</b> , <b>U2</b>
<b>MSZ-EF09NAS</b> - <b>U1</b> , <b>U2</b>	<b>MSZ-EF12NAS</b> - <b>U1</b> , <b>U2</b>
<b>MSZ-EF15NAS</b> - <b>U1</b> , <b>U2</b>	<b>MSZ-EF18NAS</b> - <b>U1</b> , <b>U2</b>

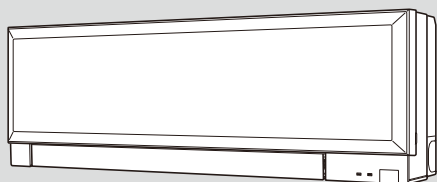

## CONTENTS

1. SERVICE PARTS LIST .....	2
2. OPTIONAL PARTS .....	14

**SERVICE MANUAL (OBH736)**

## Revision A:

- Part numbers of the conduit cover and conduit plate have been changed.

## Revision B:

- Indoor heat exchanger for **MSZ-EF09/12/15/18NAB-U1**, **MSZ-EF09/12/15/18NAS-U1** and **MSZ-EF09/12/15/18NAW-U1** have been changed.

## Revision C:

- **MSZ-EF09/12/15/18NAW/B/S-U2** have been added.

# 1

## SERVICE PARTS LIST

<b>MSZ-EF09NAW - U1</b>	<b>MSZ-EF12NAW - U1</b>	<b>MSZ-EF15NAW - U1</b>	<b>MSZ-EF18NAW - U1</b>
<b>MSZ-EF09NAB - U1</b>	<b>MSZ-EF12NAB - U1</b>	<b>MSZ-EF15NAB - U1</b>	<b>MSZ-EF18NAB - U1</b>
<b>MSZ-EF09NAS - U1</b>	<b>MSZ-EF12NAS - U1</b>	<b>MSZ-EF15NAS - U1</b>	<b>MSZ-EF18NAS - U1</b>

### 1-1. INDOOR UNIT STRUCTURAL PARTS

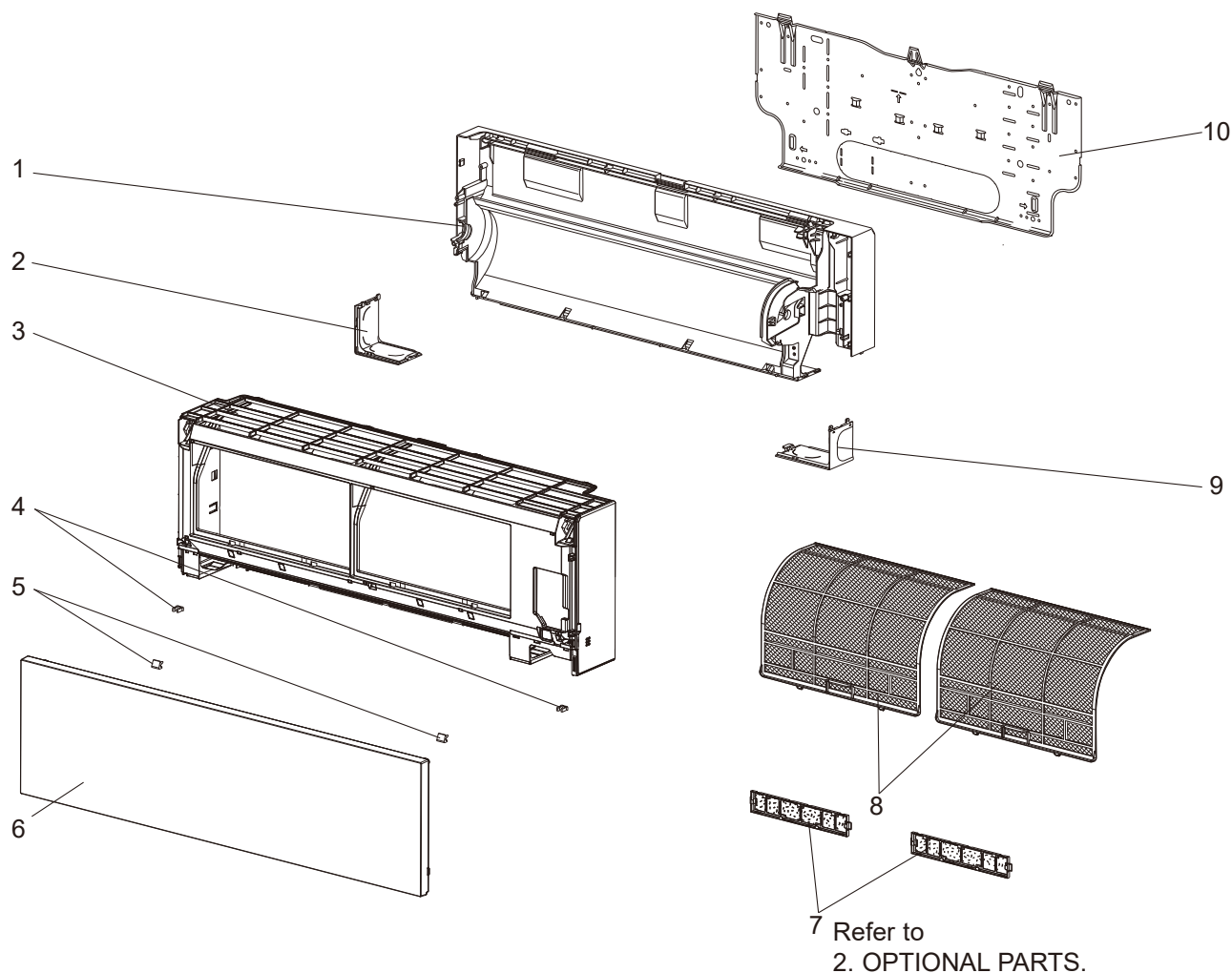

### 1-2. ACCESSORY AND REMOTE CONTROLLER

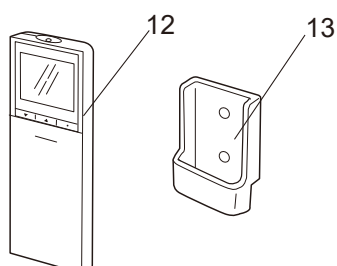

## 1-1. INDOOR UNIT STRUCTURAL PARTS

1. The part quantity below indicates the required number of pieces per unit.
2. The circled No. indicates that the part is not shown in the figure.

No.	Part No.	Part name	MSZ-EF09NAW-U1	MSZ-EF09NAB-U1	MSZ-EF09NAS-U1	MSZ-EF12NAW-U1	MSZ-EF12NAB-U1	MSZ-EF12NAS-U1	MSZ-EF15NAW-U1	MSZ-EF15NAB-U1	MSZ-EF15NAS-U1	MSZ-EF18NAW-U1	MSZ-EF18NAB-U1	MSZ-EF18NAS-U1	Symbol in Wiring Diagram	Remarks
1	E22 F95 234	BOX ASSEMBLY	1			1			1			1				
1	E22 G21 234	BOX ASSEMBLY		1			1			1			1			
1	E22 G26 234	BOX ASSEMBLY			1			1			1			1		
2	E22 T21 976	CORNER BOX LEFT	1			1			1			1				
2	E22 T25 976	CORNER BOX LEFT		1			1			1			1			
2	E22 T29 976	CORNER BOX LEFT			1			1			1			1		
3	E22 T21 000	PANEL ASSEMBLY	1			1			1			1				Includes No. 4, 5 and 6
3	E22 T25 000	PANEL ASSEMBLY		1			1			1			1			Includes No. 4, 5 and 6
3	E22 T29 000	PANEL ASSEMBLY			1			1			1			1		Includes No. 4, 5 and 6
4	E22 F95 142	CATCH	2	2	2	2	2	2	2	2	2	2	2	2		2 PCS/SET
5	E22 F95 067	SCREW CAP	2			2			2			2				2 PCS/SET
5	E22 G21 067	SCREW CAP		2			2			2			2			2 PCS/SET
5	E22 G26 067	SCREW CAP			2			2			2			2		2 PCS/SET
6	E22 T21 010	FRONT PANEL	1			1			1			1				
6	E22 T25 010	FRONT PANEL		1			1			1			1			
6	E22 T29 010	FRONT PANEL			1			1			1			1		
7	—	AIR CLEANING FILTER	2	2	2	2	2	2	2	2	2	2	2	2		1 PC/SET
8	E22 F95 100	NANO PLATINUM FILTER	2	2	2	2	2	2	2	2	2	2	2	2		1 PC/SET
9	E22 T21 975	CORNER BOX RIGHT	1			1			1			1				
9	E22 T25 975	CORNER BOX RIGHT		1			1			1			1			
9	E22 T29 975	CORNER BOX RIGHT			1			1			1			1		
10	E22 F95 970	INSTALLATION PLATE	1	1	1	1	1	1	1	1	1	1	1	1		
⑪	—	SOFT DRY CLOTH		1			1			1			1			MAC-1001CL-E

## 1-2. ACCESSORY AND REMOTE CONTROLLER

1. The part quantity below indicates the required number of pieces per unit.

No.	Part No.	Part name	MSZ-EF09NAW-U1	MSZ-EF09NAB-U1	MSZ-EF09NAS-U1	MSZ-EF12NAW-U1	MSZ-EF12NAB-U1	MSZ-EF12NAS-U1	MSZ-EF15NAW-U1	MSZ-EF15NAB-U1	MSZ-EF15NAS-U1	MSZ-EF18NAW-U1	MSZ-EF18NAB-U1	MSZ-EF18NAS-U1	Symbol in Wiring Diagram	Remarks
12	E22 T21 426	REMOTE CONTROLLER	1	1	1	1	1	1	1	1	1	1	1	1		SG15F
13	E22 F28 083	REMOTE CONTROLLER HOLDER	1	1	1	1	1	1	1	1	1	1	1	1		

<b>MSZ-EF09NAW - U1</b>	<b>MSZ-EF12NAW - U1</b>	<b>MSZ-EF15NAW - U1</b>	<b>MSZ-EF18NAW - U1</b>
<b>MSZ-EF09NAB - U1</b>	<b>MSZ-EF12NAB - U1</b>	<b>MSZ-EF15NAB - U1</b>	<b>MSZ-EF18NAB - U1</b>
<b>MSZ-EF09NAS - U1</b>	<b>MSZ-EF12NAS - U1</b>	<b>MSZ-EF15NAS - U1</b>	<b>MSZ-EF18NAS - U1</b>

### 1-3. INDOOR UNIT ELECTRICAL PARTS AND FUNCTIONAL PARTS

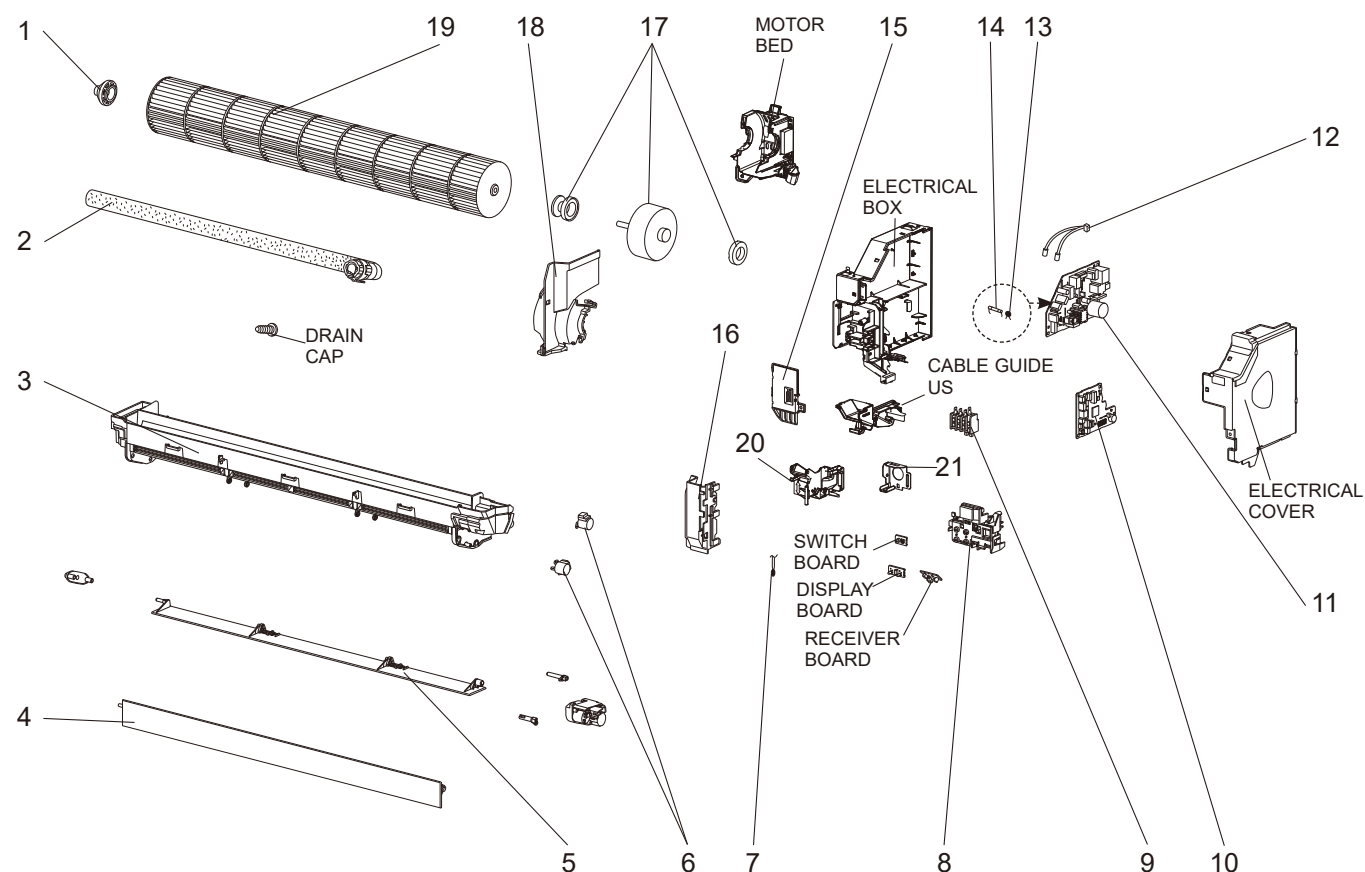

### 1-3. INDOOR UNIT ELECTRICAL PARTS AND FUNCTIONAL PARTS

1. The part quantity below indicates the required number of pieces per unit.

No.	Part No.	Part name	MSZ-EF09NAW-U1	MSZ-EF09NAB-U1	MSZ-EF09NAS-U1	MSZ-EF12NAW-U1	MSZ-EF12NAB-U1	MSZ-EF12NAS-U1	MSZ-EF15NAW-U1	MSZ-EF15NAB-U1	MSZ-EF15NAS-U1	MSZ-EF18NAW-U1	MSZ-EF18NAB-U1	MSZ-EF18NAS-U1	Symbol in Wiring Diagram	Remarks
1	E22 A89 509	BEARING MOUNT ASSEMBLY	1	1	1	1	1	1	1	1	1	1	1	1		Includes SLEEVE BEARING
2	E22 P72 702	DRAIN HOSE	1	1	1	1	1	1	1	1	1	1	1	1		
3	E22 T21 235	NOZZLE ASSEMBLY	1			1			1			1				
3	E22 T25 235	NOZZLE ASSEMBLY		1			1			1			1			
3	E22 T29 235	NOZZLE ASSEMBLY			1			1			1			1		
4	E22 F95 040	VANE UPPER	1			1			1			1				
4	E22 G21 040	VANE UPPER		1			1			1			1			
4	E22 G26 040	VANE UPPER			1			1			1			1		
5	E22 F95 041	VANE LOWER	1			1			1			1				
5	E22 G21 041	VANE LOWER		1			1			1			1			
5	E22 G26 041	VANE LOWER			1			1			1			1		
6	E22 A89 303	VANE MOTOR	2	2	2	2	2	2	2	2	2	2	2	2	MV	UP & DOWN, 1 PC/SET
7	E22 F95 308	ROOM TEMPERATURE THERMISTOR	1	1	1	1	1	1	1	1	1	1	1	1	RT11	
8	E22 F95 095	DISPLAY P.C. BOARD HOLDER	1	1	1	1	1	1	1	1	1	1	1	1		
9	E22 T21 375	TERMINAL BLOCK	1	1	1	1	1	1	1	1	1	1	1	1	TB	
10	E22 T21 452	ELECTRONIC CONTROL P.C. BOARD	1	1	1											Includes RECEIVER BOARD, DISPLAY BOARD and SWITCH BOARD.
10	E22 T22 452	ELECTRONIC CONTROL P.C. BOARD				1	1	1								
10	E22 T23 452	ELECTRONIC CONTROL P.C. BOARD							1	1	1					
10	E22 T24 452	ELECTRONIC CONTROL P.C. BOARD										1	1	1		
11	E22 T21 440	POWER P.C. BOARD	1	1	1	1	1	1	1	1	1	1	1	1		
12	E22 F95 307	INDOOR COIL THERMISTOR	1	1	1	1	1	1	1	1	1	1	1	1	RT12, RT13	
13	E22 B75 385	VARISTOR	1	1	1	1	1	1	1	1	1	1	1	1	NR11	
14	E22 A49 382	FUSE	1	1	1	1	1	1	1	1	1	1	1	1	F11	T3.15AL250V
15	E22 L85 784	V.A. CLAMP	1	1	1	1	1	1	1	1	1	1	1	1		
16	E22 F95 541	WATER CUT	1	1	1	1	1	1	1	1	1	1	1	1		
17	E22 J44 300	INDOOR FAN MOTOR	1	1	1	1	1	1	1	1	1	1	1	1	MF	RC0J30-□□, Includes FAN MOTOR RUBBER MOUNT (2 PCS/SET)
18	E22 F95 333	MOTOR BAND	1	1	1	1	1	1	1	1	1	1	1	1		
19	E22 F95 302	LINE FLOW FAN	1	1	1	1	1	1	1	1	1	1	1	1		
20	E22 T21 979	CONDUIT COVER	1	1	1	1	1	1	1	1	1	1	1	1		
21	E22 T21 978	CONDUIT PLATE	1	1	1	1	1	1	1	1	1	1	1	1		





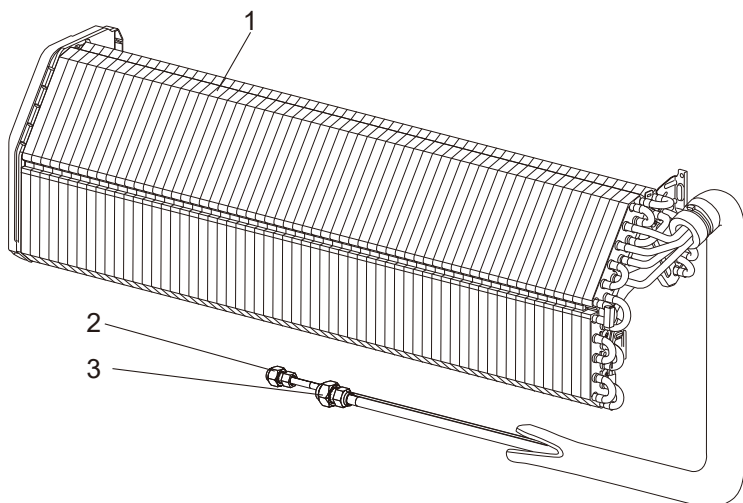







<b>MSZ-EF09NAW</b> - <b>U1</b>	<b>MSZ-EF12NAW</b> - <b>U1</b>	<b>MSZ-EF15NAW</b> - <b>U1</b>	<b>MSZ-EF18NAW</b> - <b>U1</b>
<b>MSZ-EF09NAB</b> - <b>U1</b>	<b>MSZ-EF12NAB</b> - <b>U1</b>	<b>MSZ-EF15NAB</b> - <b>U1</b>	<b>MSZ-EF18NAB</b> - <b>U1</b>
<b>MSZ-EF09NAS</b> - <b>U1</b>	<b>MSZ-EF12NAS</b> - <b>U1</b>	<b>MSZ-EF15NAS</b> - <b>U1</b>	<b>MSZ-EF18NAS</b> - <b>U1</b>

#### 1-4. INDOOR UNIT HEAT EXCHANGER



## 1-4. INDOOR UNIT HEAT EXCHANGER

1. The part quantity below indicates the required number of pieces per unit.

No.	Part No.	Part name	MSZ-EF09NAW- 	MSZ-EF09NAB- 	MSZ-EF09NAS- 	MSZ-EF12NAW- 	MSZ-EF12NAB- 	MSZ-EF12NAS- 	MSZ-EF15NAW- 	MSZ-EF15NAB- 	MSZ-EF15NAS- 	MSZ-EF18NAW- 	MSZ-EF18NAB- 	MSZ-EF18NAS- 	Symbol in Wiring Diagram	Remarks
1	E22 16E 620	INDOOR HEAT EXCHANGER	1	1	1	1	1	1								
1	E22 22E 620	INDOOR HEAT EXCHANGER							1	1	1	1	1	1		
2	E22 151 667	UNION (LIQUID)	1	1	1	1	1	1	1	1	1	1	1	1		ø1/4 (ø6.35)
3	E22 815 666	UNION (GAS)	1	1	1	1	1	1								ø3/8 (ø9.52)
	E22 155 666	UNION (GAS)							1	1	1	1	1	1		ø1/2 (ø12.7)

<b>MSZ-EF09NAW</b> - U2	<b>MSZ-EF12NAW</b> - U2	<b>MSZ-EF15NAW</b> - U2	<b>MSZ-EF18NAW</b> - U2
<b>MSZ-EF09NAB</b> - U2	<b>MSZ-EF12NAB</b> - U2	<b>MSZ-EF15NAB</b> - U2	<b>MSZ-EF18NAB</b> - U2
<b>MSZ-EF09NAS</b> - U2	<b>MSZ-EF12NAS</b> - U2	<b>MSZ-EF15NAS</b> - U2	<b>MSZ-EF18NAS</b> - U2

## 1-5. INDOOR UNIT STRUCTURAL PARTS

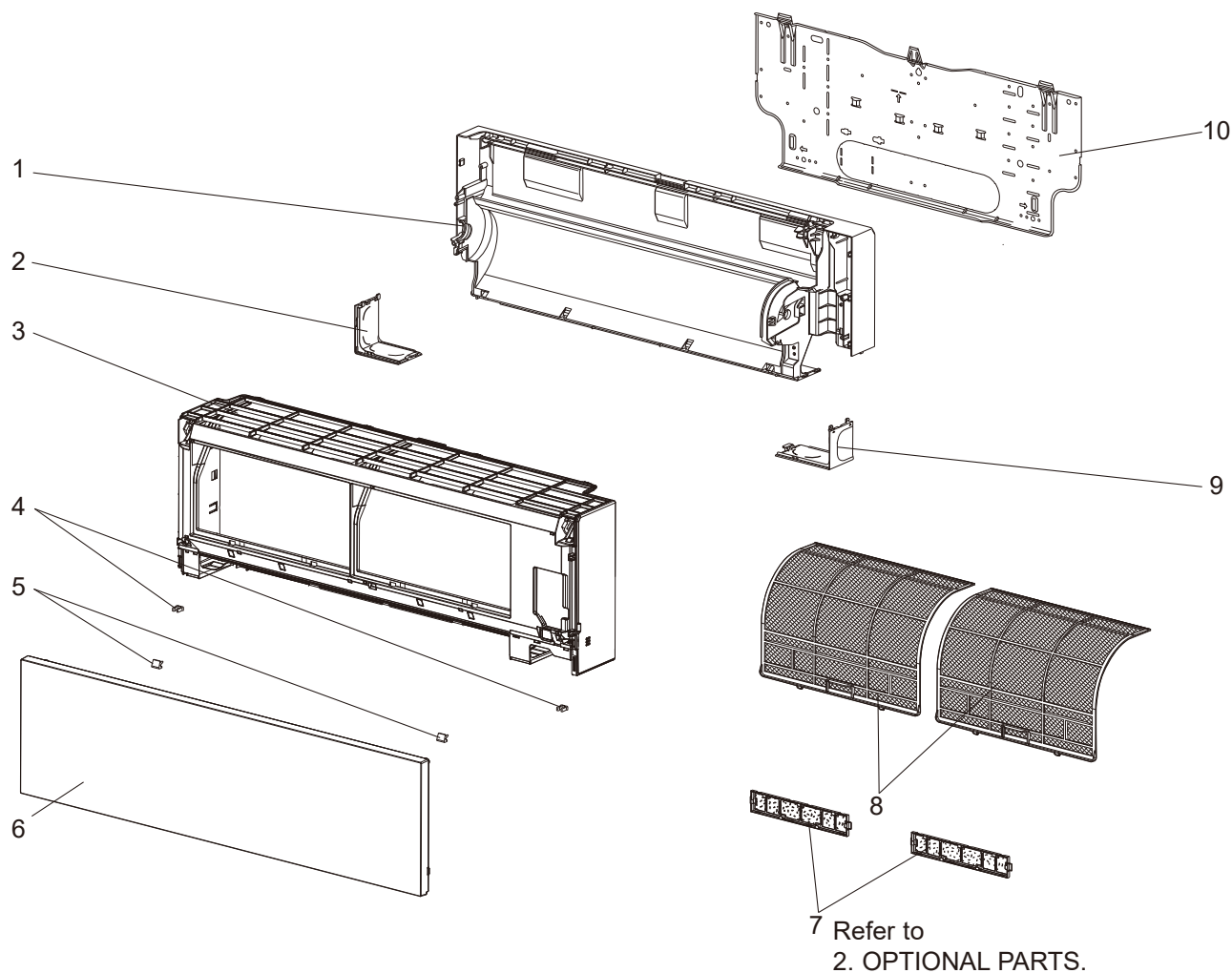

## 1-6. ACCESSORY AND REMOTE CONTROLLER

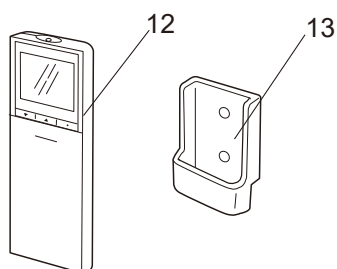



## 1-5. INDOOR UNIT STRUCTURAL PARTS

1. The part quantity below indicates the required number of pieces per unit.
2. The circled No. indicates that the part is not shown in the figure.

No.	Part No.	Part name	MSZ-EF09NAW-U2	MSZ-EF09NAB-U2	MSZ-EF09NAS-U2	MSZ-EF12NAW-U2	MSZ-EF12NAB-U2	MSZ-EF12NAS-U2	MSZ-EF15NAW-U2	MSZ-EF15NAB-U2	MSZ-EF15NAS-U2	MSZ-EF18NAW-U2	MSZ-EF18NAB-U2	MSZ-EF18NAS-U2	Symbol in Wiring Diagram	Remarks
1	E22 F95 234	BOX ASSEMBLY	1			1			1			1				
1	E22 G21 234	BOX ASSEMBLY		1			1			1			1			
1	E22 G26 234	BOX ASSEMBLY			1			1			1			1		
2	E22 T21 976	CORNER BOX LEFT	1			1			1			1				
2	E22 T25 976	CORNER BOX LEFT		1			1			1			1			
2	E22 T29 976	CORNER BOX LEFT			1			1			1			1		
3	E22 T21 000	PANEL ASSEMBLY	1			1			1			1				Includes No. 4, 5 and 6
3	E22 T25 000	PANEL ASSEMBLY		1			1			1			1			Includes No. 4, 5 and 6
3	E22 T29 000	PANEL ASSEMBLY			1			1			1			1		Includes No. 4, 5 and 6
4	E22 F95 142	CATCH	2	2	2	2	2	2	2	2	2	2	2	2		2 PCS/SET
5	E22 F95 067	SCREW CAP	2			2			2			2				2 PCS/SET
5	E22 G21 067	SCREW CAP		2			2			2			2			2 PCS/SET
5	E22 G26 067	SCREW CAP			2			2			2			2		2 PCS/SET
6	E22 T21 010	FRONT PANEL	1			1			1			1				
6	E22 T25 010	FRONT PANEL		1			1			1			1			
6	E22 T29 010	FRONT PANEL			1			1			1			1		
7	—	AIR CLEANING FILTER	2	2	2	2	2	2	2	2	2	2	2	2		1 PC/SET
8	E22 F95 100	NANO PLATINUM FILTER	2	2	2	2	2	2	2	2	2	2	2	2		1 PC/SET
9	E22 T21 975	CORNER BOX RIGHT	1			1			1			1				
9	E22 T25 975	CORNER BOX RIGHT		1			1			1			1			
9	E22 T29 975	CORNER BOX RIGHT			1			1			1			1		
10	E22 F95 970	INSTALLATION PLATE	1	1	1	1	1	1	1	1	1	1	1	1		
⑪	—	SOFT DRY CLOTH		1			1			1			1			MAC-1001CL-E

## 1-6. ACCESSORY AND REMOTE CONTROLLER

1. The part quantity below indicates the required number of pieces per unit.

No.	Part No.	Part name	MSZ-EF09NAW-U2	MSZ-EF09NAB-U2	MSZ-EF09NAS-U2	MSZ-EF12NAW-U2	MSZ-EF12NAB-U2	MSZ-EF12NAS-U2	MSZ-EF15NAW-U2	MSZ-EF15NAB-U2	MSZ-EF15NAS-U2	MSZ-EF18NAW-U2	MSZ-EF18NAB-U2	MSZ-EF18NAS-U2	Symbol in Wiring Diagram	Remarks
12	E22 T21 426	REMOTE CONTROLLER	1	1	1	1	1	1	1	1	1	1	1	1		SG15F
13	E22 F28 083	REMOTE CONTROLLER HOLDER	1	1	1	1	1	1	1	1	1	1	1	1		

MSZ-EF09NAW - U2 MSZ-EF12NAW - U2 MSZ-EF15NAW - U2 MSZ-EF18NAW - U2  
 MSZ-EF09NAB - U2 MSZ-EF12NAB - U2 MSZ-EF15NAB - U2 MSZ-EF18NAB - U2  
 MSZ-EF09NAS - U2 MSZ-EF12NAS - U2 MSZ-EF15NAS - U2 MSZ-EF18NAS - U2

## 1-7. INDOOR UNIT ELECTRICAL PARTS AND FUNCTIONAL PARTS

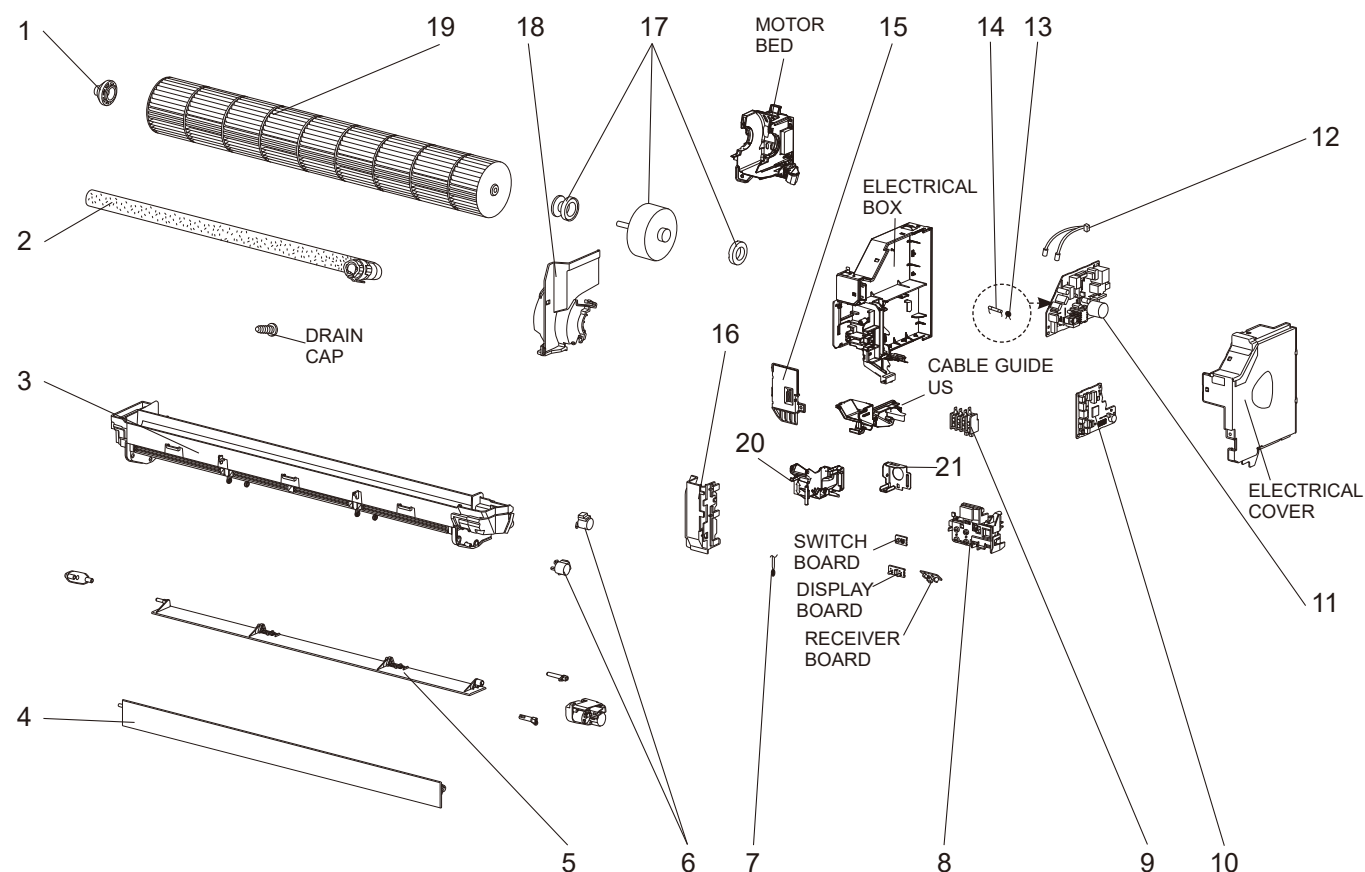

## 1-7. INDOOR UNIT ELECTRICAL PARTS AND FUNCTIONAL PARTS

1. The part quantity below indicates the required number of pieces per unit.

No.	Part No.	Part name	MSZ-EF09NAW-U2	MSZ-EF09NAB-U2	MSZ-EF09NAS-U2	MSZ-EF12NAW-U2	MSZ-EF12NAB-U2	MSZ-EF12NAS-U2	MSZ-EF15NAW-U2	MSZ-EF15NAB-U2	MSZ-EF15NAS-U2	MSZ-EF18NAW-U2	MSZ-EF18NAB-U2	MSZ-EF18NAS-U2	Symbol in Wiring Diagram	Remarks
1	E22 A89 509	BEARING MOUNT ASSEMBLY	1	1	1	1	1	1	1	1	1	1	1	1		Includes SLEEVE BEARING
2	E22 P72 702	DRAIN HOSE	1	1	1	1	1	1	1	1	1	1	1	1		
3	E22 T21 235	NOZZLE ASSEMBLY	1			1			1			1				
3	E22 T25 235	NOZZLE ASSEMBLY		1			1			1			1			
3	E22 T29 235	NOZZLE ASSEMBLY			1			1			1			1		
4	E22 F95 040	VANE UPPER	1			1			1			1				
4	E22 G21 040	VANE UPPER		1			1			1			1			
4	E22 G26 040	VANE UPPER			1			1			1			1		
5	E22 F95 041	VANE LOWER	1			1			1			1				
5	E22 G21 041	VANE LOWER		1			1			1			1			
5	E22 G26 041	VANE LOWER			1			1			1			1		
6	E22 A89 303	VANE MOTOR	2	2	2	2	2	2	2	2	2	2	2	2	MV	UP & DOWN, 1 PC/SET
7	E22 F95 308	ROOM TEMPERATURE THERMISTOR	1	1	1	1	1	1	1	1	1	1	1	1	RT11	
8	E22 F95 095	DISPLAY P.C. BOARD HOLDER	1	1	1	1	1	1	1	1	1	1	1	1		
9	E22 T21 375	TERMINAL BLOCK	1	1	1	1	1	1	1	1	1	1	1	1	TB	
10	E22 T21 452	ELECTRONIC CONTROL P.C. BOARD	1	1	1											Includes RECEIVER BOARD, DISPLAY BOARD and SWITCH BOARD.
10	E22 T22 452	ELECTRONIC CONTROL P.C. BOARD				1	1	1								
10	E22 T23 452	ELECTRONIC CONTROL P.C. BOARD							1	1	1					
10	E22 T24 452	ELECTRONIC CONTROL P.C. BOARD										1	1	1		
11	E22 T21 440	POWER P.C. BOARD	1	1	1	1	1	1	1	1	1	1	1	1		
12	E22 F95 307	INDOOR COIL THERMISTOR	1	1	1	1	1	1	1	1	1	1	1	1	RT12, RT13	
13	E22 B75 385	VARISTOR	1	1	1	1	1	1	1	1	1	1	1	1	NR11	
14	E22 A49 382	FUSE	1	1	1	1	1	1	1	1	1	1	1	1	F11	T3.15AL250V
15	E22 L85 784	V.A. CLAMP	1	1	1	1	1	1	1	1	1	1	1	1		
16	E22 F95 541	WATER CUT	1	1	1	1	1	1	1	1	1	1	1	1		
17	E22 J44 300	INDOOR FAN MOTOR	1	1	1	1	1	1	1	1	1	1	1	1	MF	RC0J30-□□, Includes FAN MOTOR RUBBER MOUNT (2 PCS/SET)
18	E22 F95 333	MOTOR BAND	1	1	1	1	1	1	1	1	1	1	1	1		
19	E22 F95 302	LINE FLOW FAN	1	1	1	1	1	1	1	1	1	1	1	1		
20	E22 T21 979	CONDUIT COVER	1	1	1	1	1	1	1	1	1	1	1	1		
21	E22 T21 978	CONDUIT PLATE	1	1	1	1	1	1	1	1	1	1	1	1		

MSZ-EF09NAW - U2 MSZ-EF12NAW - U2 MSZ-EF15NAW - U2 MSZ-EF18NAW - U2  
MSZ-EF09NAB - U2 MSZ-EF12NAB - U2 MSZ-EF15NAB - U2 MSZ-EF18NAB - U2  
MSZ-EF09NAS - U2 MSZ-EF12NAS - U2 MSZ-EF15NAS - U2 MSZ-EF18NAS - U2

## 1-8. INDOOR UNIT HEAT EXCHANGER

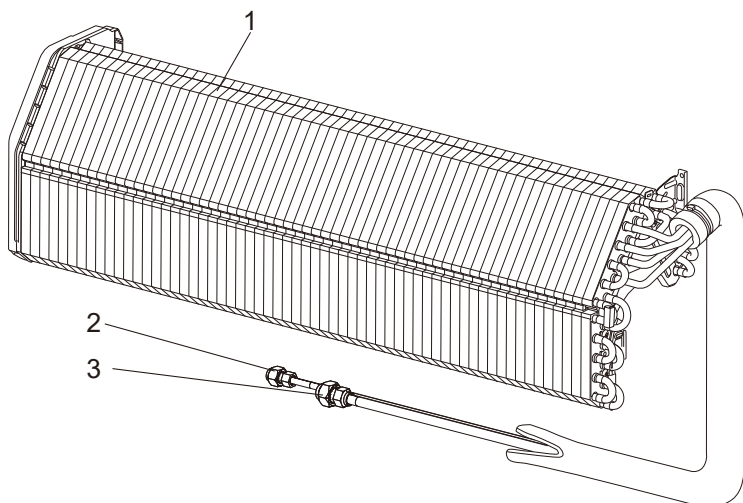

## 1-8. INDOOR UNIT HEAT EXCHANGER

1. The part quantity below indicates the required number of pieces per unit.

No.	Part No.	Part name	MSZ-EF09NAW-U2	MSZ-EF09NAB-U2	MSZ-EF09NAS-U2	MSZ-EF12NAW-U2	MSZ-EF12NAB-U2	MSZ-EF12NAS-U2	MSZ-EF15NAW-U2	MSZ-EF15NAB-U2	MSZ-EF15NAS-U2	MSZ-EF18NAW-U2	MSZ-EF18NAB-U2	MSZ-EF18NAS-U2	Symbol in Wiring Diagram	Remarks
1	E22 16E 620	INDOOR HEAT EXCHANGER	1	1	1	1	1	1								
1	E22 22E 620	INDOOR HEAT EXCHANGER							1	1	1	1	1	1		
2	E22 151 667	UNION (LIQUID)	1	1	1	1	1	1	1	1	1	1	1	1		ø1/4 (ø6.35)
3	E22 815 666	UNION (GAS)	1	1	1	1	1	1								ø3/8 (ø9.52)
	E22 155 666	UNION (GAS)							1	1	1	1	1	1		ø1/2 (ø12.7)

## 2-1. AIR CLEANING FILTER

### Air cleaning filter replacement

Pull to remove from the air filter

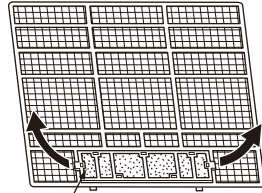

#### Air cleaning filter

- Electrostatic anti-allergy enzyme filter (Blue)
- Deodorizing filter (Black)

### ELECTROSTATIC ANTI-ALLERGY ENZYME FILTER (BLUE)

#### Every 3 months:

- Remove dirt by a vacuum cleaner.

#### When dirt cannot be removed by vacuum cleaning:

- Soak the filter and its frame in lukewarm water before rinsing it.
- After washing, dry it well in shade. Install all tabs of the air filter.

#### Every year:

- Replace it with a new air cleaning filter for best performance.

**NOTE 1:** Clean the filters regularly for best performance and to reduce power consumption.

**NOTE 2:** Dirty filters cause condensation in the air conditioner which will contribute to the growth of fungi such as mold. It is therefore recommended to clean air filters every 2 weeks.

Model				Part No.
MSZ-EF09NAW	MSZ-EF12NAW	MSZ-EF15NAW	MSZ-EF18NAW	MAC-2320FT
MSZ-EF09NAB	MSZ-EF12NAB	MSZ-EF15NAB	MSZ-EF18NAB	
MSZ-EF09NAS	MSZ-EF12NAS	MSZ-EF15NAS	MSZ-EF18NAS	

## 2-2. SOFT DRY CLOTH

- Clean the panel with the soft dry cloth when it is dirty.

Model				Part No.
MSZ-EF09NAW	MSZ-EF12NAW	MSZ-EF15NAW	MSZ-EF18NAW	MAC-1001CL-E
MSZ-EF09NAS	MSZ-EF12NAS	MSZ-EF15NAS	MSZ-EF18NAS	

## MITSUBISHI ELECTRIC CORPORATION

HEAD OFFICE: TOKYO BUILDING, 2-7-3, MARUNOUCHI, CHIYODA-KU, TOKYO 100-8310, JAPAN

© Copyright 2015 MITSUBISHI ELECTRIC CORPORATION

Issued: Feb. 2021. No. OBB736 REVISED EDITION-C

Issued: Mar. 2018. No. OBB736 REVISED EDITION-B

Issued: Nov. 2015. No. OBB736 REVISED EDITION-A

Published: Oct. 2015. No. OBB736

Made in Japan

Specifications are subject to change without notice.